



CW MILL EQUIPMENT CO., INC.
P.O. Box 246 • Sabetha, Kansas 66534
(785) 284-3454 • FAX (785) 284-3601

DMK584-I8

2011 Dodge D-2500-3500

2012-2013 2500-3500 WO Automatic Trans.

2013 Without remote mounted P.S. reservoir

6.7 Cummins Diesel

W-AC

INSTALLATION NOTES

1. Drain radiator below upper radiator hose. Remove upper radiator hose. Remove fan and fan shroud. Remove belt. Remove return hose from power steering reservoir and let reservoir drain. Remove bolts from power steering pump through the holes in the pulley. Leaving pressure lines attached, set pump aside on passenger side of engine. Remove power steering pump brackets.
2. Install studs (2) in timing cover w/nuts (3). Install pump onto adapter plate (11) using bolts (12) and pump spacer (13). Install pump and adapter plate (11) onto bracket (1) using bolts (14), lockwashers (15) and flatwashers (16). When installing pump and adapter plate to main bracket, line the back of the plates flush with each other. This will give a good start to aligning the clutch with the O.E.M. drive. Install 5/8 hose (18) onto return hose using hose barb (20) and hose clamps (19). Power steering lines on steering gearbox may need moved for proper clearance to the pump.
3. Install pump and bracket assembly onto studs (2) using nuts (3). Check alignment on pump and adjust if necessary. NOTE: It may be easier to install hoses and power wire before power steering pump is reinstalled. Install power steering pump onto bracket using bolts (4) and LW's (5). Install new belt (17) according to the belt diagram. Install idler (7) in lowest hole location possible while tensioner is retracted fully using bolt (8) and bushing (6).
4. Install hose rest (9) onto cylinder head on driver side using flange head bolts (10). Cut 3/4" off radiator side of top radiator hose and reinstall. Connect new power steering return hose (18) to power steering reservoir using OEM hose clamp. Fill reservoir w/ATF Plus 4 transmission fluid. Reinstall fan and fan shroud. Fill radiator and overflow tank. Check for proper belt tracking and clearances.

DMK584-I8

2011 Dodge Truck 2500-3500

2012-2013 2500-3500 WO Automatic Trans.

2013 Without remote mounted P.S. reservoir

6.7 Cummins Diesel

W-AC

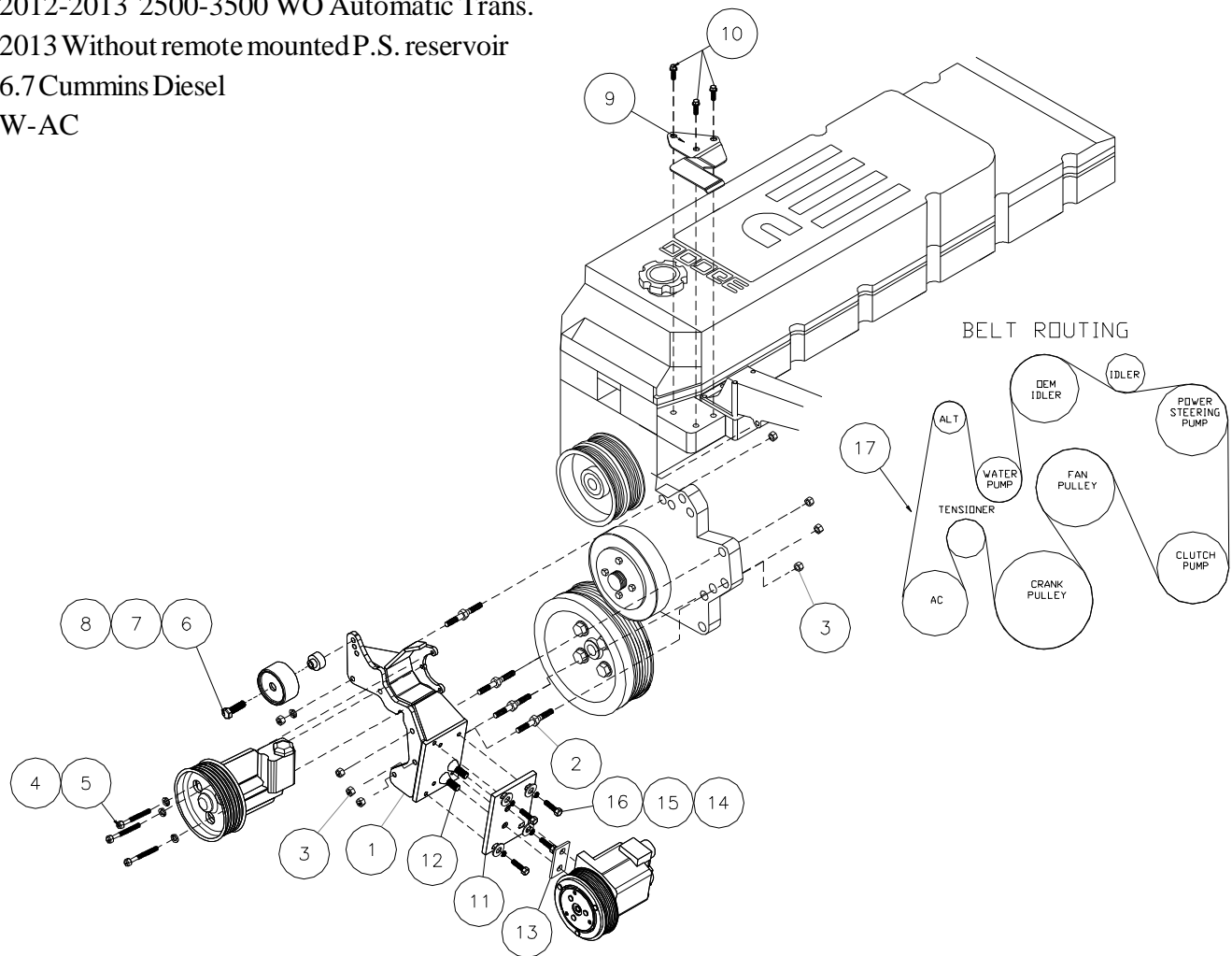

PARTS LIST

- | | |
|--------------------------------|-------------------------------------|
| 1. DMP582-I8 (1) | 12. 1/2 X 1 3/4 FHSCS (2) |
| 2. 8mm Stud 080751.25 ST (4) | 13. 1/4" Pump Tab (1) |
| 3. 8mm Flange Nut (8) | 14. 3/8 x 1 NC (4) |
| 4. 8mm x 80mm (3) | 15. 3/8 LW (4) |
| 5. 8mm LW (3) | 16. 3/8 FW (4) |
| 6. DMB562 (1) | 17. 5081300 Dayco (1) |
| 7. 89016 Dayco (1) | <u>ITEMS 18-22 NOT SHOWN</u> |
| 8. 10mm x 40mm Flange Bolt (1) | 18. 14" of 5/8" Oil Hose (1) |
| 9. DMB 563 (1) | 19. #10 Hose Clamp Dayco (2) |
| 10. 10mm x 20mm Flange (3) | 20. 5/8" Double Ended Hose Barb (1) |
| 11. DMP574 (1) | 21. 3/8 LW (2) |
| | 22. 15" Plastic Tie Strap (1) |