

## INSTALLATION NOTES

---

1. Disconnect negative battery cable. Remove driver's side radiator support brace. Remove the OEM belt. Remove the four bolts holding the fan to the fan pulley and let fan lay inside the fan shroud. Be careful not to damage the radiator. Install new drive pulley (1) with new clutch pump drive belt (11) draped over the top of drive pulley (1) using bolts (2) going through the fan, pump drive pulley (1), then OEM fan pulley. Tighten bolts to 45 ft.lbs.. Reinstall OEM belt.
2. Remove the radiator support bracket from the cylinder head and install the pump bracket (3) in its place using bolts (4). Do not tighten at this time. Install the clutch pump onto bracket (3) using bolts (7), nuts (8), flat washers (10) and lock washers (9). With the pump installed on the bracket, align the clutch parallel with the pulley (1) then tighten the main bracket bolts (4).
3. Install the tensioner (5) onto the bracket (3) using bolt (6). Install new pump drive belt (10). Install the radiator support brace with original bolts. Connect the battery cable. Run the engine and check for proper belt tracking and adjust if necessary.

NOTE: Check all wires and hoses that may have been disturbed during installation to make sure they are not up against any hot or moving parts.

# FLMK70A-8

2011-2016 FREIGHTLINER M2

CUMMINS ISB 6.7L

WO AIR OPERATED FAN CLUTCH

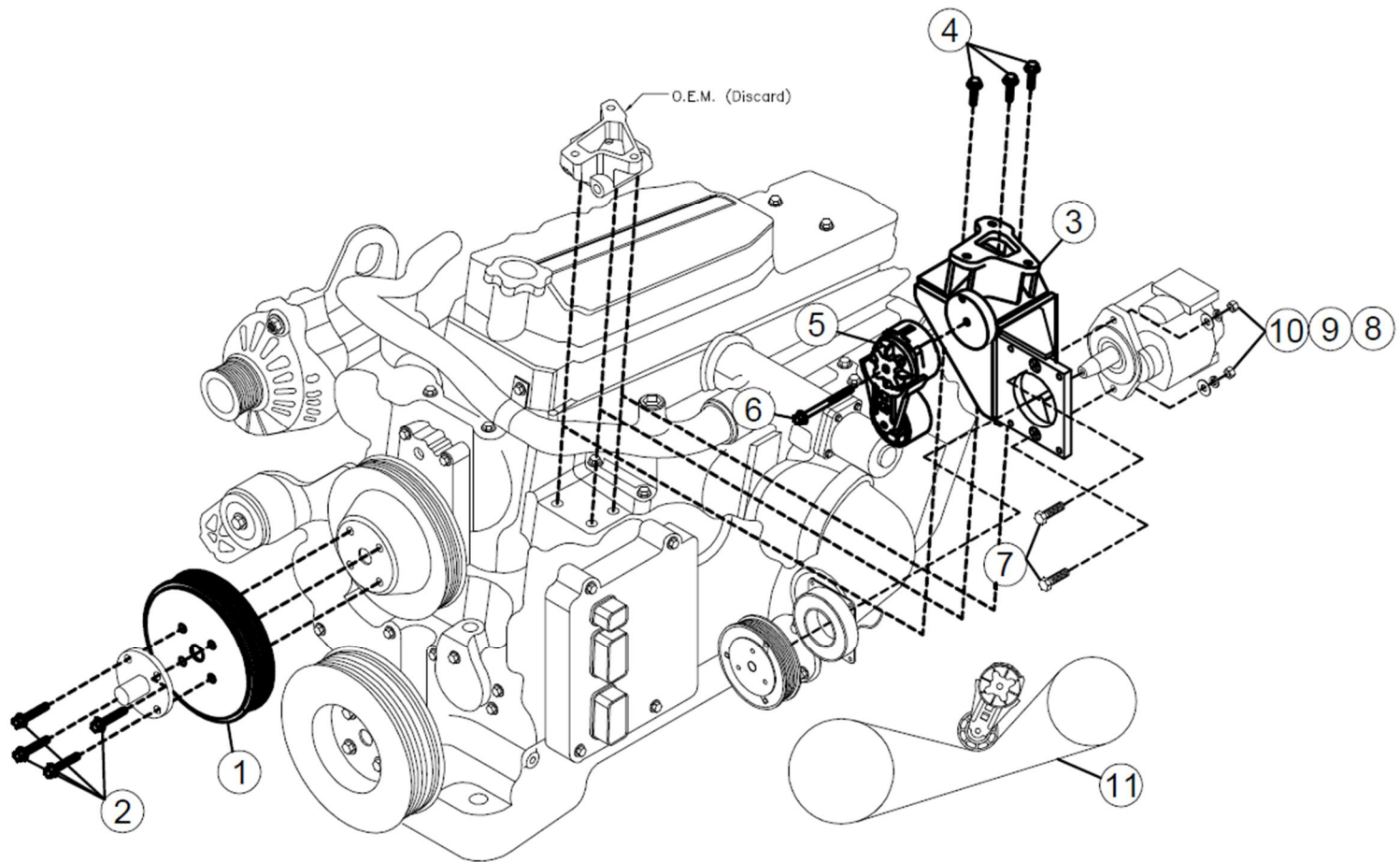

## PARTS LIST

- |                                |  |
|--------------------------------|--|
| 1. FLPC708 (1)                 | 7. 3/8 x 1-3/4 Bolt (2)                |
| 2. 10mm x 30mm Flange Bolt (4) | 8. 3/8 NC (2)                          |
| 3. FLMP70A-8 (1)               | 9. 3/8 LW (2)                          |
| 4. 10mm x 30mm Flange Bolt (5) | 10. 3/8 FW (2)                         |
| 5. 89200B (1)                  | 11. With 5.5" Clutch Dayco 5080445 (1) |
| 6. 10mm x 80mm MOD (1)         |  |

*Note: with 6" clutch belt used is Dayco 5080450*