



CW MILLEQUIPMENT CO., INC.  
P.O. Box 246 • Sabetha, Kansas 66534  
(785) 284-3454 • FAX (785) 284-3601

**FMK 67A -8 Belt**  
1999-2003 Ford Truck 250-550  
7.3 D.I.T. Intercooled Diesel  
W-W/O AC,WO/Dual alternator

**NOTE: MUST USE SIDE PORTED PUMP.**

## INSTALLATION NOTES

1. Disconnect the negative battery cables. Drain the engine coolant. Remove the jack tools, the upper radiator hose and the coolant over flow tank. Remove the fan shroud bolts and slide a piece of cardboard between the fan shroud and radiator to protect the radiator during assembly. Unscrew the fan nut and remove the fan and fan shroud from the engine compartment. (*Fan nut has right hand threads*).
2. Remove the OEM serpentine belt and tensioner. Remove the bottom two bolts from the tensioner bracket at locations "A & B" and the stud nut at location "C".
3. Install the drive pulley onto the engine damper with bolts (2) and lockwashers (3). Torque bolts to 45 ft./lbs.. Install the pump onto the bracket (5) with bolts (11), flatwashers (12), lockwashers (13) and nuts (14).
4. Install the pump and bracket assembly onto the engine with bolts (8) and lockwashers (3) at locations "A & B" and bolt (7) with lockwashers (6) at locations "C". Tighten bolts securely. Using bolt (15), lockwashers (6) and nut (16), attach the ground cable to the back, and the transmission cooler lines standoff to the front of the bushing located just below location "C".  
**NOTE:** The transmission coolant lines will need to be bent down to clear the bottom of the bracket.
5. Install the coil and clutch as per manufacturer's instructions.
6. Replace the OEM tensioner and install the OEM serpentine belt. Install the pump tensioner (9) with bolt (10). Install the pump drive belt. Install the fan spacer nut (4), fan and fan shroud. Replace the upper radiator hose, coolant overflow tank and jack tools. Replace the engine coolant. Connect the battery cables. Run the engine to make sure the belt tracks properly and clears all wires, hoses, etc..

**CAUTION:** Check compartment vacuum hoses and electrical wiring that may have been disturbed or re-routed during kit installation to be sure that hoses are not kinked, that they do not touch any high temperature item, and that they do not interfere with any linkage components.

# FMK 67A - 8 Belt

1999-2003 Ford Truck 250-550

7.3 D.I.T. Intercooled Diesel

W-W/O A/C

W/O Dual Alternator

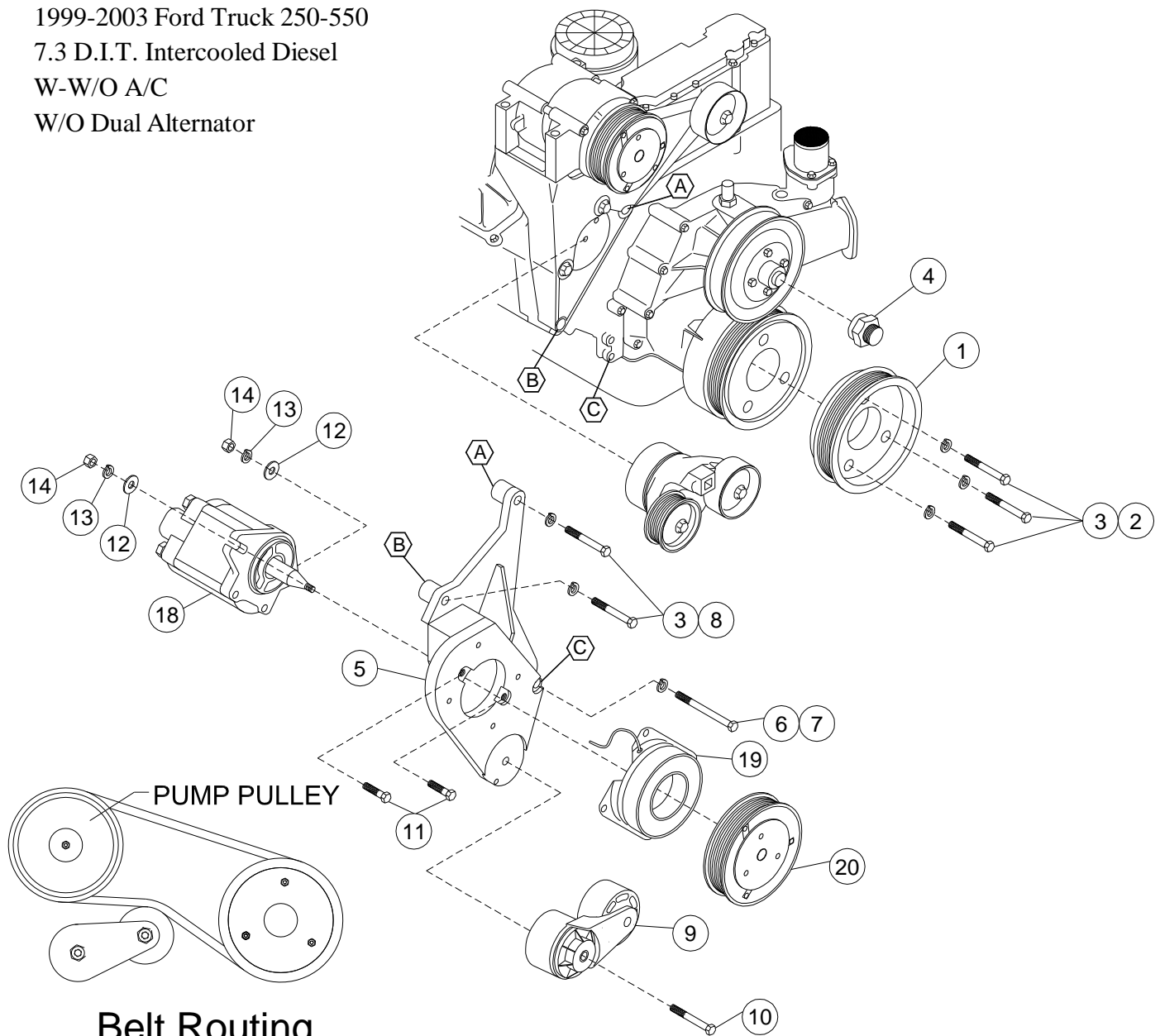

## Belt Routing

## PARTS LIST

- |                          |   |
|--------------------------|---|
| 1. FPC 65812 (1)         | 11. 3/8 x 1 1/2 NC (2)                      |
| 2. 10mm x 40mm 1.5 (3)   | 12. 3/8 FW (2)                              |
| 3. 10mm LW (5)           | 13. 3/8 LW (2)                              |
| 4. FSK 65 (1)            | 14. 3/8 NC Nut (2)                          |
| 5. FMB 67A (1)           | 15. 12mm x 45mm 1.75 (1) <i>(Not Shown)</i> |
| 6. 12mm LW (2)           | 16. 12mm Nut (1) <i>(Not Shown)</i>         |
| 7. 12mm x 160mm 1.75 (1) | 17. Belt 5080400 (1)                        |
| 8. 10mm x 90mm 1.5 (2)   | 18. Pump <i>(Sold Separately)</i>           |
| 9. Dayco 89200B (1)      | 19. Coil <i>(Sold Separately)</i>           |
| 10. 10mm x 80mm 1.5 (1)  | 20. Clutch <i>(Sold Separately)</i>         |

**Note:** This kit is designed for use with 5-1/2" Clutch only