



CW MILL EQUIPMENT CO., INC.
P.O. Box 246 • Sabetha, Kansas 66534
(785) 284-3454 • FAX (785) 284-3601

FMK 93-8

**2003-09 Ford Truck 650 & 750
CAT C7, W-W/O AC**

INSTALLATION NOTES

1. Disconnect the negative battery cable(s). Remove the charge air cooler tube at the turbo and cooler. Remove the eight bolts holding the damper onto the crankshaft. Remove the damper and lay it aside for later installation. Install drive pulley (1) onto the crank shaft temporarily with two (3) bolts in opposing holes to aid in properly aligning the clutch pump pulley.
2. Remove the four alternator bolts one at a time and replace them with studs (6) and nuts (7). Torque to 35-40 ft/lbs. Install spacers (5) onto each of the four alternator studs. Install the pump (20) onto the pump plate (4) with bolts provided in the kit. (DO NOT TIGHTEN). Install the pump and plate assembly onto the four alternator studs and secure with lockwashers (2) and nuts (7). Torque to 35-40 ft/lbs. Align the clutch pump pulley with the drive pulley, then tighten the pump bolts securely.
3. Remove bolts at locations "A" & "B" and install the 12mm studs (13). Install bushings (9) onto the studs. Install brace (8) with lockwashers (12) and nuts (14) at locations "A" & "B" and bolts (11), lockwashers (2) and flatwashers (10). Tighten all bolts securely.
4. Remove the two bolts from the drive pulley, and install the damper with bolts (3), (use appropriate length) and lockwashers (2). Torque bolts to 40-45 ft/lbs. Install tensioner (18) with bolts (19) onto brace (8). Install idler (26) with spacer (15), bolt (17), and flat washer (10) in location "C". Install idler (16) with spacer (15), bolt (17), and flat washer (10) in location "D". Install the pump drive belt (27). Install the new cooler tube assembly so it clears the clutch pump. Tighten clamps securely. Connect the battery cable. Check for proper clearances to any moving parts. Run the engine and check for proper tracking of the belt, adjust if necessary.

FMK 93-8

2003-09 Ford Truck 650 & 750

CAT C7, W-W/O AC

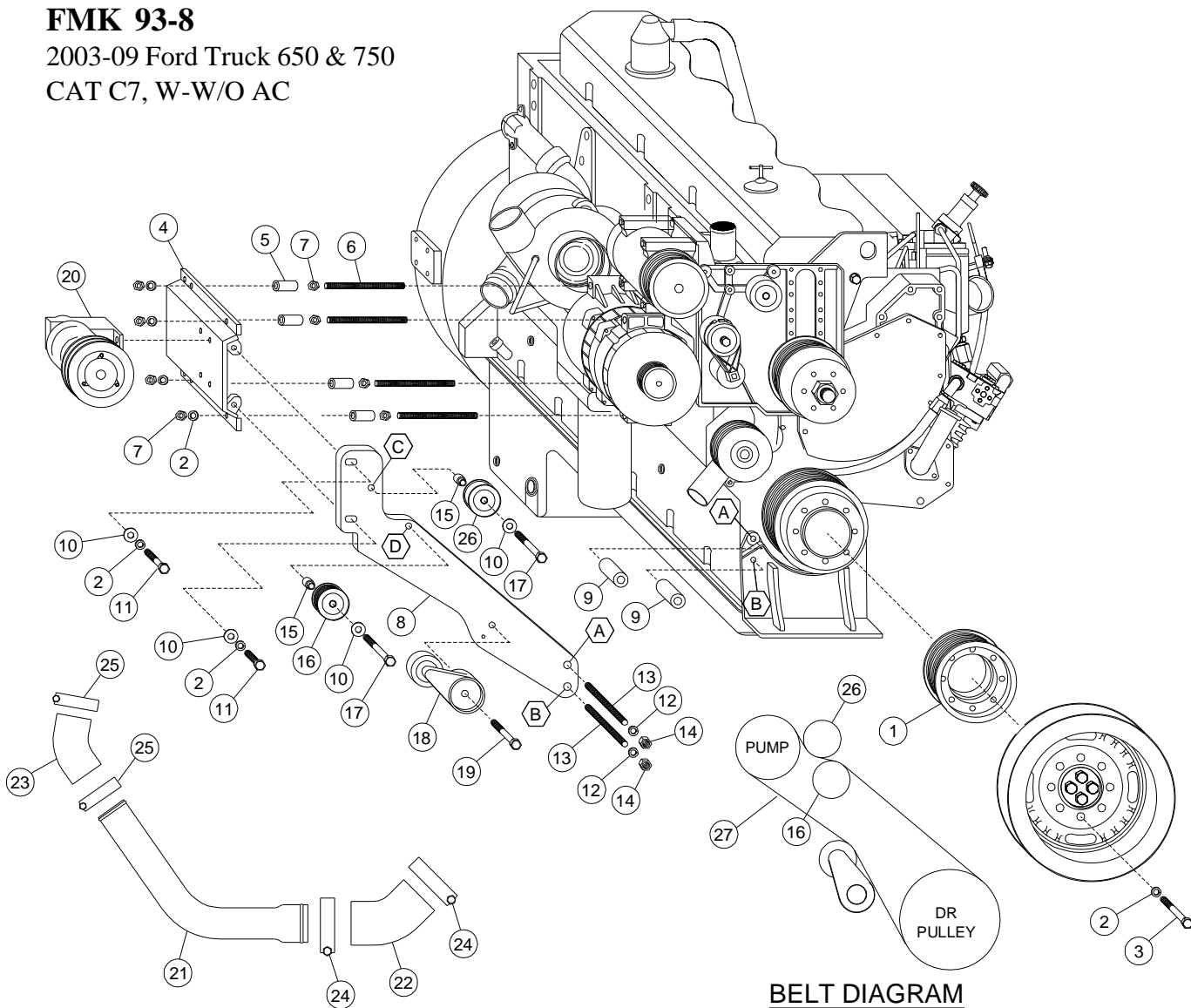

BELT DIAGRAM

PARTSLIST

- | | |
|--|---|
| <ul style="list-style-type: none"> 1. FPC 938 (1) 2. 10mm LW (14) 3. 10mm x 65mm (8)
(or 10mm x 90mm) (8) 4. FMP 93 (0-4) (1) 5. SP 100-1.340 (4) 6. 10mm x 180mm Stud (4) 7. 10mm Nut (8) 8. FMB 933 (1) 9. SP 100-1.660 (2) 10. 10mm FW (4) 11. 10mm x 25mm (2) 12. 12mm LW (2) 13. 12mm x 140mm Stud (2) 14. 12mm Nut (2) | <ul style="list-style-type: none"> 15. FMB 935 (2) 16. GPCS8 Grooved Idler (1) 17. 10mm x 35mm (2) 18. Tensioner 89231 TIPCS (1) 19. 10mm x 55mm (1) 20. Clutch Pump Assembly
(Sold Separately) 21. 3-55-ST 3" Steel Elbow (1) 22. 3 1/2" Rubber Elbow (1) 23. 3" Rubber Elbow (1) 24. 3 1/2" Clamp (2) 25. 3" Clamp (2) 26. Idler TIPCS 27. Belt: #1 -5080675, #2 -5080663,
#4 -5080655 |
|--|---|

Belt for 6" clutch: #1-5080680, #2-5080670, #4-5080663