



CW MILL EQUIPMENT CO., INC.
P.O. Box 246 • Sabetha, Kansas 66534
(785) 284-3454 • FAX (785) 284-3601

FMK 93A-I8
2003-09 Ford Truck 650 & 750
CAT C7 / 3126, W/AC

INSTALLATION NOTES

1. Disconnect negative battery cable. Remove innercooler tube and both rubber elbows. Remove the four alternator bolts one at a time and replace them with studs (3) and nuts (4). Torque to 35-40 ft/lbs. Install spacers (2) onto each of the four alternator studs. Install the pump (18) onto the pump plate (1) with bolts (15), lockwashers (16) and nuts (17). Install clutch and coil per manufacture instructions. Install the pump and plate assembly onto the four alternator studs and secure with lockwashers (5) and nuts (4). Torque to 35-40 ft/bs. Move O.E.M. idler from location "A" to location "B".
2. Install idler assembly (6, 7) onto bracket (1) in location "E", with bolt (9) and spacer (6). Install belt (19) as shown in belt diagram. Install new innercooler tube (10) with new elbows (11, 12) and clamps (13, 14). Reconnect battery cable.

FMK 93A-I8

2003-09 Ford Truck 650 & 750

CAT C7 / 3126, W/AC

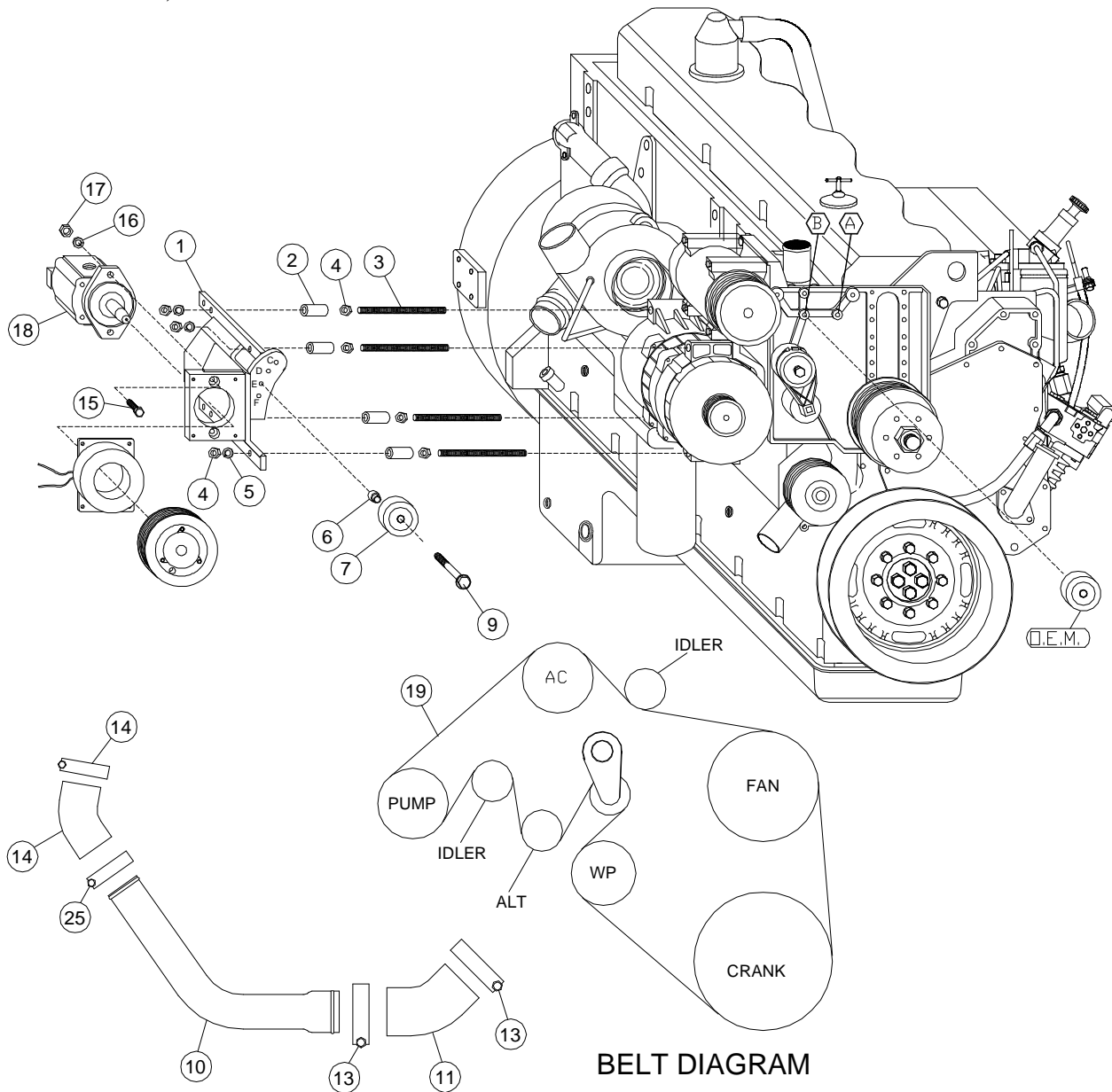

BELT DIAGRAM

PARTS LIST

- | | |
|--------------------------------|---|
| 1. FMP 93A (1) | 11. 3 1/2" Rubber Elbow (1) |
| 2. SP100-1.340 (4) | 12. 3" Rubber Elbow (1) |
| 3. 10mm x 180mm Stud (4) | 13. 250-92 Hose Clamp (2) |
| 4. 10mm Nut (8) | 14. 250-84 Hose Clamp (2) |
| 5. 10mm LW (4) | 15. 3/8 x 1 1/12 NC Bolt (2) |
| 6. FMB 935 (1) | 16. 3/8 LW (2) |
| 7. 89016 (1) | 17. 3/8 NC Nut (2) |
| 8. NOT USED | 15. Clutch Pump Assembly
(Sold Separately) |
| 9. 10mm x 40mm Flange Bolt (1) | 16. Dayco 5081000 (1) |
| 10. 3-55-ST 3" Steel Elbow (1) | |