



**CW MILL EQUIPMENT CO., INC.**  
P.O. Box 246 • Sabetha, Kansas 66534  
(785) 284-3454 • FAX (785) 284-3601

**IMK 63-8**  
2003-07 International  
4200 Series, VT 365 Diesel  
W-W/O AC, W/O Air Compressor

---

## **INSTALLATION NOTES**

---

1. Install drive pulley (1) onto harmonic balancer using bolts (2) and lockwashers (3). Torque bolts to 40 ft.lbs..
2. Install bracket (4) on the front of the driver side head at locations "A", "B", and "C" with bolts (5) and lockwashers (3). Torque bolts to 40 ft.lbs..
3. Install clutch pump onto the bracket with bolts provided in the kit. Align the pump pulley with the drive pulley and tighten bolts securely. Install tensioner (6) with bolt (7). Install belt (8) as shown in diagram.
4. Run engine and check for proper belt tracking and clearances.

# IMK 63-8

2003-07 International

4200 Series

VT 365 Diesel

W-W/O AC

W/O Air Compressor

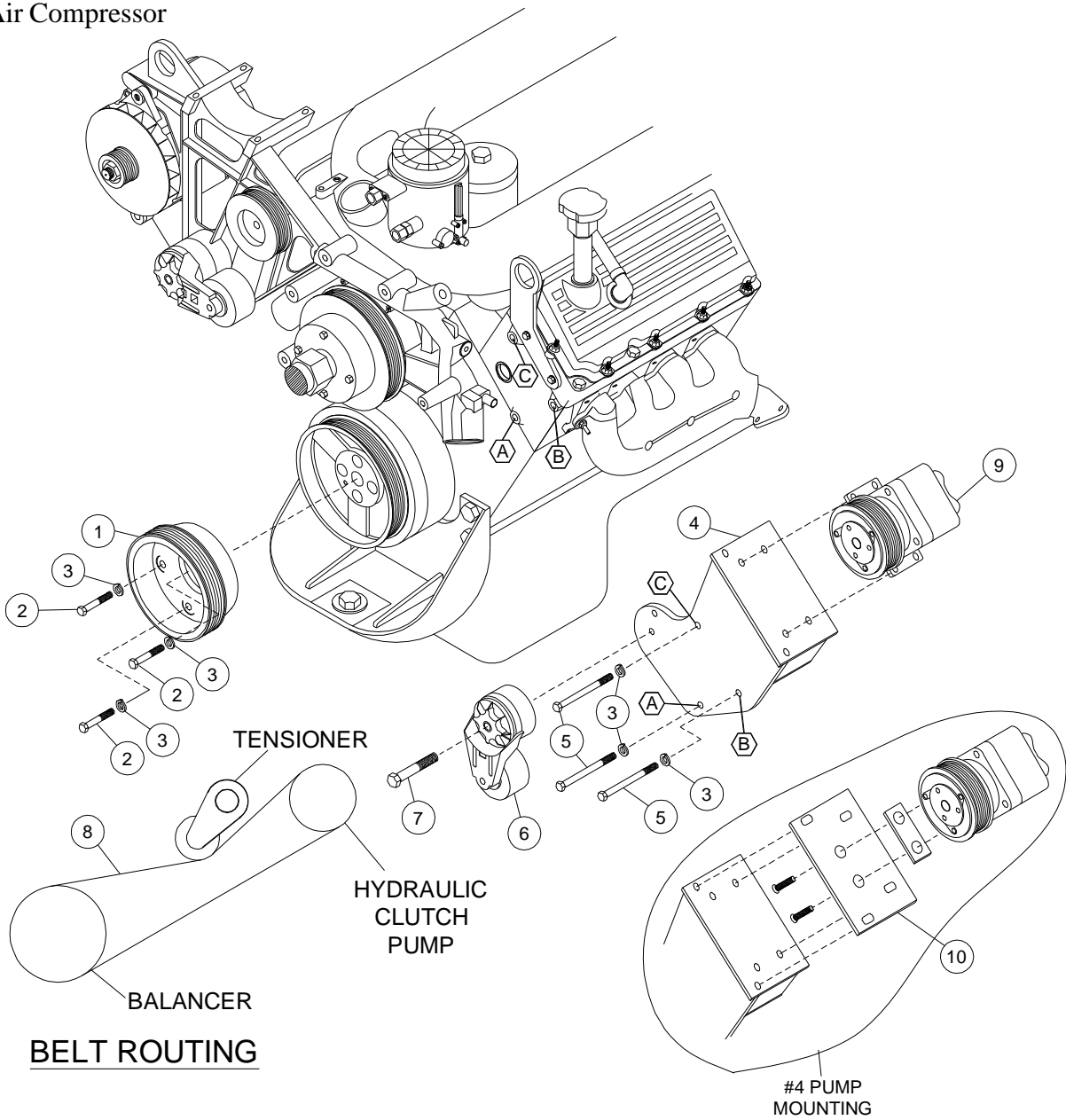

## PARTSLIST

- |                     |  |
|---------------------|--|
| 1. FPC 688 (1)      | 6. Tensioner 89200B (1)                |
| 2. 10mm x 30mm (3)  | 7. 10mm x 75mm (1)                     |
| 3. 10mm LW (6)      | 8. Belt; #2-5080630,<br>#4-5080625 (1) |
| 4. IMB 631 (1)      | 9. Clutch pump (Sold Separately)       |
| 5. 10mm x 150mm (3) | 10. IMP 634                            |

With 6" Clutch #2-5080640, #4-5080635

09/11