

INSTALLATION NOTES

1. Disconnect negative battery terminal. Remove the right-hand fender well, the top half of the fan shroud and the fan. (**Fan Nut Has Left-hand Threads**) Remove the O.E. belt, tensioner and the four bolts from the A/C compressor. Remove the fan pulley and the bolt at location (A).
2. Install bracket (4) under the A/C compressor using bolts (6) flat washers (7) and at location (A) with bolt (8). Run the bolts all the way in but do not tighten at this time. Install aux. A.C. mounting plate (3) under the other side of the A/C Compressor with bolts (6) and flat washers (7). Do not tighten. Install the O.E. tensioner with stud (11) shim (12) and nut (10). Torque nut (10) to 25 ft. lbs. Install bracket (5) with bolts (9) and nut (10). Tighten very lightly then torque bolts (6) and (8) to 35 ft. lbs.. Remove bracket (5) and install the fan pulley and the O.E. belt back to its original routing. Reinstall bracket (5) and torque bolts (9) and nut (10) to 35 ft. lbs.
3. Install pump drive pulley (1) onto the engine dampener with bolts (2) and torque to 25 ft. lbs. Install the aux. A.C. onto plate (3) with bolts (9,20), nuts (10) and slide bushings (21). Alignment is very critical to obtain proper belt life and performance, so use a good straight edge to check alignment of the aux. A.C.. If the aux. A.C. hits the A/C hose, the receiver dryer can be raised in its saddle and the A/C line can be bent to clear it. Install idlers (14) with bushings (13) flat washers (15) bolts (16) and tensioner (17) with bolt (18). Install the pump drive belt (22) and route is as shown in the illustration.
4. Install fan spacer nut (19) onto the fan hub and install the fan. Replace the fan shroud and install the fender well. Reconnect the batteries. Run the engine and check for proper belt tracking. Adjust if necessary.

CAUTION: Check all engine compartment hoses and electrical wiring that may have been disturbed or re-routed during kit installation to be sure that hoses are not kinked, that they do not touch any high temperature items, and that they do not interfere with any linkage components.

CMK 55SD508-8
2001-09 Chevy
C6500 & C7500 Truck
8.1L / V-8 Gas

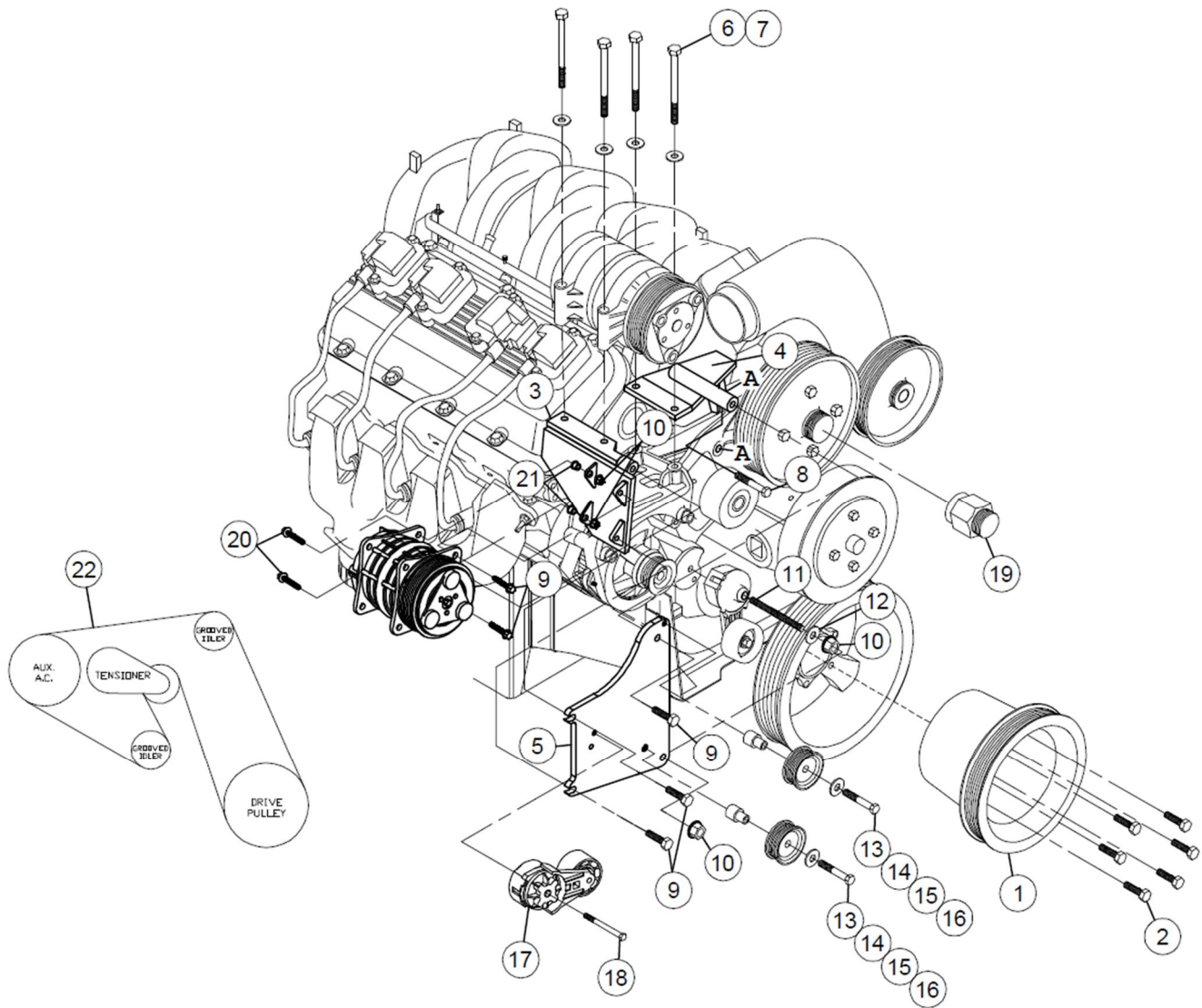

PARTS LIST

- | | |
|------------------------------------|---------------------------------|
| 1. CPC 558 (1) | 12. 10mm x .120 Shim (1) |
| 2. 8mm x 30mm 10.9 Flange (6) | 13. CMB 552 Bushing (2) |
| 3. CMP 55SD508-8 (1) | 14. GPCD8 Idlers (2) |
| 4. CMB 550 (1) | 15. 12mm FW (2) |
| 5. CMB 551 (1) | 16. 12mm x 65mm Bolt (2) |
| 6. 10mm x 120mm Bolts (4) | 17. 89426M (1) |
| 7. 10mm FW (4) | 18. 10mm x 80mm Flange Bolt (1) |
| 8. 10mm x 130mm Bolt (1) | 19. FSK 52 Fan Spacer (1) |
| 9. 10mm x 30mm 1.5 Flange Bolt (5) | 20. 10mm x 40mm Flange (2) |
| 10. 10mm Flange Nut 1.5 (4) | 21. 1255-0090 Slide Bushing (2) |
| 11. 10mm x 120mm Stud 1.5 (1) | 22. 5080890 Dayco (1) |