



CW MILL EQUIPMENT CO., INC.  
P.O. Box 246 • Sabetha, Kansas 66534  
(785) 284-3454 • FAX (785) 284-3601

**CMK 61 — 2 Belts**  
1982-85 1/2 CHEVY  
C&K-20, 30  
6.2 Diesel W-WO/AC  
(Non-Serpentine)

### INSTALLATION NOTES

1. Disconnect battery terminal.  
**IMPORTANT:** Mark fan flange to water pump pulley for proper re-installation. Remove fan and loosen belts.
2. Remove bolts and washers from pulley on front of crankshaft. Install drive pulley (1) with provided bolts (3) and washers (4). **CAUTION:** Be sure new bolts have the same threads as the O.E.M. bolts removed.
3. Remove alternator from original position. Remove support bracket from back of alternator. Cut off 5/8" from short end of support bracket as shown in diagram. Re-attach bracket. **NOTE:** If engine has brace from mounting hole (D) to ram air support, remove it.
4. Install mounting bracket (9) to engine using provided bolts (11 & 12). Do not tighten bolts. If studs are at locations "A & B", see note.
5. Install alternator using original bolts. Do not tighten bolts.
6. Remove fan studs and replace with provided studs (6). Install fan spacer (5) and fan. **NOTE:** Align marks from step 1. Tighten securely.
7. Tighten mounting bracket bolts. Install and tighten belts to specified tension. Check clearance between alternator fan and tab on bracket (9).
8. Mount clutch pump (27) to plate with pump bolts. Make sure clutch pulley is in line with drive pulley. Tighten pump bolts securely.
9. Install idler pulley (20) using spacers as required to align with clutch and drive pulleys. Tighten securely.
10. Install pump drive belts (26). Adjust plate (10) for proper belt tension. Tighten bolts (14 & 15) on pump plate.
11. Connect battery terminal.

**CAUTION:** Check all engine compartment vacuum hoses and electrical wiring that may have been disturbed or re-routed during kit installation to be sure hoses are not kinked, that they do not touch any high temperature item, and that they do not interfere with any linkage components.

**NOTE:** Heater hoses and ram air tube may need to be re-routed or the length may need to be changed.

**NOTE:** This kit is designed to operate successfully with the standard fan supplied by the manufacturer of your truck. Due to O.E.M. assembly tolerances and change, visually make certain that there is adequate clearance between fan and drive pulley as well as fan and radiator. It may be necessary to use a longer fan spacer for pulley clearance. If there is little clearance to the radiator, check with a Chevrolet dealership to insure that it will not flex into the radiator before operating. Move radiator if necessary. Fan shroud may need to be notched for belt clearance.

# CMK 61- 2 Belts

1982-85 1/2 CHEVY

6.2 DIESEL W-WO/AC

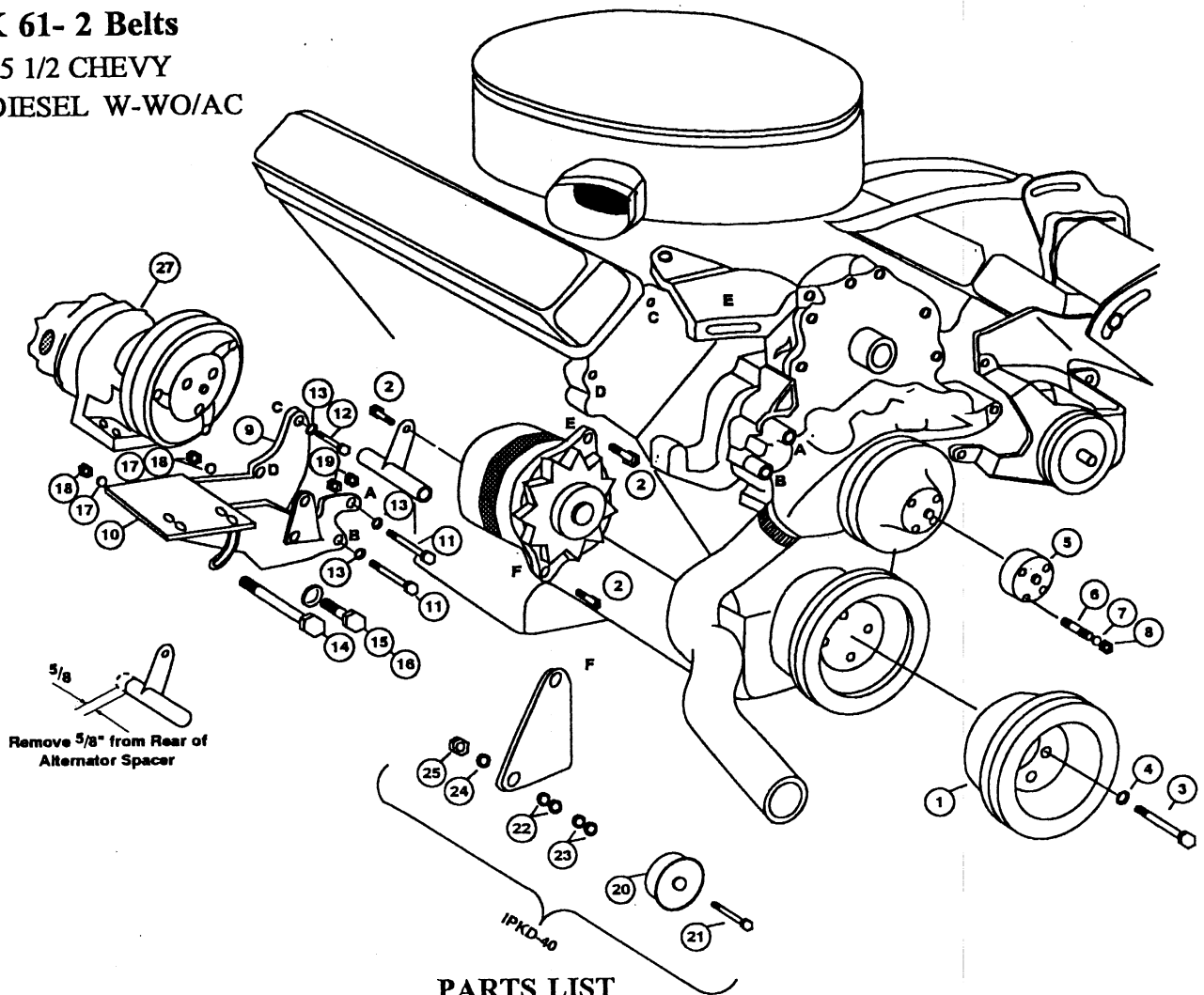

## PARTS LIST

- |                           |                              |
|---------------------------|------------------------------|
| 1. CPC 612 (1)            | 15. 3/8 X 1-1/2 NC (1)       |
| 2. O.E.M.                 | 16. 3/8 FW (1)               |
| 3. 10mm X 35mm 1.5 (4)    | 17. 3/8 LW (2)               |
| 4. 10mm LW (4)            | 18. 3/8 NC (2)               |
| 5. FSO 607 (1)            | 19. SP88-0.187 (2)           |
| 6. 8mm X 45mm 1.25 ST (4) | 20. IPCD (1)                 |
| 7. 8mm LW (4)             | 21. 5/8 X 4 NC (1)           |
| 8. 8mm 1.25 (4)           | 22. 5/8 FW (12)              |
| 9. CMB 610 (1)            | 23. IPW14 (5)                |
| 10. CMP 61 (0-4) (1)      | 24. 5/8 LW (1)               |
| 11. 10mm X 120mm 1.5 (2)  | 25. 5/8 NC (1)               |
| 12. 10mm X 30mm 1.5 (1)   | 26. 2A60 (1) (Not Shown)     |
| 13. 10mm LW (3)           | 27. Clutch Pump Assembly (1) |
| 14. 3/8 X 5-1/2 NC (1)    | (Sold Separately)            |

**NOTE:** If studs rather than bolts are used at locations "A & B", remove studs and use spacers (19) with bolts (11).

**NOTE:** Check alternator fan to tab for clearance at location "F".

**NOTE:** Tighten belts to eliminate excessive belt whip.