



CW MILL EQUIPMENT CO., INC.
P.O. Box 246 • Sabetha, Kansas 66534
(785) 284-3454 • FAX (785) 284-3601

TCMK 71 -I8-AC
2003-07 T-Series
6500-8500 Tilt Cab
W/AC W/WO Air Compressor

INSTALLATION NOTES

1. Disconnect negative battery cable(s). Remove the OEM serpentine belt. Remove any bolts or claps from the block at location “A”. Cut the front engine lifting lug off so it doesn’t interfere with bracket (1).
2. Install bracket (1) with bolts (2) and lockwashers (3) at location “A”, torque the bolts to 40 ft/lbs.. Install the pump onto the bracket with the bolts provided and align it with the OEM pulleys. Install the flat idler into the bottom hole in the bracket with bushing (4), flat washer (8) and bolt (7). Install the grooved idler onto the bracket at the other location with bushing (4), flatwasher (8) and bolt (7).
3. Install the new belt onto the engine according to the belt diagram. If the belt is too short, move the flat idler up to the next hole. Check all hoses, wires, etc. that may have been moved during installation to make sure they are not rubbing against any moving parts. Connect the battery and run the engine to check for proper belt tracking.

TCMK71 -I8-AC

2003-07 T-Series Chevy/GMC

6500-8500 Tilt Cab

W/AC W/NO Air Compressor

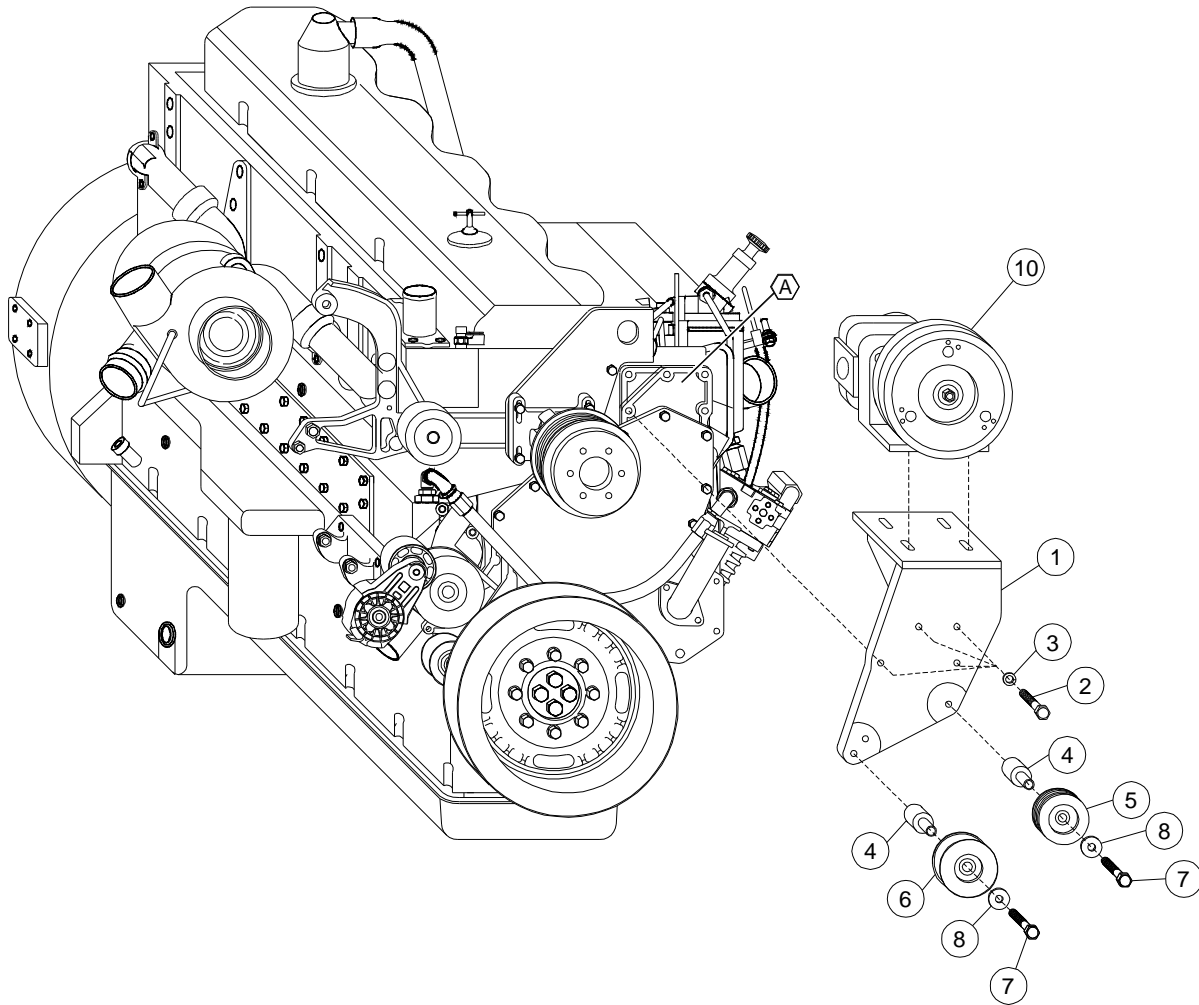

PARTS LIST

- 1. TCMP 71(0-4) (1)
- 2. 10mm x 55mm 10.9 (4)
- 3. 10mm LW (4)
- 4. FLMB 911 (2)
- (GPKDFL91 Assy includes items 4,5,7,8)
- 5. GPCD8 (1)
- (IPKDFL91) Assy includes items 4,6,7,8)
- 6. IPCD (1)
- 7. 12mm x 65mm (2)
- 8. 12mm LW (2)
- 9. Pump Belt (Not Shown) (1)
Dayco # 5071125
- 10. Clutch Pump Assembly
(Sold Separately)

