



CWMILL EQUIPMENT CO., INC.
P.O. Box 246 • Sabetha, Kansas 66534
(785) 284-3454 • FAX (785) 284-3601

DMK 53A -I8 Belt
1994-'98 Dodge D-250,350
5.9 Cummins Diesel
With A/C only,
With Intercooler

INSTALLATION NOTES

1. Disconnect the negative battery cables. Remove O.E.M. belt. Remove top alternator brace and discard. Remove bottom alternator bolt at location "B".
2. Install pump bracket (1) with bolts (2,5,8), lockwashers (3,6,9), and nuts (4,7,10) in locations "A", "B", "C". Install clutch pump (15) with bolts (16), flatwashers (17), lockwashers (9) and nuts (10). Install coil and clutch assembly per manufacturer's specifications. Align clutch with drive pulley and tighten pump bolts. Install idler (11) with bushing (12), bolt (13), and flatwasher (14) in location "D". If belt tension is not sufficient, other idler hole locations may be used. Install new belt (20) according to belt diagram. Reconnect battery cable.

DMK 53A -I8 Belt

1994-'98 Dodge, D-250, 350

5.9 Cummins Diesel

With A/C only,

With Intercooler

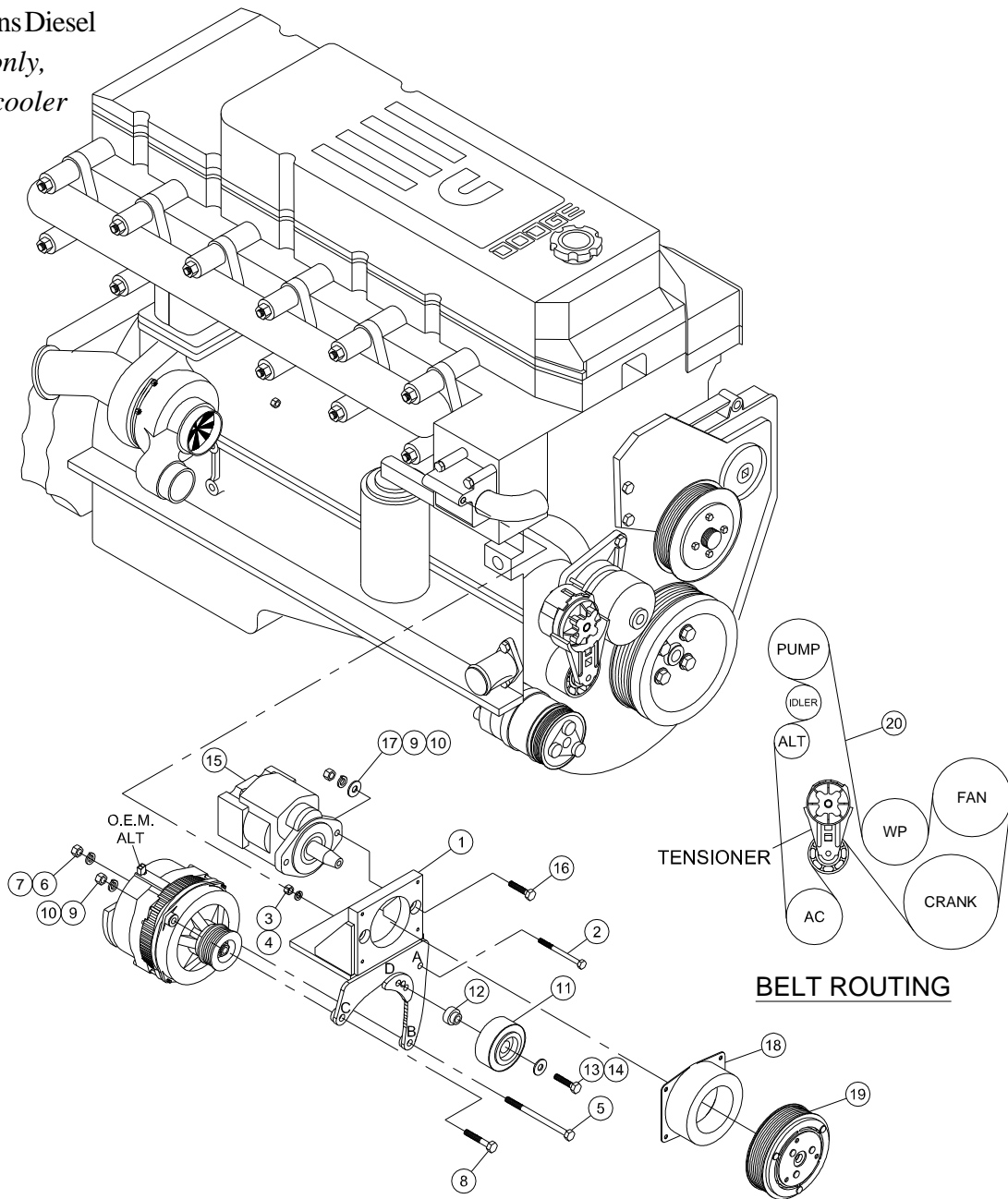

PARTS LIST

- | | |
|-----------------------------|--|
| 1. DMP 534-I8 (1) | 11. TIPCS Idler (1) |
| 2. 5/16-18 x 4-3/4 Bolt (1) | 12. CMB 3867 Bushing (1) |
| 3. 5/16 FW (1) | 13. 10mm x 35mm Bolt (1) |
| 4. 5/16 Nut (1) | 14. 10mm FW (1) |
| 5. 10mm x 130mm Bolt (1) | 15. Hydraulic Pump Assembly (<i>Sold Separately</i>) |
| 6. 10mm FW (1) | 16. 3/8-16 x 1-1/2 Bolt (2) |
| 7. 10mm Nut (1) | 17. 3/8 FW (2) |
| 8. 3/8-16 x 2 Bolt (1) | 18. Coil (1) |
| 9. 3/8 LW (3) | 19. Clutch (1) |
| 10. 3/8 Nut (3) | 20. Dayco Belt # 5081045 |