



CW MILL EQUIPMENT CO., INC.
P.O. Box 246 • Sabetha, Kansas 66534
(785) 284-3454 • FAX (785) 284-3601

DMK 57A-I8
2007-2010 Dodge D-2500-5500
2007-2009 Sterling Bullet
6.7 Cummins Diesel
W-AC

INSTALLATION NOTES

1. Drain radiator below upper radiator hose. Remove hose. Remove driver side upper shroud support. Remove belt. Remove return hose from power steering reservoir and let reservoir drain. Remove bolts from power steering pump through the holes in the pulley. Leaving pressure lines attached, set pump aside on passenger side of engine. Remove power steering pump brackets.
2. Install studs (2) in timing cover w/nuts (4). Install pump onto bracket using pump hardware included in the kit. Install 5/8 hose(16) onto return hose using hose barb (18) and hose clamps(17). Loosen front pressure hose on steering gear box and swing over frame rail.
3. Install pump and bracket assembly onto studs (2) using nuts(4) tighten nuts securely. NOTE: It may be easier to install hoses and power wire before power steering pump is reinstalled. Install power steering pump onto bracket using bolts (3) and LW's (5). Install power steering pump brace (8) to the intake as shown in illustration using bolts (10,11) and spacer (9). Install new belt (24) according to the belt diagram. Install idler (13) in lowest hole location possible while tensioner is retracted fully using bolt (15), FW (14), and bushing (12).
4. Install grommet (23) into shroud. Install hose rest (6) to head on driver side and the fan using flange head bolts (7). Cut 3/4" off radiator side of top radiator hose and reinstall. Connect new power steering return hose (16) to power steering reservoir using hose barb (18) and hose clamps (17). Fill reservoir w/ATF Plus 4 transmission fluid. Fill radiator and overflow tank. Check for proper belt tracking and clearances.

DMK 57A-I8 Belts

2007-2010 Dodge Truck 2500-5500

2007-2009 Sterling Bullet

6.7 Cummins Diesel

W-AC

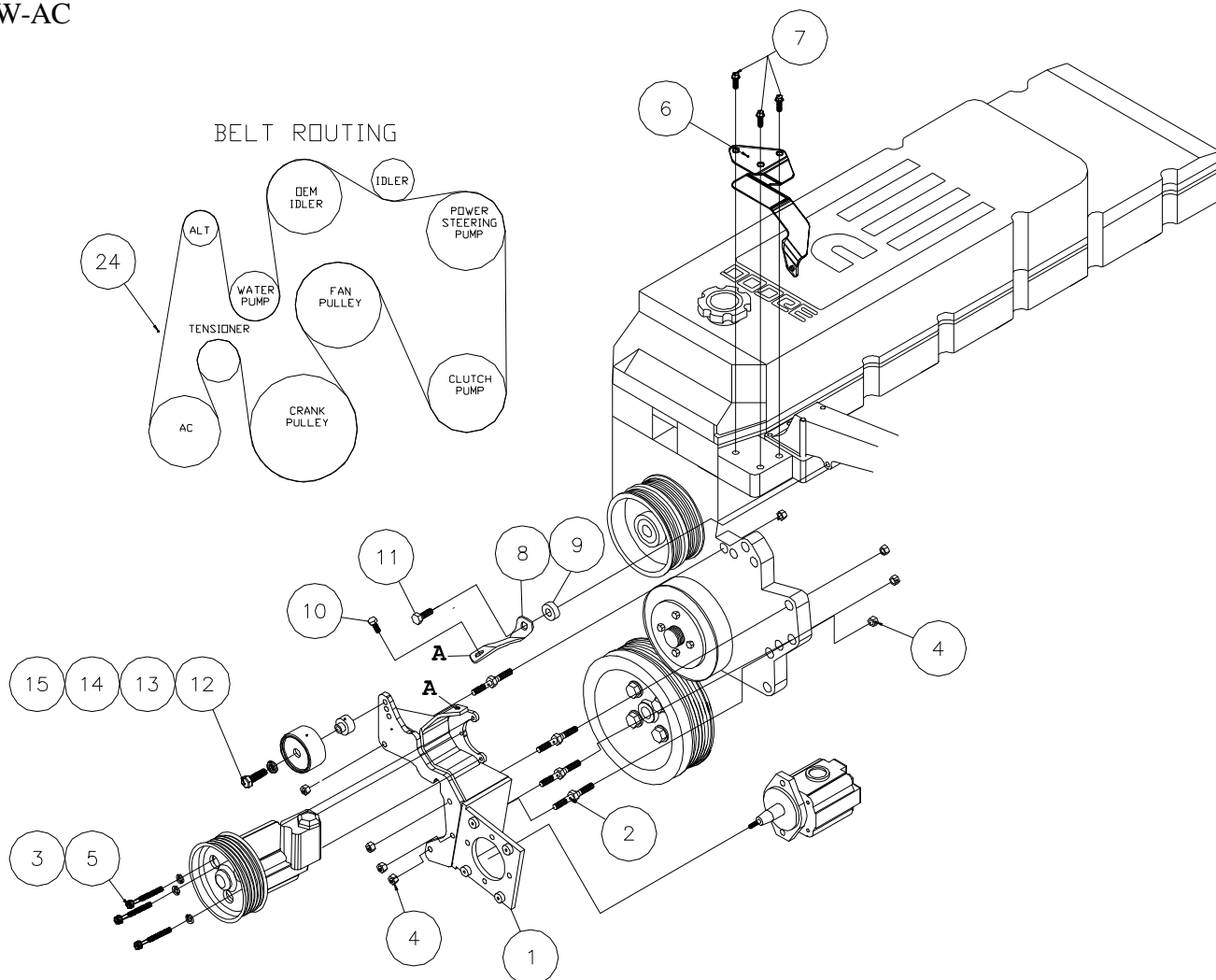

- 1. DMP57A-I8 (1)
- 2. 8mm Stud 080751.25 ST (4)
- 3. 8mm x 70mm (3)
- 4. 8mm Flange Nut (8)
- 5. 8mm LW (3)
- 6. DMB563 (1)
- 7. 10mm x 20mm Flange (3)
- 8. DMB 574 Power Steering Brace (1)
- 9. SP64-.375 (1)
- 10. 8mm x 12mm Flange (1)
- 11. 8mm x 30mm Flange (1)
- 12. DMB562 (1)
- 13. 89016 Dayco (1)

- 14. 3/8 FW (1)

- 15. 10mm x 45mm (1)

ITEMS 16-23 NOT SHOWN

- 16. 14" of 5/8" Oil Hose (1)

- 17. #10 Hose Clamp Dayco (2)

- 18. 5/8" Double Ended Hose Barb (1)

- 19. 8mm x 45mm (1)

- 20. 8mm Nut (1)

- 21. 5/16 FW (1)

- 22. 15" Plastic Tie Strap (1)

- 23. 1007863 Rubber Grommet (1)

- 24. 5081325 Dayco (1)