



CW MILL EQUIPMENT CO., INC.
P.O. Box 246 • Sabetha, Kansas 66534
(785) 284-3454 • FAX (785) 284-3601

FLMK 91-I8 Belt
1999-02 Freightliner FL-60 & 70
1999-02 Sterling w/3126 Cat

INSTALLATION NOTES

1. Disconnect negative battery cable(s). Remove the OEM serpentine belt. Remove any bolts or claps from the block at location "A".
2. Install bracket (1) with bolts (2) and lockwashers (3) at location "A", torque the bolts to 40 ft/lbs.. Install the pump onto the bracket with the bolts provided and align it with the OEM pulleys. Install the flat idler into the bottom hole in the bracket with bushing (4), flat washer (8) and bolt (7). Install the grooved idler onto the bracket at the other location with bushing (4), flatwasher (8) and bolt (7).
3. Install the new belt onto the engine according to the belt diagram. If the belt is too short, move the flat idler up to the next hole. Check all hoses, wires, etc. that may have been moved during installation to make sure they are not rubbing against any moving parts. Connect the battery and run the engine to check for proper belt tracking.

FLMK 91-I8 Belt

1999-02 Freightliner FL60 & 70

1999-02 Sterling w/3126 Cat

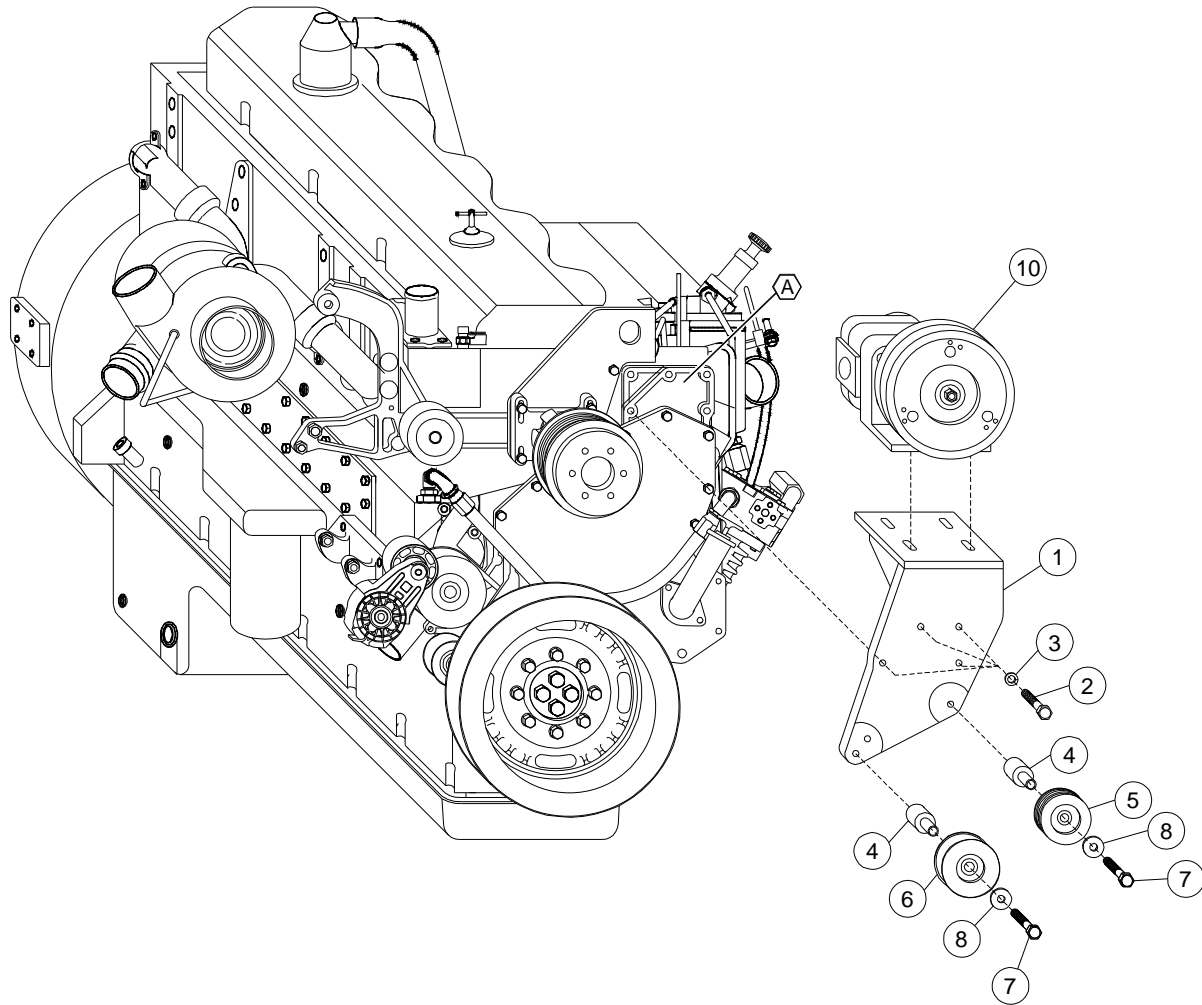

PARTS LIST

- 1. FLMP 91(0-4) (1)
- 2. 10mm x 55mm 10.9 (4)
- 3. 10mm LW (4)
- 4. FLMB 911 (2)
- (GPKDFL91 Assy includes items 4,5,7,8)
- 5. GPCD8 (1)
- (IPKDFL91) Assy includes items 4,6,7,8)
- 6. IPCD (1)
- 7. 12mm x 65mm (2)
- 8. 12mm LW (2)
- 9. Pump Belt (Not Shown) (1)
Dayco # 5081223
- 10. Clutch Pump Assembly
(Sold Separately)

