

## INSTALLATION NOTES

---

1. Disconnect negative battery cable. Remove driver's side radiator support brace. Remove the OEM belt. Remove the four bolts holding the fan to the fan pulley and let fan lay inside the fan shroud. Be careful not to damage the radiator. Install new drive pulley (1) with new clutch pump drive belt (7) draped over the top of drive pulley (1) using bolts (2) going through the fan, pump drive pulley (1), then OEM fan pulley. Tighten bolts to 45 ft.lbs.. Reinstall OEM belt.
2. Remove the radiator support bracket from the cylinder head and install the pump bracket (3) in its place using bolts (4). Use a straight edge to align the tensioner mount parallel with drive pulley. Tighten bolts securely. Install the clutch pump onto bracket (3) using the hardware shown on the back. Align clutch with the drive pulley using a straight edge. Alignment is the installer's responsibility. Tighten all bolts securely.
3. Install the tensioner (5) onto the bracket (3) using bolt (6). Install new pump drive belt (7). Install the radiator support brace with original bolts. Connect the battery cable. Run the engine and check for proper belt tracking and adjust if necessary.

NOTE: Check all wires and hoses that may have been disturbed during installation to make sure they are not up against any hot or moving parts.

# FLMK70-8

2011-2016 FREIGHTLINER M2

CUMMINS ISB 6.7L

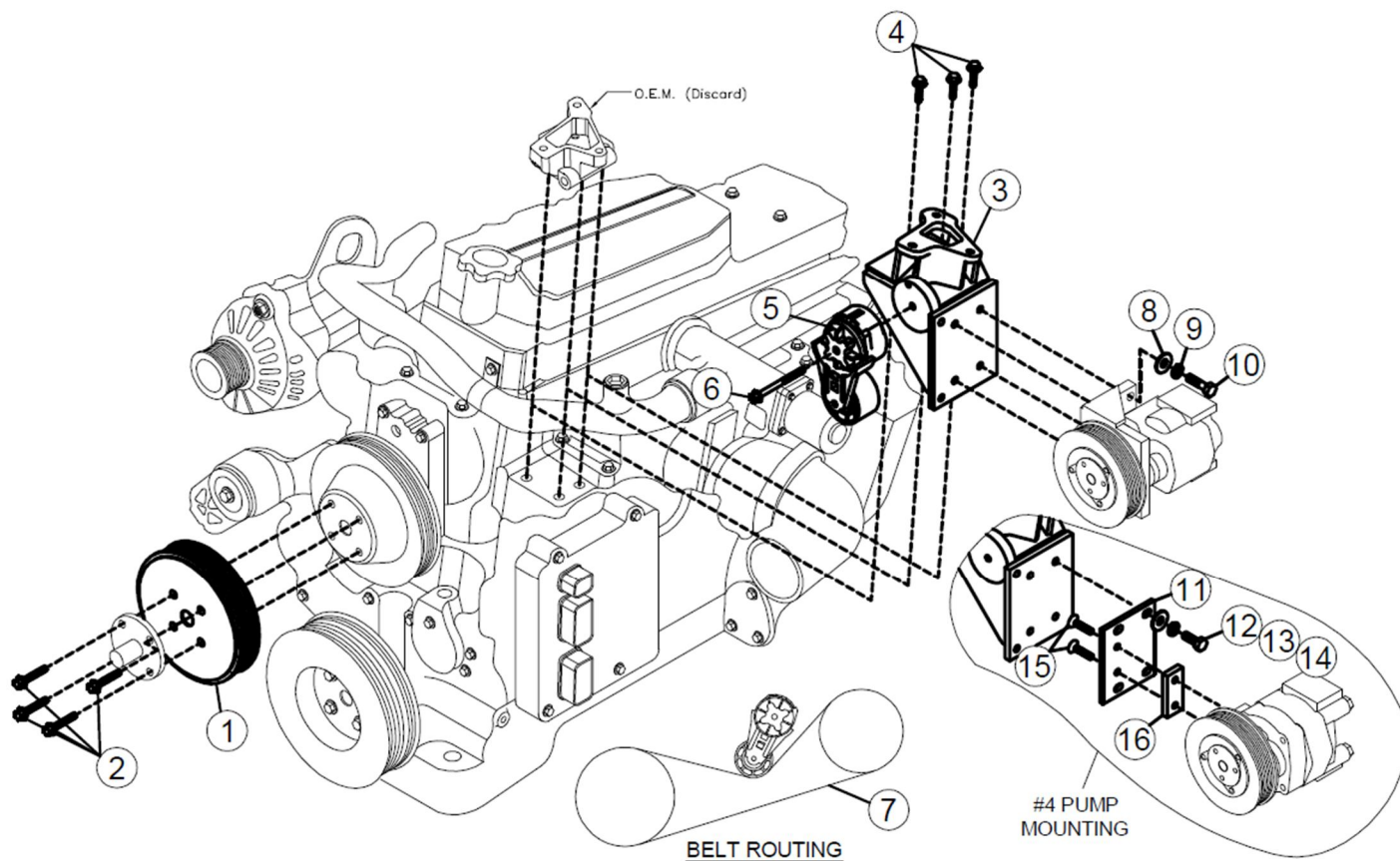

## PARTS LIST

1. FLPC708 (1)
  2. 10mm x 30mm Flange Bolt (4)
  3. FLMP702-8 (1)
  4. 10mm x 30mm Flange Bolt (3)
  5. 89200B (1)
  6. 10mm x 80mm MOD (1)
  7. Dayco 5080435 with 5-1/2" Clutch
- ITEMS 8-10 FOR USE WITH #2 PUMP**
8. 3/8 Flat Washer (4)

9. 3/8 Lock Washer (4)
10. 3/8 x 1-1/2 (4)

**ITEMS 11-16 FOR USE WITH #4 PUMP**

11. DMP554 (1)
12. 3/8 LW (4)
13. 3/8 FW (4)
14. 3/8 X 1 (4)
15. 1/2 X 1-3/4 FHSCS (2)
16. 1/4" #4 Pump Tab (1)

*Note: with 6" clutch belt used is Dayco 5080440*