



CW MILL EQUIPMENT CO., INC.  
P.O. Box 246 • Sabetha, Kansas 66534  
(785) 284-3454 • FAX (785) 284-3601

**FMK 271A-I8**  
2004-07 Ford 650 & 750  
5.9L Cummins  
W/AC, W-W/O Air Brakes

## INSTALLATION NOTES

---

1. Disconnect negative battery cables. Remove the turbo cooler tube from the passenger side engine compartment and remove the rubber couplers from the steel tube. Remove the O.E.M. belt, alternator, alternator bracket, and lifting lug from the passenger side of the engine.
2. Install the pump bracket (1) with bolts (3). Torque bolts to 40 ft/lbs. Remove the top two air conditioner mounting bolts. Install bracket (2) with bolts (6) and lock washers (7). Do not tighten. Install bolts (5). Tighten bolts (5) and (6) finger tight; then torque bolts (5) to 40 ft. lbs. and bolts (6) to 25 ft. lbs.
3. Install the pump into bracket (1) with bolts (8), flat washers (9), lock washers (10), and nuts (11). Install the coil and clutch as per manufacturer instructions. Install idler (15), bushing (16), and bolt (17). Torque bolt to 30 ft. lbs. Install the O.E.M. alternator with lock washers (4), spacers (18), and bolts (19). Install the new belt (20) according to the belt diagram. Install the O.E.M. turbo cooler tube backwards from its original location using new elbows (21) and clamps (22). Align the tube for best fit then tighten clamps securely.
4. Use the plastic tie straps supplied in the kit to secure any hoses, wires, etc., that may come in contact with any hot or moving parts. Reconnect battery cables. Run engine and check for proper belt tracking and clearances.

**NOTE:** Check all engine compartment vacuum hoses and electrical wiring that have been disturbed or re-routed during kit installation to be sure that hoses are not kinked, that they do not touch any high temperature item, and that they do not interfere with any linkage components.

# FMK 271A-I8

2004-07 Ford 650 & 750

5.9L Cummins

W/AC

W-W/O Air Brakes

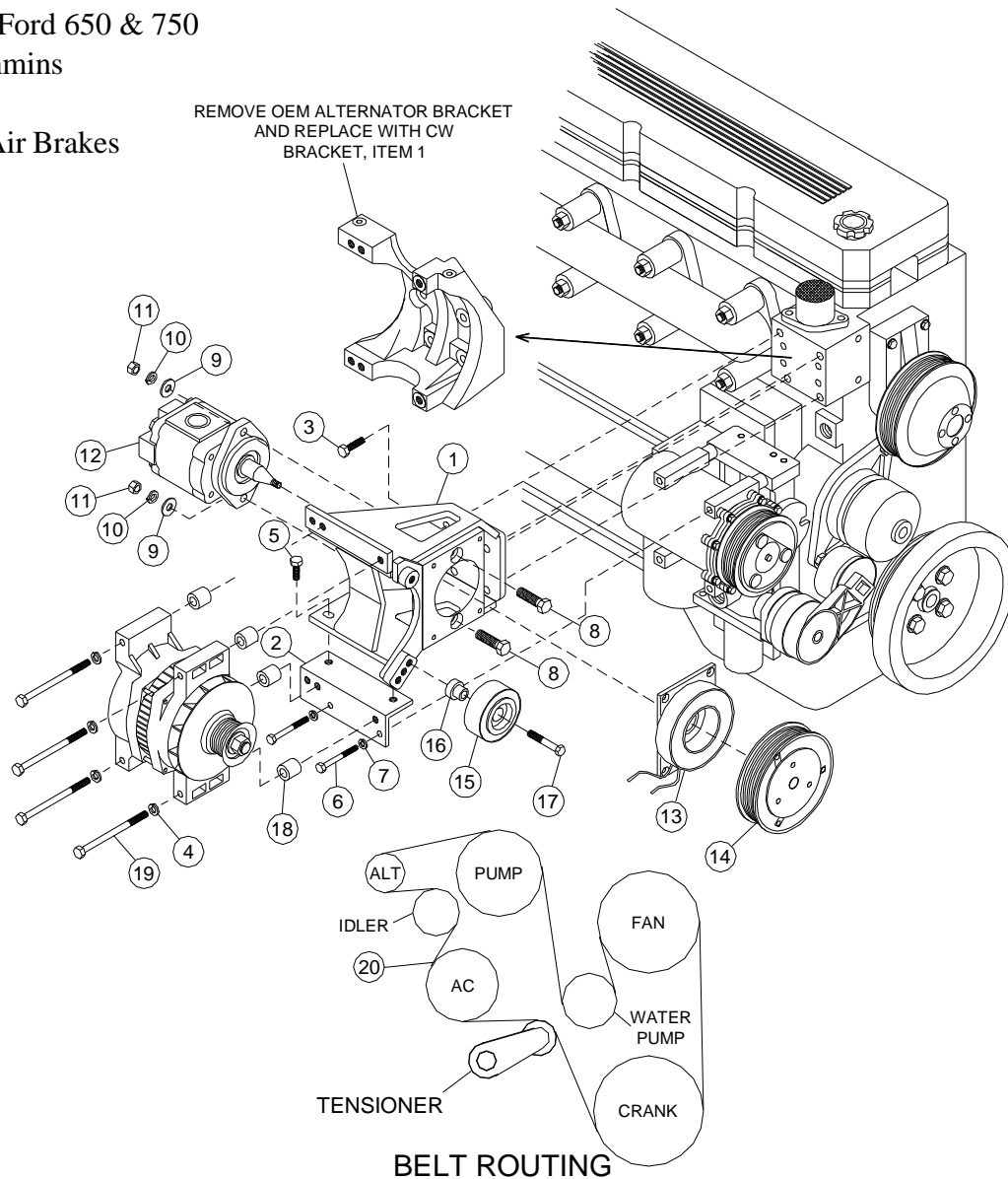

## PARTSLIST

1. FMB 271A (1)
2. FMB 2711 (1)
3. 10mm x 30mm Flange Bolt (4)
4. 10mm LW (4)
5. 10mm x 20mm Flange Bolt (2)
6. 8mm x 90mm (2)
7. 8mm LW (2)
8. 3/8 x 1-1/2 Bolt (2)
9. 3/8 FW (2)
10. 3/8 LW (2)
11. 3/8 Nut (2)
12. Clutch Pump Assembly  
(Sold Separately)
13. Coil (Sold Separately)
14. Clutch (Sold Separately)
15. 89016 Dayco
16. FMB 2731 (1)
17. 10mm x 40mm Flange Bolt (1)
18. SP100-1.00 Spacer (4)
19. 10mm x 120mm Bolt (4)
20. Belt, Dayco 5080953
- (Items Below Not Shown)
21. 45deg. 3-1/2" Rubber Elbow  
TP1189 (2)
22. Five Star 250-092 Clamp (4)
23. Plastic Tie Strap (5)