



CW MILL EQUIPMENT CO., INC.
P.O. Box 246 • Sabetha, Kansas 66534
(785) 284-3454 • FAX (785) 284-3601

FMK 30 - 2 Belts
1973-79 Ford Truck
F-150,250,350
360,390
WO/A.I.R., W-WO/AC, PS

INSTALLATION NOTES

1. Disconnect battery terminal, remove fan and belts.
2. Remove bolts and washers from pulley on front of crankshaft. Install drive pulley (1) with bolts and washers provided. **CAUTION:** Be sure new bolts have the same threads as O.E.M. bolts removed. Secure pulley bolts.
3. Remove alternator bracket and adjustment strap. Install pump bracket (9) and alternator using spacers and bolts as shown. Leave bolt (13) loose for alternator belt adjustment. Bolt alternator adjustment strap to bracket and alternator, leave loose.
4. Install fan spacer (6) and fan with bolts (7), if necessary for fan to pulley clearance. **CAUTION:** Be sure bolts (7) are proper length-approx. 1/2 longer than O.E.M. fan bolts removed.
5. Replace alternator belt with belt (23) supplied. Tension alternator, AC, PS belt(s). Tighten bolts (13,17) holding alternator.
6. Loosely bolt clutch pump to pump plate (10), fasten pump plate to bracket (9) with bolts (15,17), leave loose. Align clutch pump pulley to drive pulley (1), secure pump bolts. Install pump drive belts (24) and tension. Connect battery terminal.
7. **CAUTION:** Check all engine compartment vacuum hoses and electrical wiring that may have been disturbed or re-routed during kit installation to be sure that hoses are not kinked, that they do not touch any high temperature items, and that they do not interfere with any linkage components.

NOTE: This kit is designed to operate successfully with the standard fan supplied by the manufacturer of your truck. Due to O.E.M. assembly tolerances, visually make certain that there is adequate clearance between fan and drive pulley, and also fan and radiator. It may be necessary to use a longer spacer for pulley clearance. If there is little clearance to the radiator, check to insure that it will not flex into the radiator before operating. Move radiator if necessary. Fan shroud may need notched for belt clearance.

FMK 30-2 Belts

1973-79 Ford 360, 390

W-WO/AC, W-WO/PS, WO/A.I.R.

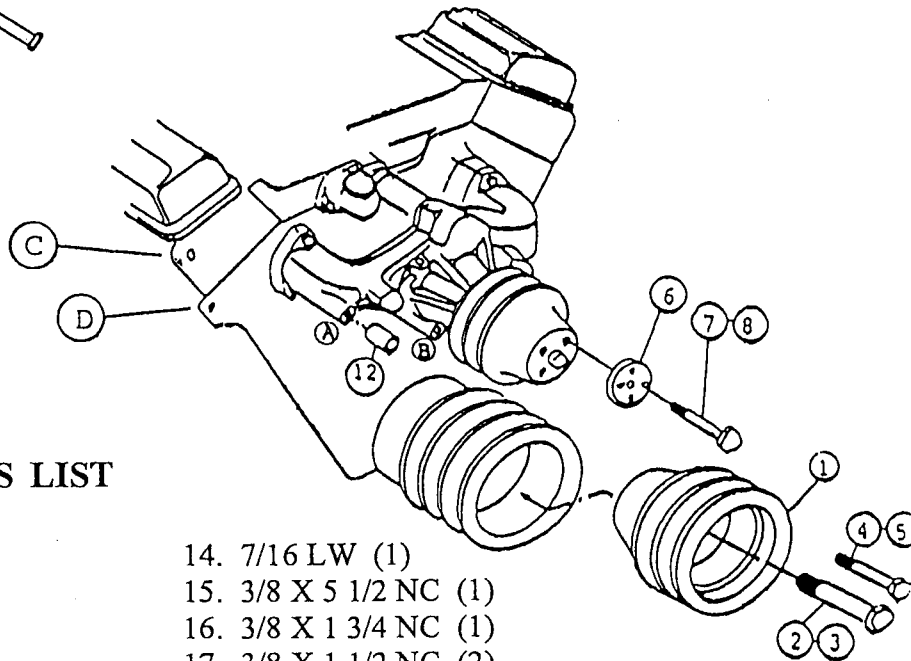
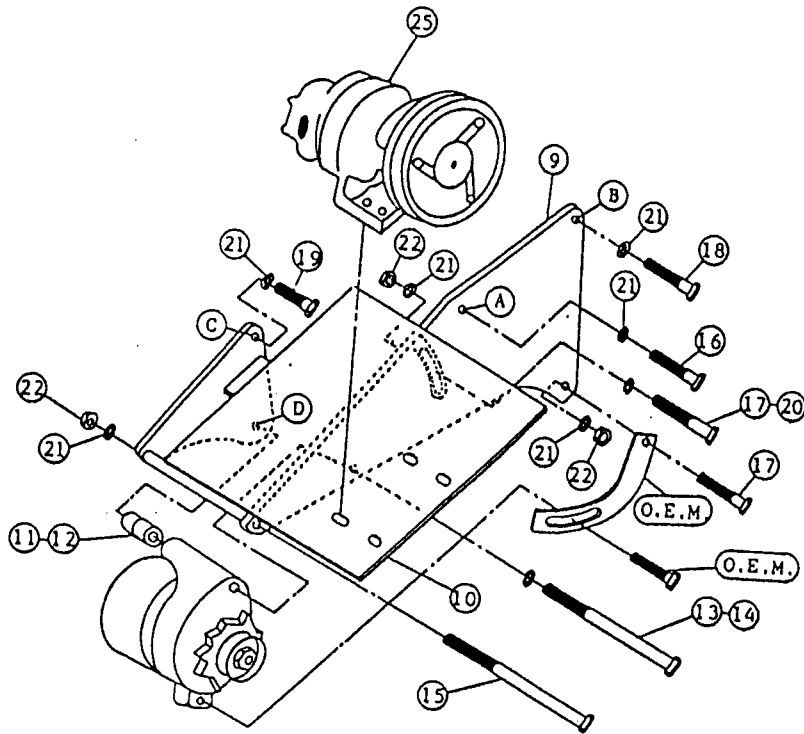

PARTS LIST

- | | |
|---------------------|--|
| 1. FPC 302 (1) | 14. 7/16 LW (1) |
| 2. 5/8 X 3 NF (1) | 15. 3/8 X 5 1/2 NC (1) |
| 3. 5/8 LW (1) | 16. 3/8 X 1 3/4 NC (1) |
| 4. 3/8 X 4 NC (3) | 17. 3/8 X 1 1/2 NC (2) |
| 5. 3/8 LW (3) | 18. 3/8 X 1 1/4 NC (1) |
| 6. FSO 505B (1) | 19. 3/8 X 1 NC (1) |
| 7. 5/16 X 4 NF (4) | 20. 3/8 FW (1) |
| 8. 5/16 LW (4) | 21. 3/8 LW (7) |
| 9. FMB 301 (1) | 22. 3/8 NC (3) |
| 10. FMP 30(0-4) (1) | 23. 15430 Dayco Belt (1) (Not Shown) |
| 11. SP88-0.750 (1) | 24. AX-49 (2) (Not Shown)(#2 AX-48,#4 AX-47) |
| 12. SP88-0.375 (2) | 25. Clutch Pump (1) |
| 13. 7/16 X 6 NC (1) | (Sold Separately) |

NOTE: May need to move fuel vapor canister.