



CW MILL EQUIPMENT CO., INC.  
P.O. Box 246 • Sabetha, Kansas 66534  
(785) 284-3454 • FAX (785) 284-3601

**FMK 33 - 2 Belts**  
1982-87 Ford Truck  
F-150,250,350  
302,351 W-WO/AC, A.I.R.

## INSTALLATION NOTES

---

1. Disconnect battery terminal, Remove belts and fan.
2. Remove 4 bolts and washers from pulley on front of crankshaft. Do not remove large center bolt. Install steel drive pulley (1) with provided bolts (2) and washers (3).  
**CAUTION:** Be sure new bolts have same threads as O.E.M. bolts removed.
3. Remove power steering pump from original position. Cut pump bracket as shown in diagram to 4 1/16.
4. Remove bolt shown at mounting location (B) shown in diagram. Install mounting bracket (8) with spacers (10 & 11) and bolts (12 & 15). Do not tighten.  
**NOTE:** Replace spacer (11) with spacer (10) on engine without AC.
5. Remove fan studs and replace with provided studs (5). Install fan spacer (4) and fan, tighten securely.
6. Install and tighten belts to specified tension. Tighten all other loose bolts.
7. Install pump plate (9) with bolts (14 & 16). Mount clutch pump (21) to plate with bolts (16). Make sure clutch pulley is in line with steel drive pulley (1). Tighten pump bolts (16) securely.
8. Install pump drive belts (20), adjust pump plate (9) for proper belt tension. Tighten bolts (14 & 16) on pump plate. Connect battery terminal.

**CAUTION:** Check all engine compartment vacuum hoses and electrical wiring that may have been disturbed or re-routed during kit installation to be sure that hoses are not kinked, that they do not touch any high temperature item, and that they do not interfere with any linkage components.

**NOTE:** This kit is designed to operate successfully with the standard fan supplied by the manufacturer of your truck. Due to O.E.M. assembly tolerances, visually make certain that there is adequate clearance between fan and drive pulley, and also fan and radiator. It may be necessary to use a longer spacer for pulley clearance. If there is little clearance to the radiator, check with Ford dealer to insure that it will not flex into the radiator before operation.

*Fan shroud may need notched for belt clearance.*

# FMK 33-2 Belts

1982-87 Ford 302,351

W-WO/AC,A.I.R.

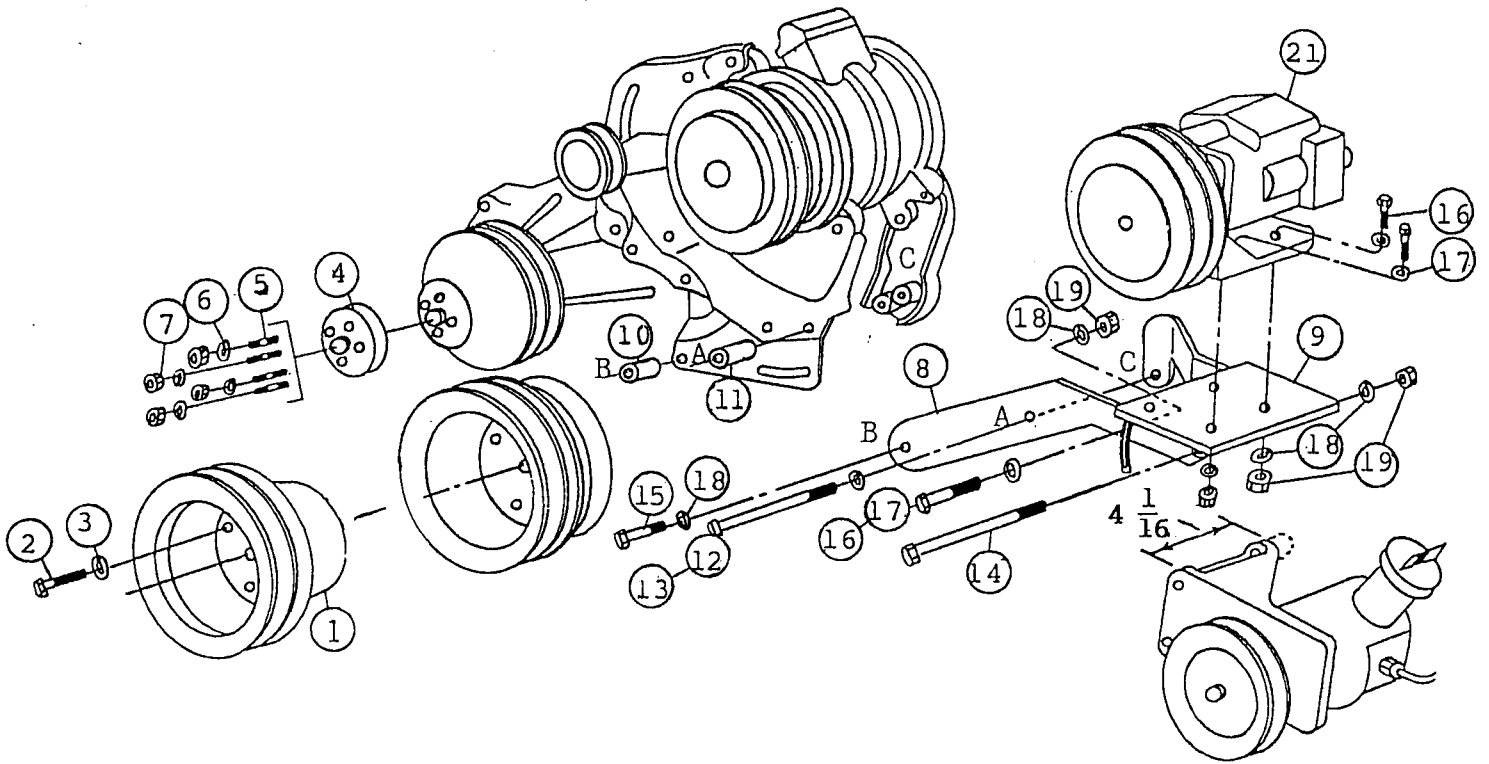

## PARTS LIST

- |                                  |   |
|----------------------------------|---|
| 1. FPC 322 (1)                   | 11. SP88-1.312 (1)                            |
| 2. 3/8 X 1 3/4 NC (4)            | 12. 7/16 X 8 NC (1)                           |
| 3. 3/8 LW (4)                    | 13. 7/16 LW (1)                               |
| 4. FSO 608 (1)<br>FSO 508 (1)    | 14. 3/8 X 5 1/2 (1)                           |
| 5. 5/16 X 2 1/2 ST (4)           | 15. 3/8 X 2 3/4 NC (1)                        |
| 6. 5/16 LW (4)                   | 16. 3/8 X 1 1/2 NC (5)                        |
| 7. 5/16 NC (4)                   | 17. 3/8 FW (5)                                |
| 8. FMB 320 (1)                   | 18. 3/8 LW (7)                                |
| 9. FMP 32(0-4) (1)               | 19. 3/8 NC (6)                                |
| 10. SP88-1.500 (2) - (Use WO/AC) | 20. AX-62 (2) (Not Shown)                     |
|                                  | 21. Clutch Pump Assembly<br>(Sold Separately) |

**NOTE:** Power steering belt may need tightened or replaced with 1/2" longer belt to avoid contact with #11 spacer.  
Make sure pulley (1) is fully piloted into crankshaft.  
Discard unused fan spacer.