



CW MILL EQUIPMENT CO., INC.
P.O. Box 246 • Sabetha, Kansas 66534
(785) 284-3454 • FAX (785) 284-3601

FMK 34 -2 Belts

1987 FORD F-150,250

302 W-WO/AC
(Serpentine)

INSTALLATION NOTES

1. Disconnect battery terminal. Remove belt and fan.
2. Remove bolts from pulley on front of crankshaft. Install drive pulley (1) with provided bolts and washers.
CAUTION : Be sure bolts have the same thread as O.E.M. bolts removed.
3. Remove bolts/nut at all mounting locations shown.
WO/AC - Remove O.E.M. idler bracket.
4. Install bracket with provided bolts and spacers.
WO/AC - Replace spacers (13) with bracket (8) and use spacers (14) at locations "F & G". Secure bracket bolts.
5. Install fan studs (5) and fan spacer (4), install fan and tighten securely.
6. **WO/AC** - install O.E.M. idler pulley to bracket (8) using bushing (9) and hardware as shown. Check pulley alignment. Install serpentine belt as shown on decal located by hood latch.
7. Install pump plate (10) with bolts (17 & 20). Mount clutch pump (35) to plate with bolts (19). Align clutch pulley to drive pulley (1), tighten pump bolts (19) securely.
8. Install pump drive belts (34), adjust pump plate (10) for proper belt tension. Tighten bolts (17 & 20) on pump plate.
9. Secure power steering hose away from mounting bracket and drive belts. Connect battery terminal.

CAUTION: Check all engine compartment vacuum hoses and electrical wiring that may have been disturbed or re-routed during kit installation to be sure that hoses are not kinked, that they do not touch any high temperature item, and that they do not interfere with any linkage components.

NOTE: Visually make certain that there is adequate clearance between fan and drive pulley, and also fan to radiator. It may be necessary to use a longer spacer for pulley clearance. If there is little clearance to the radiator, check with Ford dealer to insure that it will not flex into the radiator before operating. Provide adequate clearance between fan and radiator before operating.

FMK 34 -2 Belts

1987 Ford

302 W-WO/AC

(SERPENTINE)

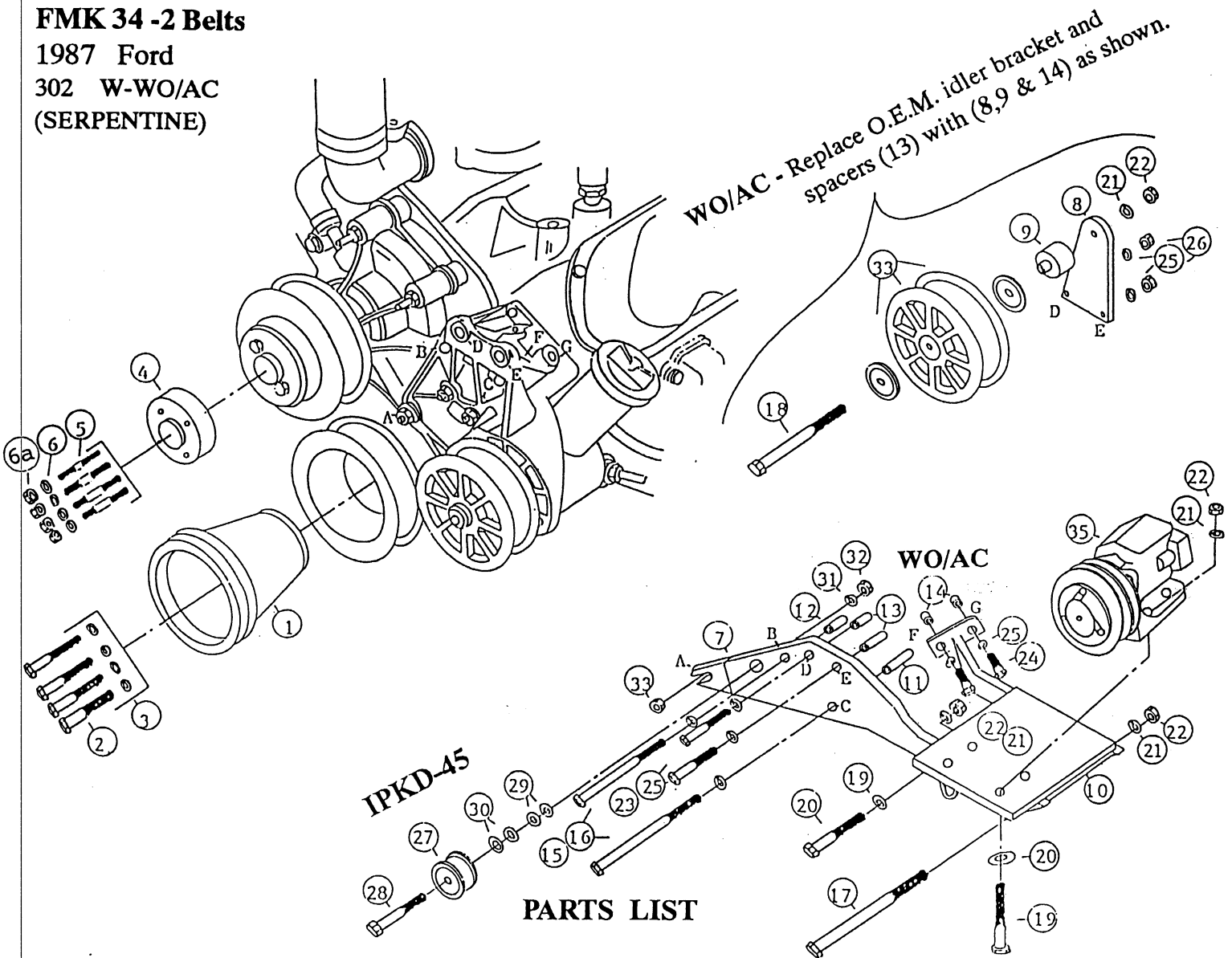

PARTS LIST

- | | |
|---------------------------------|---|
| 1. FPC 342 (1) | 18. 3/8 X 2 1/2 NC (1) |
| 2. 3/8 X 1-3/4 NC (4) | 19. 3/8 X 1 1/2 NC (5) |
| 3. 3/8 LW (4) | 20. 3/8 FW (5) |
| 4. FSO 508 (1) | 21. 3/8 LW (7) |
| 5. 5/16 X 2 1/2 ST (4) | 22. 3/8 NC (7) |
| 6. 5/16 LW (4) | 23. 10mm X 55mm 1.5 (2) |
| 6a. 5/16 NC (4) | 24. 10mm X 40mm 1.5 (2) |
| 7. FMB 340 (1) | 25. 10mm LW (4) |
| 8. FMB 341 (1) WO/AC | 26. 10mm 1.5 (2) |
| 9. FMB 342 (1) WO/AC | 27. IPKD-45 (1) |
| 10. FMP 34(0-4) (1) | 28. 5/8 X 4 1/2 NC (1) |
| 11. SP88-1.687 (1) | 29. 5/8 FW (5) |
| 12. SP88-1.593 (1) | 30. IPW14 (5) |
| 13. SP88-0.500 (2) W/AC | 31. 5/8 LW (1) |
| 14. SP88-0.375 (2) WO/AC | 32. 5/8 NC (1) |
| 15. 7/16 X 7 1/2 NC (2) | 33. O.E.M. |
| 16. 7/16 LW (2) | 34. AX-59 (2) (Not Shown) (#4 6" AX-57) |
| 17. 3/8 X 4 NC (1) | 35. Clutch Pump Assembly (1) |
| | (Sold Separately) |