



CW MILL EQUIPMENT CO., INC.
P.O. Box 246 • Sabetha, Kansas 66534
(785) 284-3454 • FAX (785) 284-3601

FMK 42 - 2 Belts
1983-87 Ford Truck
F-250,350
460 W-WO/AC, A.I.R.

INSTALLATION NOTES

1. Disconnect battery terminal, remove belts and fan.
2. Remove bolts and washers from pulley on front of crankshaft. Do not remove large center bolt. Install steel drive pulley (1) with provided bolts (6).
NOTE: Be sure center bolt on crankshaft pulley is torqued to 70-90ft/lbs.
3. Remove bolts shown at mounting locations shown in diagram. Install mounting bracket (12) with spacer (14) and bolts (16,17 & 21).
NOTE: Most use spacers (15) at locations A,B & C. Place bolt (17) and spacers (15 WO/AC) on bracket at location C and slide into place together. There is not enough room to insert bolt after bracket is on.
4. Remove fan studs and replace with provided studs (9). Install fan spacer (8) and fan, tighten securely.
5. Install and tighten belts to specified tension. Tighten all other loose bolts.
6. Install pump plate (13) with bolts (20 & 21). Mount clutch pump (26) to plate with bolts (21). Make sure clutch pulley is in line with steel drive pulley (1). Tighten pump bolts (21) securely.
7. Install pump drive belts (25). Adjust pump plate (13) for proper belt tension. Tighten bolts (20 & 21) on pump plate. Connect battery terminal.

CAUTION: Check all engine compartment vacuum hoses and electrical wiring that may have been disturbed or re-routed during kit installation to be sure that hoses are not kinked, that they do not touch any high temperature items, and that they do not interfere with any linkage components.

NOTE: Power steering line may need to be adjusted for clearance. This kit is designed to operate successfully with the standard fan supplied by the manufacturer of your truck. Due to O.E.M. assembly tolerances, visually make certain that there is adequate clearance between fan and drive pulley, and also fan and radiator. It may be necessary to use a longer spacer for pulley clearance. If there is little clearance to radiator, check with Ford dealership to insure that it will not flex into the radiator before operation.

Fan shroud may need notched for belt clearance.

FMK 42 -2 Belts

1983-87 Ford 460

W-WO/AC, A.I.R.

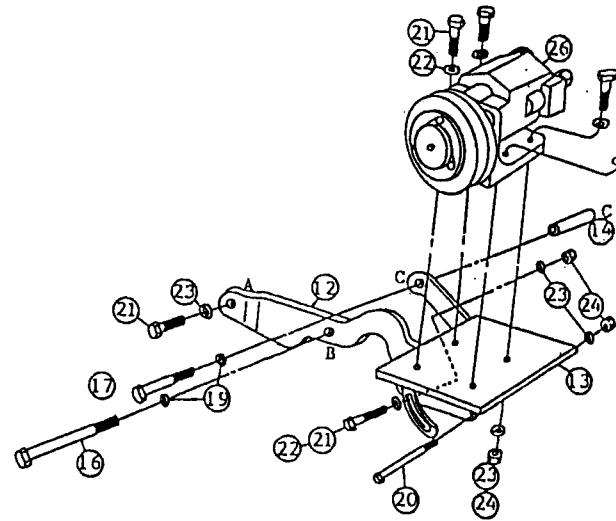
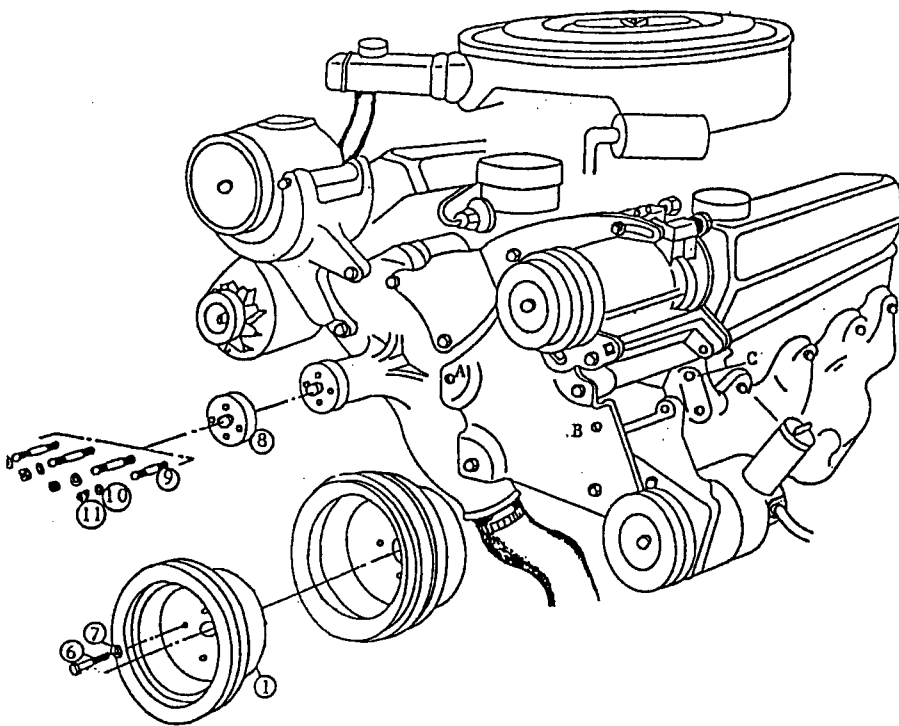

NOTE: Without AC use spacers (15) at locations A,B & C.

NOTE: Place bolt (17) and spacer (15 WO/AC) on bracket (Hole C) and slide into place.

PARTS LIST

- | | |
|--------------------------------|--------------------------------------|
| 1. FPC 422 (1) | 16. 7/16 X 6 NC (1) |
| 6. 3/8 X 1 3/4 NC (4) | 17. 7/16 X 2 1/2 NC (1) |
| 7. 3/8 LW (4) | 18. 7/16 FW (2) |
| 8. FSO 610 (1) | 19. 7/16 LW (2) |
| FSK 634 (1) (Flex fan) | 20. 3/8 X 4 NC (1) |
| 9. 5/16 X 2 3/4 ST (4) | 21. 3/8 X 1 1/2 NC (6) |
| 10. 5/16 LW (4) | 22. 3/8 FW (5) |
| 11. 5/16 NC (4) | 23. 3/8 LW (7) |
| 12. FMB 420 (1) | 24. 3/8 NC (6) |
| 13. FMP 42(0-4) (1) | 25. AX-63 (2) (Not Shown) (#4 AX-61) |
| 15. SP88-0.250 (3) (Use WO/AC) | 26. Clutch Pump Assembly) (1) |

NOTE: Most 460's require the use of spacers (15) with AC.

A slightly shorter PS belt may be necessary on late model trucks (15/32 X 53 1/2).

Location "A" is on PS bracket, not bolt above it.