



CW MILL EQUIPMENT CO., INC.
P.O. Box 246 • Sabetha, Kansas 66534
(785) 284-3454 • FAX (785) 284-3601

FMK 66LA-8
1999-2003 Ford Truck 250-550
7.3 Direct Injected Intercooled Diesel
W-WO/AC or Dual Alternator

INSTALLATION NOTES

1. Disconnect negative battery terminals. Drain radiator until coolant level is below thermostat. Remove upper radiator hose, tire, wrench and jack tools from the radiator support. Remove the three bolts from the radiator reservoir and move it aside. Remove the fan and fan shroud, fan nut has right hand threads. Remove the plastic engine cover.
2. Remove OEM belt and alternator. Use powersteering pulley puller, (Snap-On PN# CJ117, MAC PN# PP7185M or it's equivalent) to remove powersteering pulley. Remove the three bolts holding the powersteering pump to the bracket, do not remove hoses from PS pump. Remove the four bolts holding the powersteering and alternator bracket to the engine and remove the bracket.
3. Install the new alternator and pump bracket (4) onto the engine using bolts (9 & 10) with lockwashers (11). Bolt the powersteering pump onto the new bracket using the O.E.M. bolts. Install the powersteering pulley onto the powersteering pump using a pulley installation tool, (Snap On PN# CJ113B, Mac PN# PP7005M or it's equivalent). Install the alternator onto bracket (4) using O.E.M. bolts. Install O.E.M. serpentine belt.
NOTE: Since the alternator location was altered, the O.E.M. belt may fit slightly tighter.
4. Install drive pulley (1) on the front of the harmonic balancer with bolts (2) and lockwashers (3).
5. Install pump into plate (5) using bolts (13), flatwashers (14), lockwashers (15), and nuts (16) as shown in the illustration. Tighten. Install the coil and clutch pulley as per manufacturers instructions. Install pump and plate onto pump bracket using bolts (12), flatwashers (14), and lockwashers (15). Align pump pulley to crankshaft pulley (1), tighten plate bolts securely.
6. Install spring loaded tensioner (6) onto the tensioner boss (making sure that the line-up pin is in place) with bolt (7) and lockwasher (8), tighten. Install the pump drive belt according to the belt diagram.
7. Install the fan and fan shroud. Install the upper radiator hose according to the instructions on the attached sheet. Replace the coolant reservoir, tire wrench and jack tools. Connect battery cables. Start the engine and check to make sure the belt is tracking properly. Adjust if necessary.

CAUTION: Check all engine compartment vacuum hoses and electrical wiring that may have been disturbed or re-routed during kit installation to be sure that hoses are not kinked, that they do not touch any high temperature item, and that they do not interfere with any linkage components.

FMK 66LA-8

1999-2003 Ford Truck 250-550

7.3 D.I.T. Intercooled Diesel

W-WO/AC/Dual Alternator

CAUTION: Due to limited space available in the engine compartment, the pump is mounted directly under the hood light. Check clearance between the light and the pump before closing the hood. If there is not enough clearance, relocate the hood light to provide clearance.

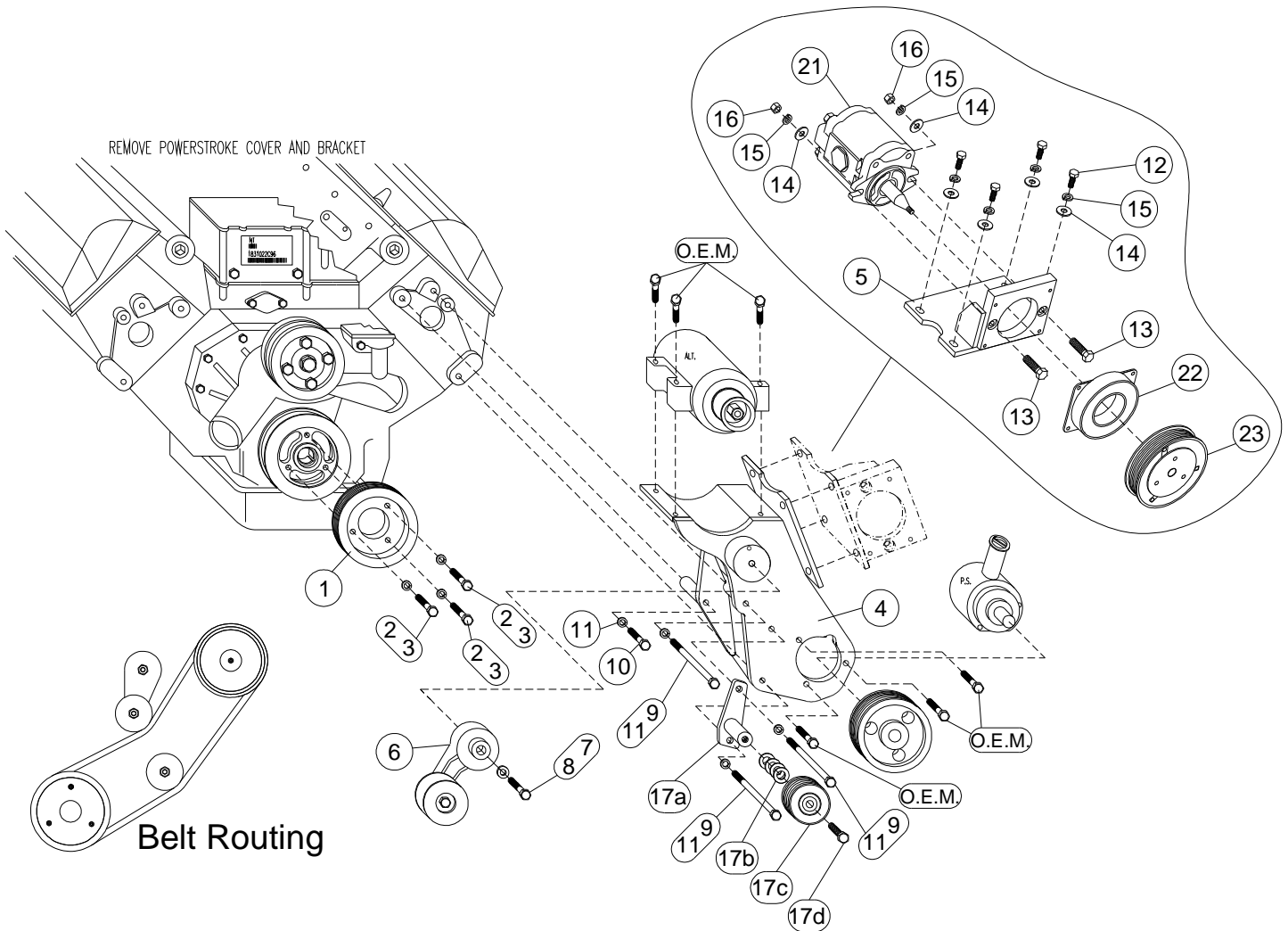

PARTS LIST

1. FPC 65812 (1)
2. 10mm x 40mm 1.5 (3)
3. 10mm LW (3)
4. FMB 660 (1)
5. FMP 66L (1)
6. Dayco 8920236 (1)
7. 12mm x 90mm 1.5 (3)
8. 12mm LW (1)
9. 10mm x 140mm 1.5 (3)
10. 10mm x 80mm 1.5 (1)
11. 10mm LW (4)
12. 3/8 x 1 NC (4)
13. 3/8 x 1 1/2 NC (2)
14. 3/8 FW (6)
15. 3/8 LW (6)
16. 3/8 NC Nut (2)

GPCKDF 66-8 Assembly (items 17a-17d)

- 17a. FMB662 (1)
- 17b. IPW 14 Shim (4)
- 17c. GPCD8 (1)
- 17d. 5/8 x 2 1/2 NC (1)
18. F66 Rad. Line (Not Shown) (1)
19. #28 Hose Clamp (Not Shown) (2)
20. Belt (Not Shown) (1)
With 5-1/2" Clutch-Dayco # 5080675
21. Pump (Sold Separately)
22. Coil (Sold Separately)
23. Clutch Pulley (Sold Separately)

Note: With 6" Clutch-5080685 Belt