



CW MILL EQUIPMENT CO., INC.
P.O. Box 246 • Sabetha, Kansas 66534
(785) 284-3454 • FAX (785) 284-3601

SMK 33-2 Belts

1999-2007 Isuzu
4.7L, 5.2L Diesel
W-WO/AC

NOTE: MUST USE SIDE PORTED PUMP.

INSTALLATION NOTES

1. Disconnect the negative battery cable. Remove the three bolts holding the fan shroud to the engine braces. Remove the four nuts from the fan clutch and remove the fan and fan clutch assembly from the engine. Loosen the alt. belt and A/C belt if equipped. Remove the fan clutch mounting plate from the water pump.
(Do not remove the pulley).
2. Remove the four bolts holding the crank pulley on the crankshaft.
(It may be necessary to use an impact to remove the bolts). Clean any dirt or rust from the inside of the OEM pulley. Install the drive pulley (1) using four 16mm bolts (2) and lockwashers (3). Tighten securely. Install the aluminum fan spacer (4) and the OEM fan clutch adapter onto the water pump using bolts (5) and lockwashers (6).
3. Before the pump bracket can be installed a boss on the front of the engine block (approx. 1") must be removed. This can be done using a Hacksaw etc. (See illustration)
4. Remove the lower alternator bracket. Remove the front two motor mount bolts. Install the pump mounting bracket (7) and spacer plate (8) onto the engine block at that location using bolts (10) and lockwashers (9). Install the alternator on the new pump bracket using the O.E.M. bolt and nut. Install the pump onto the bracket and align it with the drive pulley, tighten. Install the idler (11) and align it with the drive pulley by using shims (13). Install the O.E.M. belt(s). Install the pump belts and tension.
5. Install the fan onto the water pump with the four O.E.M. nuts. Using the 1/2 spacers, move the fan shroud ahead and hold in place with bolts provided. **NOTE:** The fan shroud brace on the lower passenger side will need to be removed and a nylon strap is used to hold it in place. Connect the negative battery cable. Check for clearance on all hoses, wires, etc.

SMK 33-2 BELTS

1999-2007 Isuzu

4.7L,5.2L Diesel

W-WO/AC

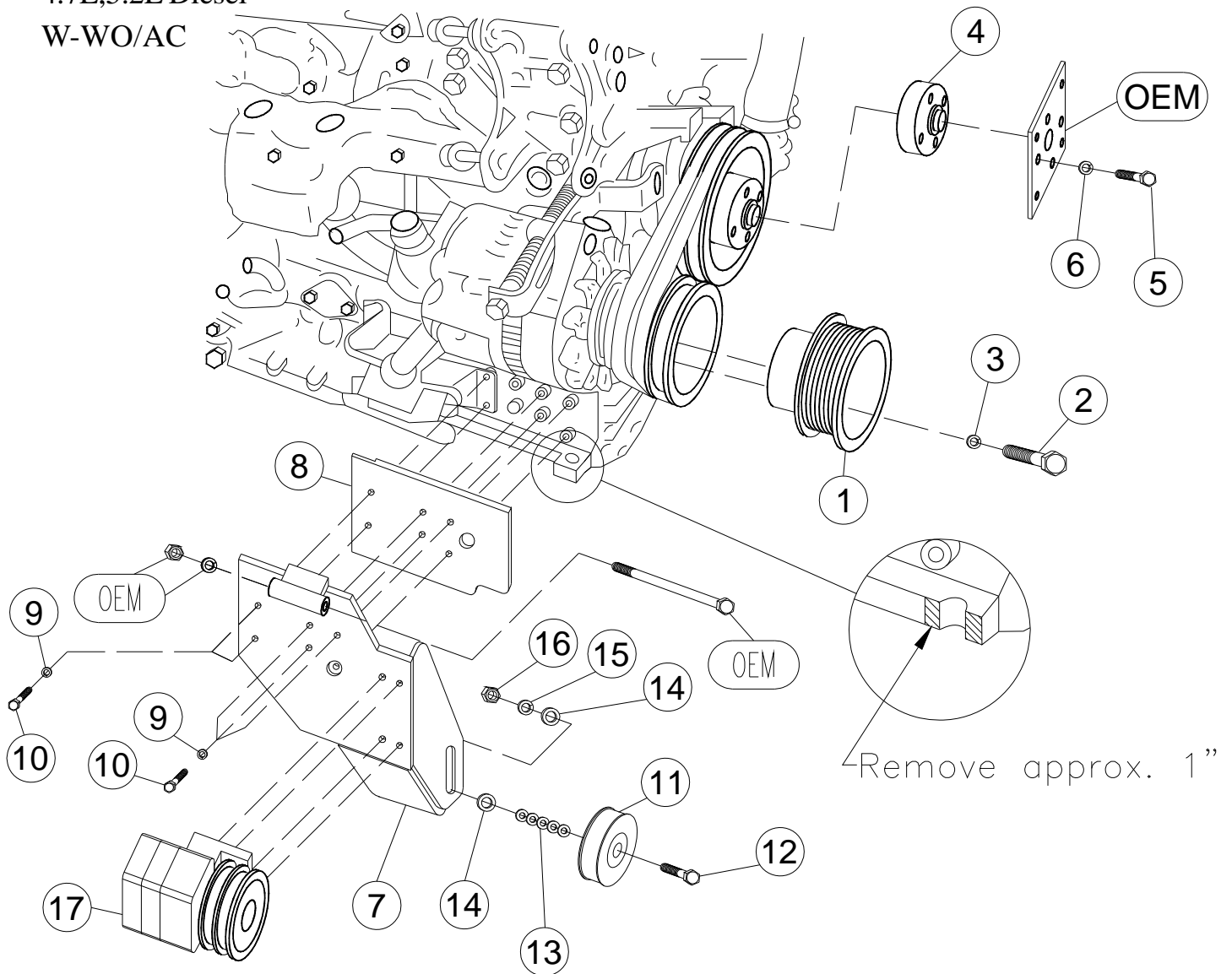

PARTS LIST

- | | |
|--------------------------|---|
| 1. SPC 332 (1) | 13. IPW 14 (5) |
| 2. 16mm x 80 mm 1.5 (4) | 14. IPW 10 (2) |
| 3. 16mm LW (4) | 15. 5/8 LW (1) |
| 4. FSO 4.7 (1) | 16. 5/8 NC (1) |
| 5. 8mm x 35mm 10.9 (4) | 17. Clutch Pump Assembly
(Sold Separately) |
| 6. 8mm LW (4) | 18. 8 x 45mm (2) (Not Shown) |
| 7. SMP 33(0-4) (1) | 19. 8mm FW (2) (Not Shown) |
| 8. SPS 33 (1) | 20. SP64-0.500 (2) (Not Shown) |
| 9. 10mm LW (6) | 21. Nylon Strap (1) (Not Shown) |
| 10. 10mm x 40mm 10.9 (6) | 22. A40F Goodyear (2) (Not Shown)
(#2 A39F, #4 A38F) |
| 11. IPCD (1) | |
| 12. 5/8 x 3 NC (1) | |

NOTE: With 7" clutch #2 A40F, #4 A39F.