



CW MILL EQUIPMENT CO., INC.  
P.O. Box 246 • Sabetha, Kansas 66534  
(785) 284-3454 • FAX (785) 284-3601

**VFK 35 -2 Belts**  
1988-96 Ford Van E-150,250,350  
WO/AC  
(Serpentine)

NOTE: MUST USE SIDE  
PORTED PUMP.

## INSTALLATION NOTES

1. Disconnect battery. Loosen clamps on flex hose at air cleaner intake, two large outlet hoses and small hose on top of air cleaner. Remove air cleaner assembly, metal support tray, and two large hoses to intake manifold.
2. Loosen serpentine belt, remove idler pulley assembly above power steering pump. Mark location of fan to water pump pulley, then remove fan. It is recommended to remove fan shroud for easier drive pulley (1) installation. Remove two clips from rubber splash guard and fold out of way.
3. Remove four bolts from crankshaft pulley and install drive pulley (1) with provided bolts (2) and lockwashers. **CAUTION:** Be sure bolts have same threads as O.E.M. bolts removed.
4. Remove nuts from studs at locations "C & D", discard dipstick brace. Install and tighten spacer nuts (13). With bolts (19) secure bracket (8) at location "D". Due to manifold variations, determine appropriate spacer (12) for location "C". Install bolt (17) and loosen bolts (19).
5. Remove bolts at locations "A & B", install bracket (10) with bolts and spacers as shown. tighten bolts at all locations.
6. Install clutch pump to pump plate with bolts provided. Align clutch pump to drive pulley (1) and tighten pump bolts.  
**CAUTION:** Check pump to shift linkage for adequate clearance.
7. Put fan and shroud back in plate, secure shroud. Install fan studs (5) and spacer (4) to water pump. Align marks from step 2, install and secure fan.
8. Remove O.E.M. idler pulley from aluminum bracket. Install idler with spacer (9) and bolt (29) at location "E". Install and tension serpentine belt.
9. Fasten belt tensioner assembly to bracket (10), determine proper amount of shim washers (26), secure bolt (25) with Loctite. Install and tension pump drive belts. Tighten set screw (20) against eccentric (24).
10. Install rubber splash guard. Reassemble air intake hoses, air cleaner tray, and air cleaner. Secure dipstick tube to bracket (8). Connect battery. **NOTE:** It may be necessary to slightly raise air intake hoses for clearance with clutch pump.

**CAUTION:** Check all engine compartment hoses and wiring to insure they are not kinked, touching any high temperature item, or do not interfere with any linkage components. Be sure pump and hoses will not contact shift linkage.

**NOTE:** Due to O.E.M. assembly tolerances, visually make certain that there is adequate clearance between fan & drive pulley, and also fan to radiator. It may be necessary to use a longer spacer for pulley clearance. If there is little clearance to the radiator - **provide adequate clearance between fan & radiator before operating.**

# VFK 35 -2 Belts

1988-96 Ford Van E-150,250,350

WO/AC

(Serpentine)

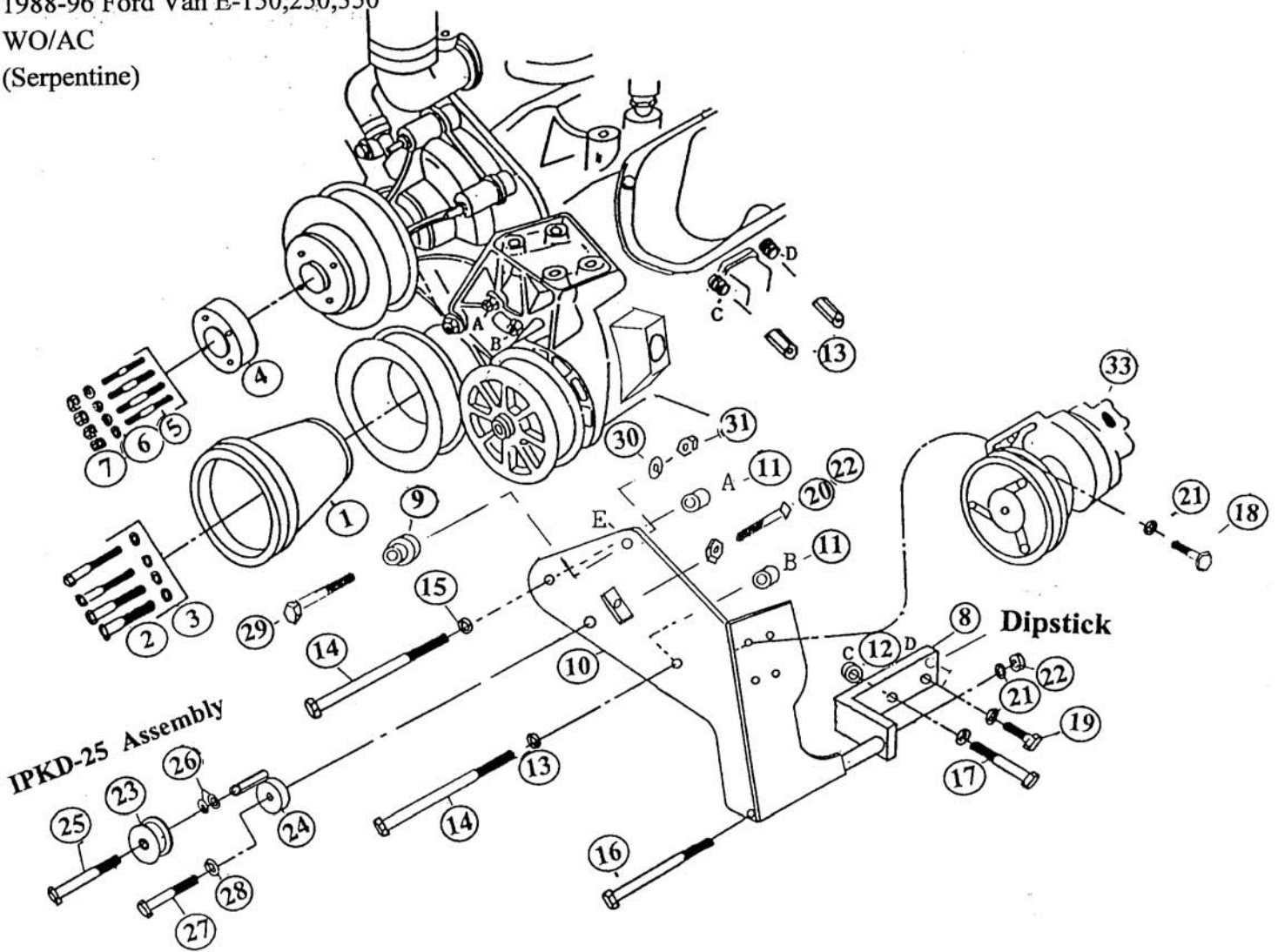

## PARTSLIST

- |                             |   |
|-----------------------------|---|
| 1. FPC 342 (1)              | 18. 3/8 X 1 1/4 NC (4)                        |
| 2. 3/8 X 1 3/4 NC (4)       | 19. 3/8 X 1 NC (2)                            |
| 3. 3/8 LW (4)               | 20. 3/8 X 1 1/2 Sq. (1)                       |
| 4. FSO 509 (1)              | 21. 3/8 LW (8)                                |
| 5. 5/16 X 2 1/2 ST (4)      | 22. 3/8 NC (3)                                |
| 6. 5/16 LW (4)              | 23. IPKD (1)                                  |
| 7. 5/16 NC (4)              | 24. Eccentric (1)                             |
| 8. VFB 351 (1)              | 25. 5/8 X 2 1/2 NC (1)                        |
| 9. VFB 352 (1)              | 26. IPW 14 (5)                                |
| 10. VFP 351 (1)             | 27. 1/2 X 2 NC (1)                            |
| 11. SP88-0.750 (2)          | 28. 1/2 LW (1)                                |
| 12. SP88-0.375 or 0.500 (1) | 29. 10mm X 60mm 1.5 (1)                       |
| 13. SP3/8 X 1.750 NC (2)    | 30. 10mm LW (1)                               |
| 14. 7/16 X 7 1/2 NC (2)     | 31. 10mm 1.5 (1)                              |
| 15. 7/16 LW (2)             | 32. AX-60 (2) (Not Shown)(#2 AX-58, #4 AX-57) |
| 16. 3/8 X 5 1/2 NC (1)      | 33. Clutch Pump Assembly (1)                  |
| 17. 3/8 X 2 NC (1)          | (Sold Separately)                             |