



CW MILL EQUIPMENT CO., INC.
P.O. Box 246 • Sabetha, Kansas 66534
(785) 284-3454 • FAX (785) 284-3601

DMK 53SD508-I8
1994-'98 Dodge D-250,350
5.9 Cummins Diesel
With A/C only
With Intercooler

INSTALLATION NOTES

1. Disconnect the negative battery cables. Remove O.E.M. belt. Remove top alternator brace and discard. Remove bottom alternator bolt at location "B".
2. Install aux. A.C. bracket (1) with bolts (2,5,8), lockwashers (3,6,9), and nuts (4,7,10) in locations "A", "B", "C". Install aux. A.C. compressor (15) with bolts (16,17), nuts (18) and slide bushings (19). Install idler (11) with bushing (12), bolt (13), and flatwasher (14) in location "D". If belt tension is not sufficient, other idler hole locations may be used. Install new belt (20) according to belt diagram. Reconnect battery cable. Run engine and check for proper belt tracking and clearances.

DMK 53SD508-I8

1994-'98 Dodge, D-250, 350

5.9 Cummins Diesel

With A/C only

With Intercooler

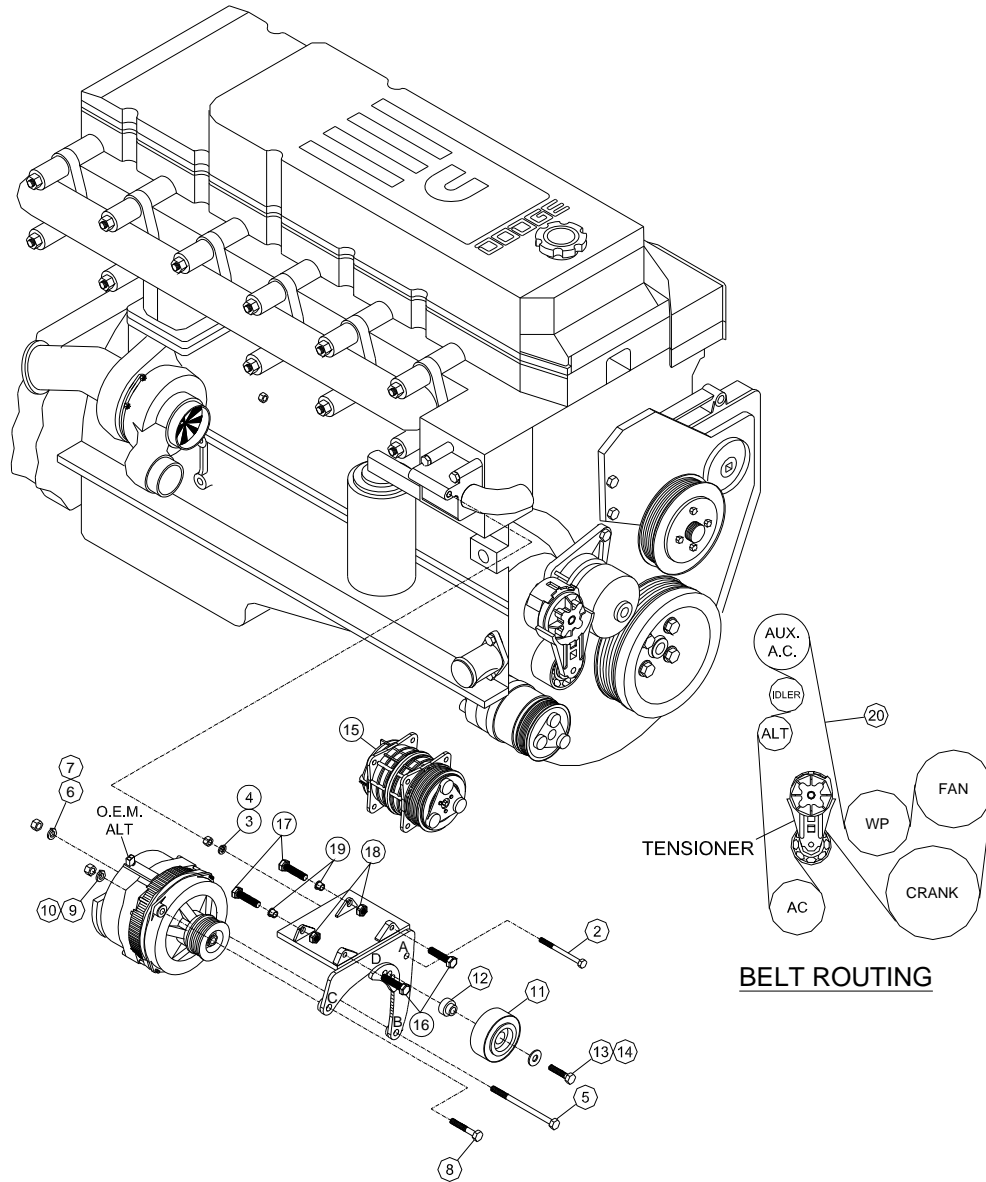

PARTS LIST

- | | |
|-----------------------------|--|
| 1. DMP 53SD508-I8 (1) | 11. TIPCS Idler (1) |
| 2. 5/16-18 x 4-3/4 Bolt (1) | 12. CMB 3867 Bushing (1) |
| 3. 5/16 FW (1) | 13. 10mm x 35mm Bolt (1) |
| 4. 5/16 Nut (1) | 14. 10mm FW (1) |
| 5. 10mm x 130mm Bolt (1) | 15. A.C. Compressor (<i>Sold Separately</i>) |
| 6. 10mm FW (1) | 16. 10mm x 30mm Flange (2) |
| 7. 10mm Nut (1) | 17. 10mm x 40mm Flange (2) |
| 8. 3/8-16 x 2 Bolt (1) | 18. 10mm Flange Nut (2) |
| 9. 3/8 LW (1) | 19. 1255-0090 Slide Bushing (2) |
| 10. 3/8 Nut (1) | 20. Dayco Belt # 5081035 |