

INSTALLATION NOTES

1. The buyer is responsible for providing trained and experienced installation decision making with technical know-how to apply professional judgment that specifically applies to each individual installation.
2. Be sure to read and understand all available information including but not limited to instructions, warnings, sale terms, and warranties for the vehicle and all system components prior to attempting installation.
3. Disconnect both battery cables.
4. Remove fan clutch wire and bracket from engine. Remove OEM belt. Disconnect alternator wires and lay aside. Remove both OEM alternators. Remove OEM alternator bracket and bolts. The bolts will not be reused.
5. Install main bracket (1) with bolts (3) and lock washers (4) onto the engine block (make sure to install bolt into bracket hole closest to water pump before installing bracket).
6. Install wire extension (14) to OEM main alternator wire with hardware (16-17) and heat shrink (15). Install OEM main alternator with OEM bolt (8) and bolt (9) onto main bracket (1). Install the two smooth idler pulley assemblies (5-7) onto main bracket (1) (install in hole furthest from the water pump). Install OEM secondary alternator with bolts (10) onto main bracket (1) (make sure wire harness is placed between the two mounting holes). Cut the back-driver's side ear of the auxiliary A/C compressor for clearance to the coolant tank (see photos below). Install the auxiliary A/C compressor assembly onto main bracket (1) according to the manufacturer's specifications with provided mounting hardware (11-13). Install wires to both alternators.
7. Install belt (18). Reinstall fan wire and OEM wire bracket.
8. Reconnect battery cables.

CAUTION: Before starting the engine, check to make certain no wires, hoses, etc. that may have been disturbed during installation do not come in contact with any hot or moving parts. Properly refill any fluids that may have been drained, check for leaks. Run the engine and check for proper belt tracking and clearance of any hoses, wires, etc. It is the installer's responsibility to correct/adjust any components, if necessary, before the vehicle is put into service.

FMK242SD508-I6DAMD

2023-2024 Ford F-650-F-750
 7.3L V8 Gas w/-w/o A/C, w/ OEM Dual Alternators

For use w/ TM13, TM15 or TM16 Ear-Mount Compressor
 Requires 6 or 8-Groove, 119mm Diameter Clutch

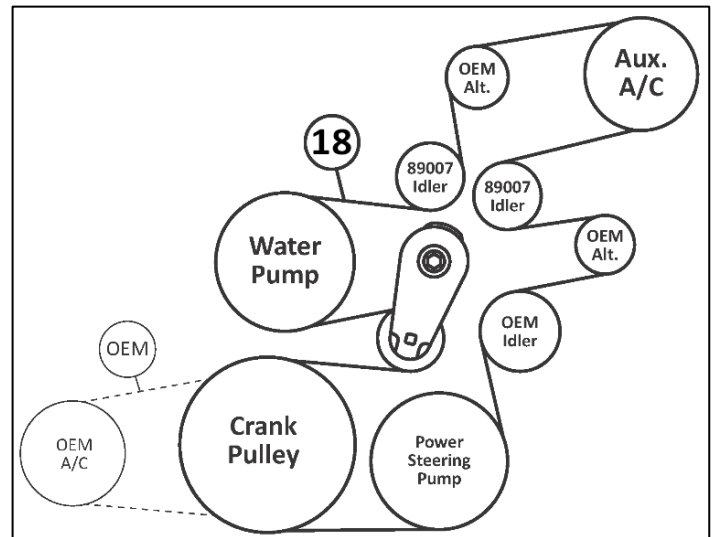
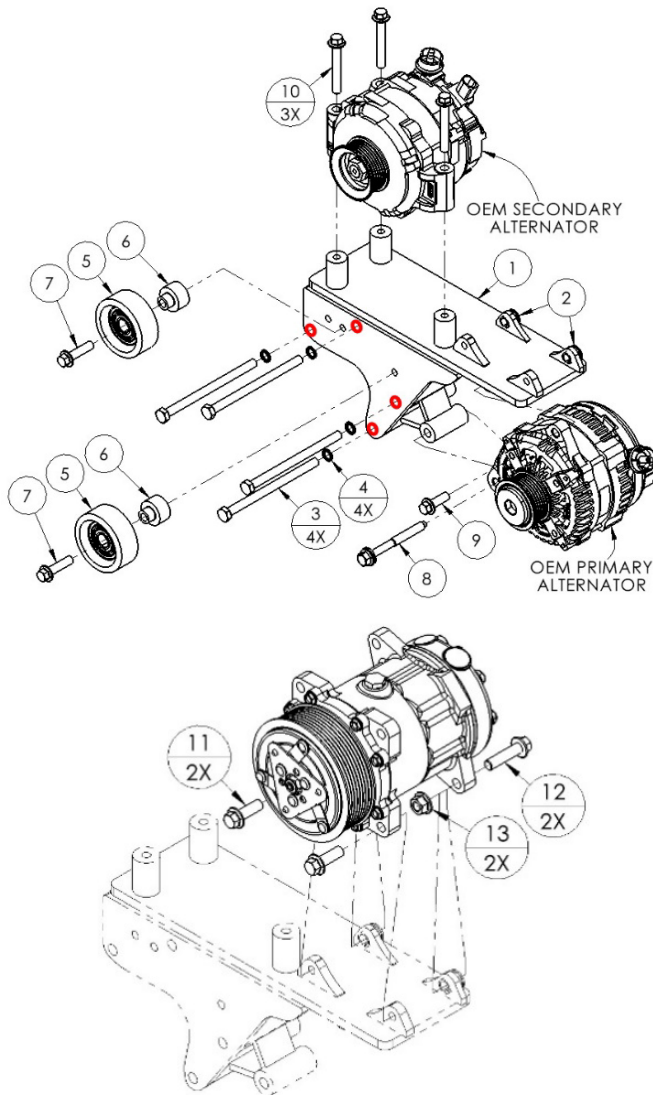

PARTS LIST							
Item	Part Number	Description	Qty.	Item	Part Number	Description	Qty.
Main Bracket				OEM Secondary Alternator Mounting Hardware			
1	FMB242SD508-I6	Main Bracket	1	10	1016343	M10-1.5 x 70mm 10.9Gr Hex Flg. Bolt	3
2	1011888A	M14 Slide Bushing (Installed)	2	Auxiliary A/C Compressor Mounting Hardware			
Main Bracket Mounting Hardware				11	1006927	M10-1.5 x 30mm 10.9Gr Hex Flg. Bolt	2
3	1005275	M10-1.5 x 150mm 10.9Gr Hex Bolt	4	12	1006933	M10-1.5 x 40mm 10.9Gr Hex Flg. Bolt	2
4	1003822	M10-1.5 Lock Washer	4	13	1018204	M10-1.5 10.9Gr Hex Flg. Nut	2
Smooth Idler Pulley Assembly (2x)				Wire Extension (Not Shown)			
5	89007	Dayco Smooth Idler Pulley	2	14	FMB241WE	Wire Extension	1
6	FMB241-1	Machined Idler Bushing	2	15	1005393	Heat Shrink	3"
7	1006933	M10-1.5 x 40mm 10.9Gr Hex Flg. Bolt	2	16	1011623	M8-1.25 x 12mm 10.9Gr Hex Flg. Bolt	1
OEM Main Alternator Mounting Hardware				17	1013333	M8-1.25 10.9Gr Hex Flg. Nut	1
8	N/A	OEM M10-1.5 x 90mm Bolt	1	Belt			
9	1006927	M10-1.5 x 30mm 10.9Gr Hex Flg. Bolt	1	18	5061150	Dayco 6-Groove, 115.0" Belt	1



CW Mill Equipment Co., Inc.

14 Commerce Drive Sabetha, KS 66534

Phone: (785) 284-3454

Fax: (785) 284-3601

Email: brackets@cwmill.com

Website: www.cwkits.com

FMK242SD508-I6DAMD

2023-2024 Ford F-650-F-750

7.3L V8 Gas w/-w/o A/C, w/ OEM Dual Alternators

For use w/ TM13, TM15 or TM16 Ear-Mount Compressor
Requires 6 or 8-Groove, 119mm Diameter Clutch

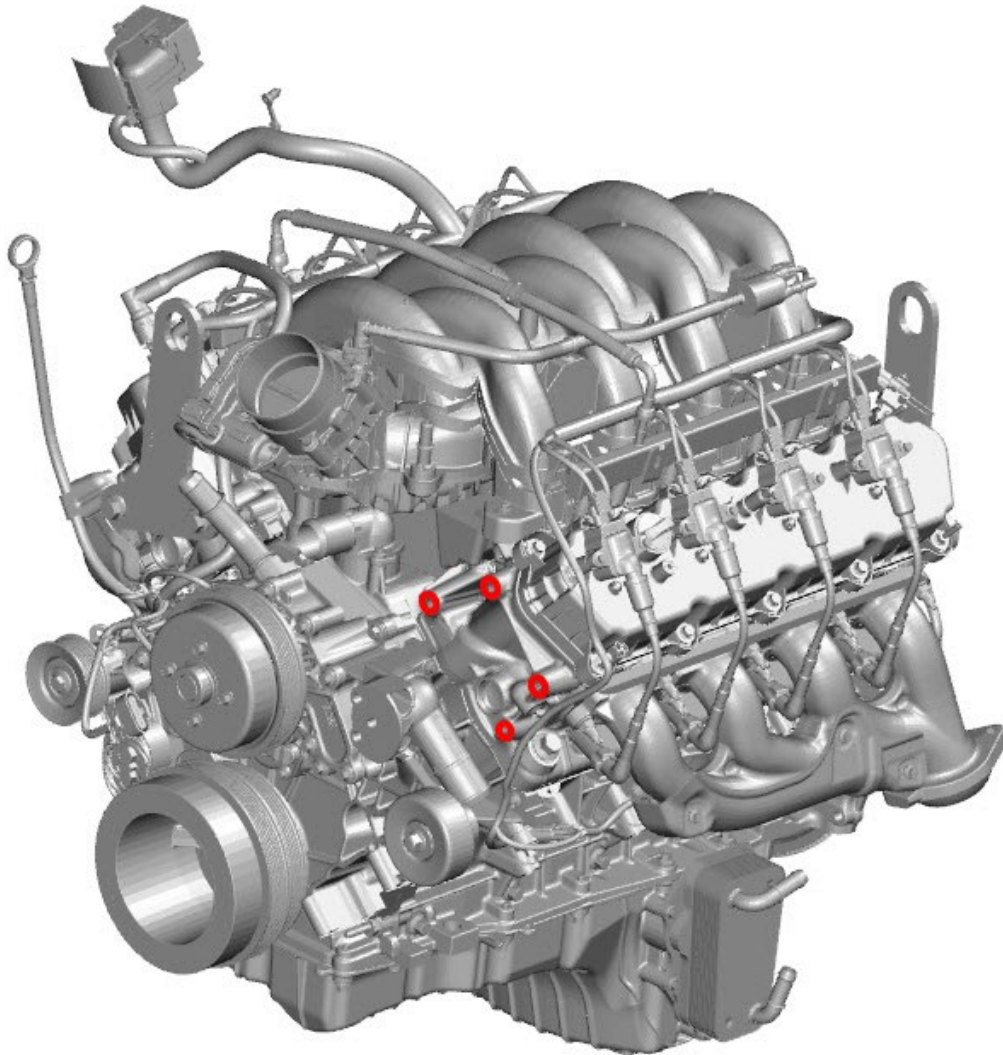

Main Bracket Mounting Location

