



CW MILL EQUIPMENT CO., INC.  
P.O. Box 246 • Sabetha, Kansas 66534  
(785) 284-3454 • FAX (785) 284-3601

**CMK 51 — 2 Belts**  
**1986-89 CHEVY C-60,70**  
**366,427 WO/AC**

## INSTALLATION NOTES

---

1. Disconnect battery terminal, drain radiator. Mark fan hub to water pump pulley for proper re-installation, loosen fan nuts. Loosen three small bolts on A.I.R. pump pulley. Loosen engine belts. Remove fan, shroud and radiator.
2. Remove six bolts from crankshaft pulley. Install drive pulley (1) with bolts (2), tighten bolts.
3. Remove fuel line brace, drill upper hole to 7/16" as shown. Remove pulley from A.I.R. pump and bolts at locations "A-D". Install brackets (8,9,10, & 11) with spacers and bolts as shown. Secure bolts at locations "C-F" and fuel line brace.
4. Install clutch pump to plate (11), align clutch pump pulley to drive pulley (1). Tighten pump bolts.
5. Replace original fan studs with studs (5). Install fan and spacer (4), align marks from step 1, secure fan.
6. Tighten original engine belts. Install and tension clutch pump belts (25). Secure plastic wire conduit to rear of bracket (9) with spacer (12) and bolts (20), if necessary.
7. Install shroud and radiator. Adjust radiator as far forward, away from fan, as possible. Secure radiator and shroud, refill radiator.

**IMPORTANT:** Clearance between fan clutch and radiator is minimal. Under normal conditions this clearance should not change, chassis flex encountered while driving through ditch could reduce clearance. It is recommended to provide as much clearance as possible by moving radiator ahead and/or shortening fan spacer if possible.

**CAUTION:** Check all engine compartment vacuum hoses and electrical wiring that might have been disturbed or re-routed during kit installation to be sure that hoses are not kinked, that they do not touch any high temperature items, and that they do not interfere with any linkage components.

# CMK 51- 2 Belts

1986-89 CHEVY Truck C-60,70

366,427 WO/AC

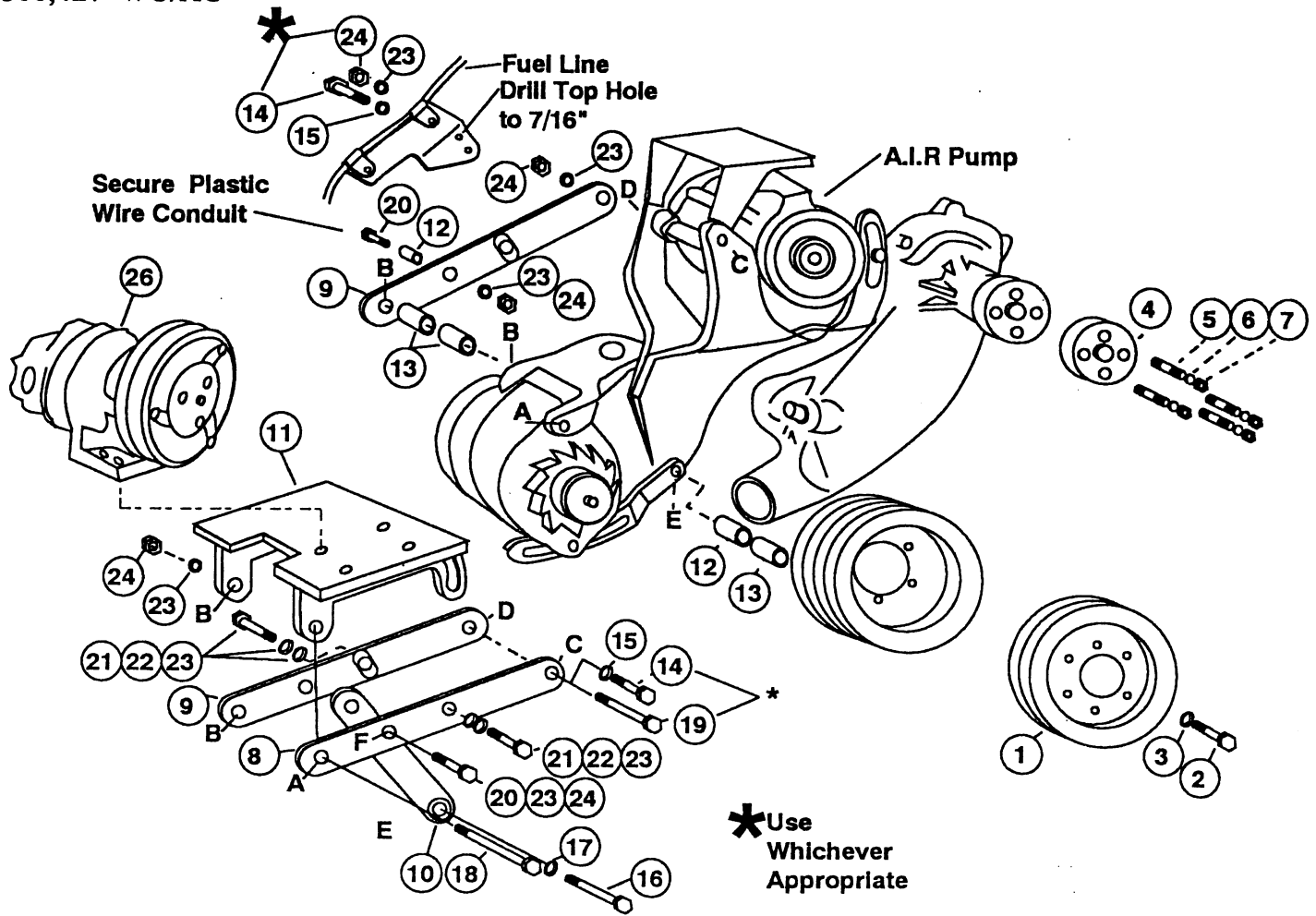

## PARTS LIST

- |                             |  |
|-----------------------------|--|
| 1. CPC 512 (1)              | 14. 10mm X 45mm 1.5 (2)                      |
| 2. 5/16 X 2-3/4 NC Gr 8 (6) | 15. 10mm LW (2)                              |
| 3. 5/16 LW (6)              | 16. 7/16 X 5 NC (1)                          |
| 4. FSO 613 (1)              | 17. 7/16 LW (1)                              |
| 5. 3/8 X 2-3/4 NF ST (4)    | 18. 3/8 X 7 NC (1)                           |
| 6. 3/8 LW (4)               | 19. 3/8 X 6 NC (1)                           |
| 7. 3/8 NF (4)               | 20. 3/8 X 1-3/4 NC (2)                       |
| 8. CMB 510 (W/spacer) (1)   | 21. 3/8 X 1-1/4 NC(2)                        |
| 9. CMB 511 (WO/spacer) (1)  | 22. 3/8 FW (3)                               |
| 10. CMB 512 (Brace) (1)     | 23. 3/8 LW (7)                               |
| 11. CMP 51 (0-4) (1)        | 24. 3/8 NC (5)                               |
| 12. SP88-0.750 (2)          | 25. *AX-64 (2) (Not Shown)#2-AX-63, #4-AX-62 |
| 13. SP88-0.500 (3)          | 26. Clutch Pump Assembly (1)                 |
|                             | (Sold Separately)                            |

\*NOTE: With 7" Clutch #2-AX-64, #4-AX-63.