



CW MILL EQUIPMENT CO., INC.
P.O. Box 246 • Sabetha, Kansas 66534
(785) 284-3454 • FAX (785) 284-3601

CMK 75-8

2004-09 CHEVY

C6500 - C8500 Truck

7.8L Duramax, 6 Cyl

W-W/O AC, W-W/O Air Brakes

NOTE: MUST USE SIDE PORTED PUMP.

INSTALLATION NOTES

1. Remove OEM belt. Remove fan, fan shroud, fan pulley, fan bearing assembly, and OEM fan assembly bracket. *Fan nut has left hand threads.* Install drive pulley (1) with bolts (2) and lockwashers (3).

NOTE: On trucks with a coolant line running through the fan hub bracket, the hose rerouting kit will need to be used. Drain the engine coolant. Remove the steel tube and threaded adapter from the engine just below the upper radiator hose. Using thread sealant, install adapter (23) and hose nipple (24) into the cylinder head where the adapter was removed. Tighten securely. Remove the bolt holding the hose to the fan hub bracket on the passenger side of the engine. Install hose (25) onto adapter (20) using one of the OEM hose clamps, then install the hose and adapter to the back of bracket (4) with bolt and lockwasher (21) & (22) at location "G". Once bracket (4) is installed, connect the hose on the passenger side of the engine to adapter (20) using the OEM bolt and fiber washers, and the hose on the drivers side to the fitting in the cylinder head using the other clamp. Route the hose so there are not kinks in it to slow down or cut off the coolant supply.

2. Install pump mounting bracket (4) with bolts (5), lockwashers (6) in locations "A", "B", and "C", bolt (7) with lockwasher (3) in location "D", and bolt (8) with lockwasher (3) in location "E".
3. Install OEM fan bearing assembly and fan pulley using OEM bolts. Remove ground strap bolt from location "F". Install brace (9) with bolts (10), lockwashers (3), and flatwashers (11). Reinstall ground strap with bolt (12), lockwasher (14) and flatwasher (13) at location "F". Start all bolts before tightening. Install fan spacer (17). Reinstall OEM belt. Install tensioner (15) with bolt (16). Install clutch pump with bolts provided. Align clutch with drive pulley (1). Tighten bolts securely. Install fan and fan shroud. Install belt (26) according to belt diagram.

CAUTION: Check all engine compartment hoses and electrical wiring that may have been disturbed or rerouted during kit installation to be sure that hoses are not kinked, that they do not touch any high temperature items, and that they do not interfere with any linkage components.

CMK 75-8
2004-09 Chevy
C6500 & C7500 Truck
7.8L Duramax, 6 Cyl
W-W/O AC, W-W/O Air Brakes

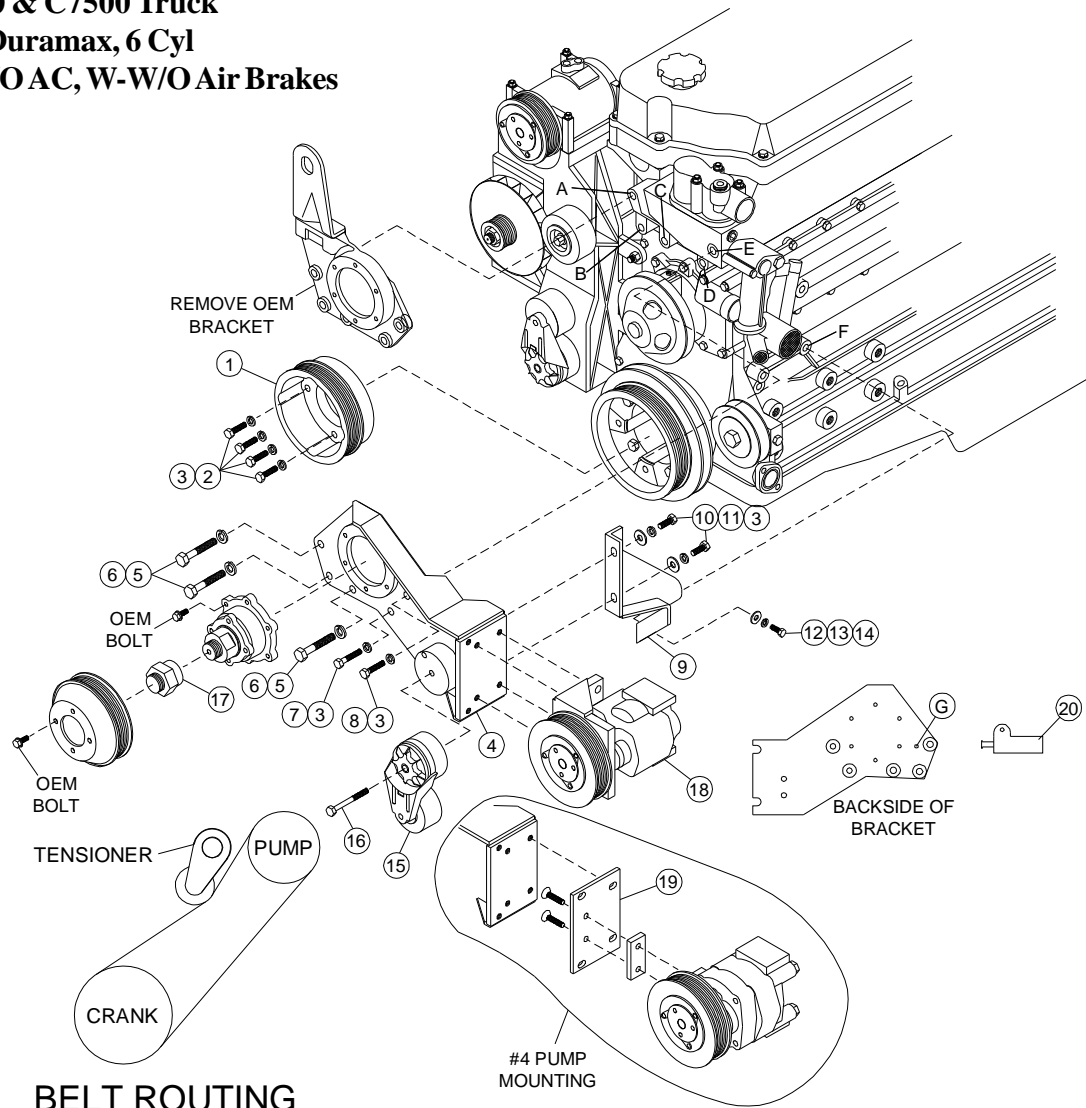

BELT ROUTING

PARTS LIST

- | | |
|--------------------------|--|
| 1. CPC 758 (1) | 16. 10mm x 80mm 10.9(1) |
| 2. 10mm x 30mm 10.9 (4) | 17. FSK 52 (1) |
| 3. 10mm LW (8) | 18. Clutch Pump Assy. (1)
(Sold Separately) |
| 4. CMP 75 (0-4) (1) | 19. CPA 754 (1) |
| 5. 12mm x 55mm 10.9 (3) | 20. CMB 752 (1) |
| 6. 12mm LW (3) | 21. 1/4 x 3/4 NC (<i>Not Shown</i>) |
| 7. 10mm x 45mm 10.9 (1) | 22. 1/4 LW (<i>Not Shown</i>) |
| 8. 10mm x 55mm 10.9 (1) | 23. 5406-12-8 Thompkins (1) (<i>Not Shown</i>) |
| 9. CMB 751 (1) | 24. 4404-8-8 Thompkins (1) (<i>Not Shown</i>) |
| 10. 10mm x 25mm 10.9 (2) | 25. 1/2 coolant hose (<i>Not Shown</i>) |
| 11. 10mm FW (2) | 26. 5080545 Dayco Belt (1) |
| 12. 8mm x 25mm 10.9 (1) | |
| 13. 8mm FW (1) | |
| 14. 8mm LW (1) | |
| 15. 89200B Tensioner (1) | |

Note: With 6" clutch use 5080550 Dayco belt.