



CW MILL EQUIPMENT CO., INC.  
P.O. Box 246 • Sabetha, Kansas 66534  
(785) 284-3454 • FAX (785) 284-3601

## **IMK 49L3S-I8 Belt**

2005-07 International  
4300-4400  
DT466, 530  
W-/AC

### **INSTALLATION NOTES**

---

1. Disconnect the negative battery cable. Remove the passenger side inner fender. Remove the turbo cooler tube. Remove the accessory drive belt. Disconnect the alternator wires and remove the alternator and the alternator bracket. The alternator and alternator bracket bolts will be reused.
2. Install bracket (1) onto the engine at the OEM alternator bracket location reusing the OEM bolts. Torque the 10mm bolts to 40-45 ft/lbs, and the 8mm bolts to 25-28 ft/lbs. Install the alternator (7) onto the new bracket (1) in lower location as shown in the illustration using bolt (8), spacer (22), LW (10), and nut (21). Torque the bolts to 35 ft/lbs. Install aux. alt. (7) in upper location using bolt (8), spacer (22), LW (10), and nut (21). Install brace (11) and brace (9) w/OEM A/C bolts, bolt (14), LW (13), and FW (12) placing brace (9) underneath brace (11). Install bolt (15), LW (13), and FW (12) through brace (9) into lower alternator, raise both alternators to desired location and tighten bolts (14,15,8).
3. Install idler (3) onto the bracket with bushing (2), flatwasher (4), and bolt (5). Install in lowest location. Tighten securely. Install the new belt (16) onto the engine according to the belt diagram. If belt (16) is too short idler (3) can be raised to the next hole.
4. Reconnect the alternator wires. Remove the steel band from the 3-1/2" end of the cooler tube, being careful not to damage the rubber coupler as it will be reused. Install the 3-1/2" OEM rubber coupler onto the end of the new tube (17), and the 3" 45° elbow (18) onto the other end. Install the two hose clamps (20) onto the 45° elbow and clamp (19) along with the OEM clamp onto the straight OEM coupler. Do not tighten. Install the cooler tube assembly onto the engine and position it for the best fit and clearance. then tighten the hose clamps securely. Install the inner fender and reconnect the battery cable.
5. Check that hose(s) and wire(s) have clearance from hot or moving parts. Run the engine to make sure the belt tracks properly and tension is correct.

**IMK 49L3S-I8**  
**2005-07 International**  
**4300-4400**  
**DT466, 530**  
**W/AC**

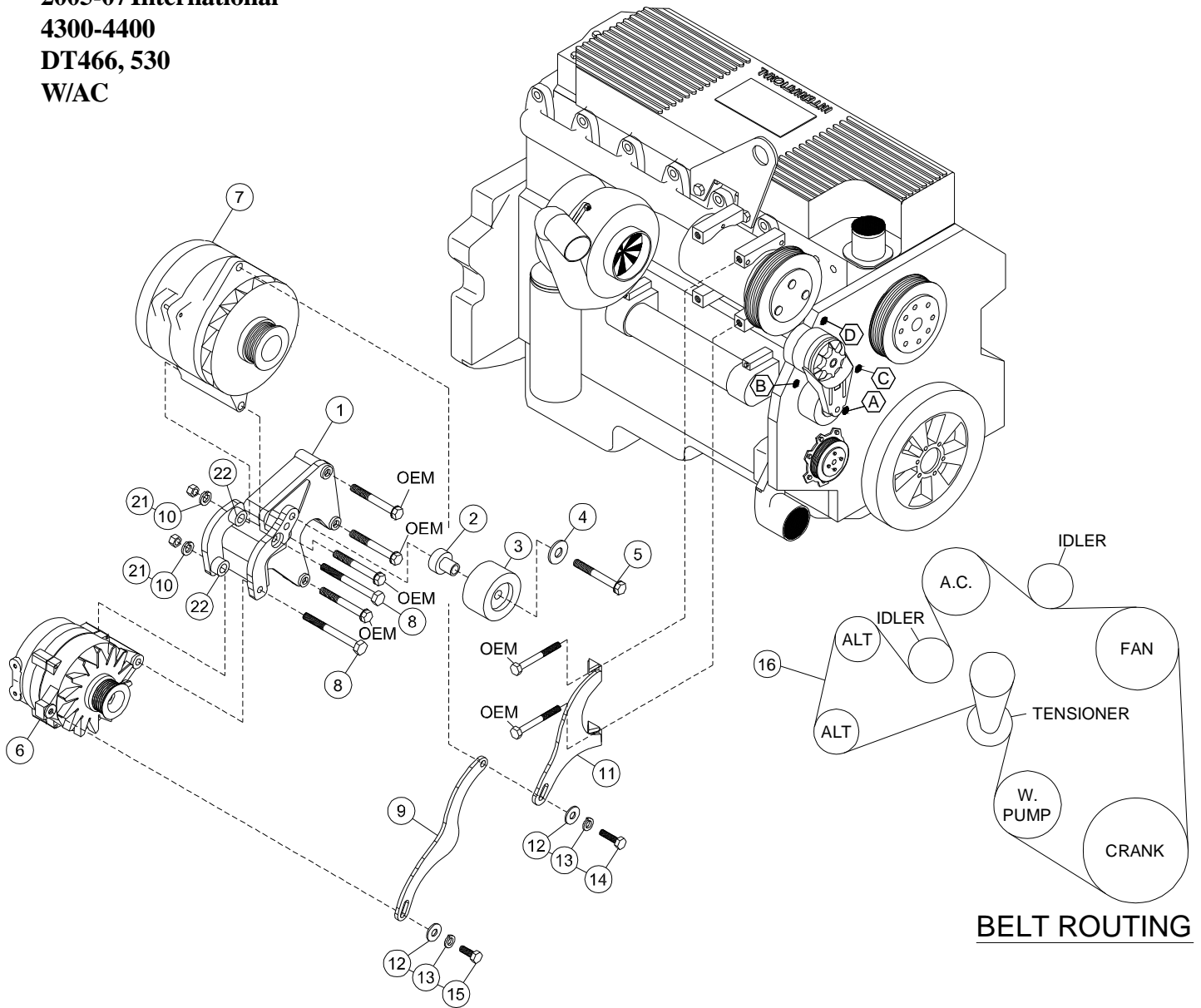

**PARTS LIST**

- |                                             |                             |
|---------------------------------------------|-----------------------------|
| 1. IMB 49L3S (1)                            | 11. IMB492L3S (1)           |
| 2. IMB 491 (1)                              | 12. 3/8 FW (2)              |
| 3. IPCD 2.75 (1)                            | 13. 3/8 LW (2)              |
| 4. 12mm FW (1)                              | 14. 3/8 x 1-1/2 (1)         |
| 5. 12mm x 55mm (1)                          | 15. 3/8 x 1-1/4 (1)         |
| 6. Aux. Alternator (1)<br>(Sold Separately) | 16. Belt Dayco 5081045 (1)  |
| 7. Main Alternator (1)<br>(Sold Separately) | 17. ST39035 Steel Tube (1)  |
| 8. 7/16 x 3-1/2 (2)                         | 18. TP1487000 45° Elbow (1) |
| 9. IMB491L3S (1)                            | 19. 250-92 Clamp (1)        |
| 10. 7/16 LW (2)                             | 20. 250-87 Clamp (2)        |
|                                             | 21. 7/16 NC (2)             |
|                                             | 22. SP88-.500               |