

INSTALLATION NOTES

1. Disconnect the negative battery cables. Remove the lifting lug from the front of the cylinder head. Remove the three bolts holding the fan shroud ring to the engine. Push the aluminum ring forward. Be careful not to damage the radiator. Remove the eight bolts holding the fan to the fan clutch.
2. Install the drive pulley(1) onto the engine crank pulley with bolts(2), torque to 12ft lbs. Install idlers(11) using bolts(13,16), flat washers(12,15), and bushings(10,14). Install pump onto bracket(3) using bolts(20), lock washers(21) and pump spacer(22). Install bracket(3) using bolts(4,6,8) and lock washers(5,7,9). Loosen bolts(20) and align the clutch with the drive pulley using a quality straight edge. **NOTE: Belt alignment is the installer's responsibility.** Install tensioner(17) using bolt(18). Install the drive belt(23) as shown in the diagram on the back. Install the fan spacer(19) and fan using bolts(2). Reinstall the fan shroud ring reusing OEM hardware.
3. Reconnect the negative battery cable. Run engine and check for proper belt tracking and clearance of all moving parts.

**MMK31-8 / 2017-2019 MITSUBISHI FUSO / FE & FG Series/CANTER / 3.0L I4 DIESEL
FOR USE W-WO AC / REQUIRES 8 GROOVE CLUTCH**

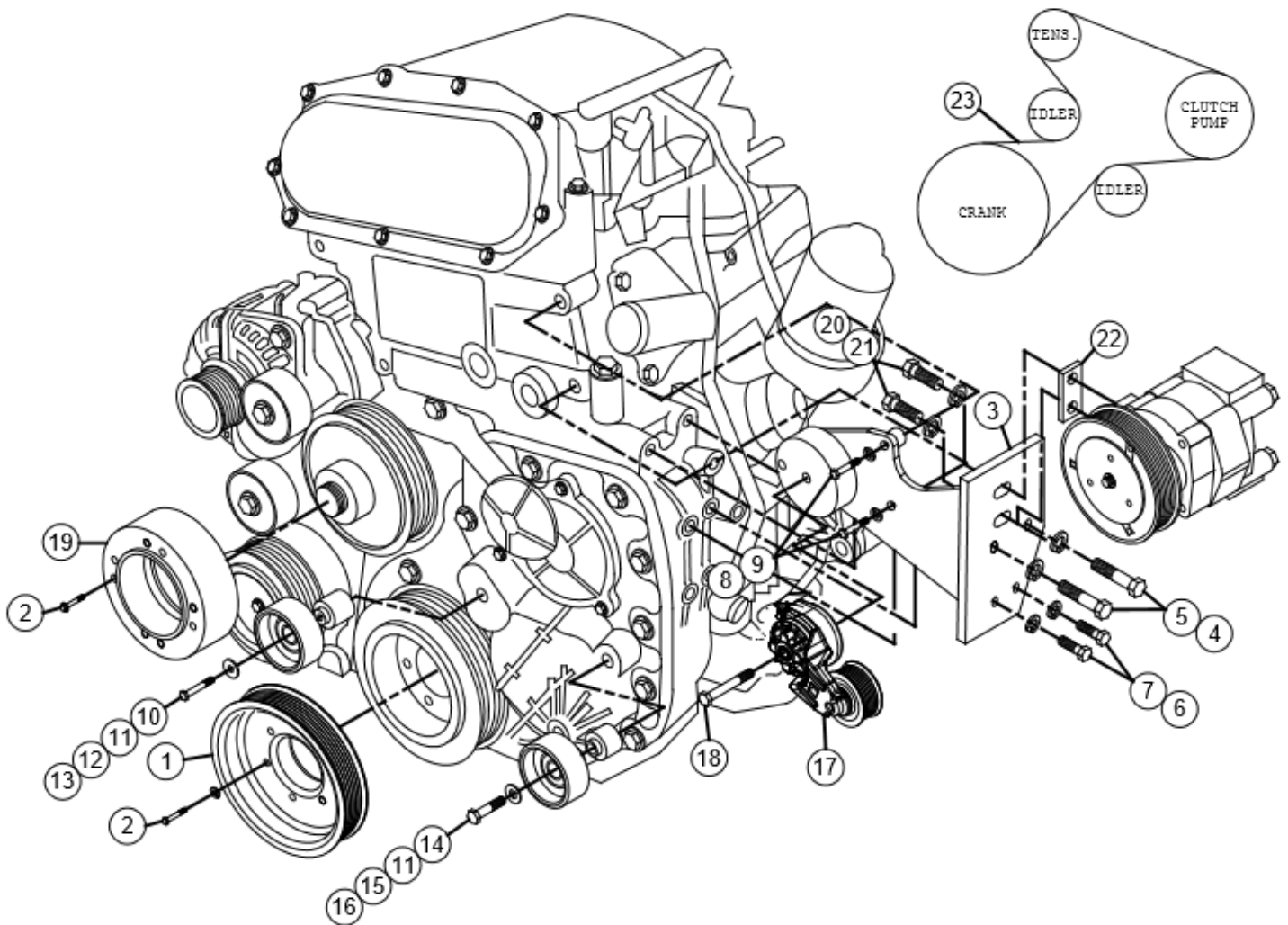

PARTS LIST

- | | |
|--------------------------|-------------------------------|
| 1. MPC318 (1) | 12. FMB483-I6 |
| 2. 6mm x 60mm flg(14) | 13. 8mm x 70mm (1) |
| 3. MMP304-8 (1) | 14. MMB311 (1) |
| 4. 12mm x 65mm x1.25(2) | 15. 3/8 FW (1) |
| 5. 12mm LW (2) | 16. 10mm x 70mm (1) |
| 6. 10mm x 35mm x1.25 (2) | 17. 89200D-GPCD8 (1) |
| 7. 10mm LW (2) | 18. 10mm x 80mm (1) |
| 8. 8mm x 40mm (2) | 19. FS031 (1) |
| 9. 8mm LW (2) | 20. 1/2 x 1-3/4 (2) |
| 10. MMB312 (1) | 21. 1/2 LW (2) |
| 11. Dayco 89016 (2) | 22. 1006644 Pump Tab 1/4" (1) |
| | 23. Dayco 5080610 (1) |

Disclaimer: (1.) Due to the custom nature and variation of all add-on systems of this type, no complete system kits are offered by the manufacturer, and any group of parts marketed as a kit is limited to only the individually defined parts in that specific kit. The system designer's rotating accessory components are not included, offered, or fully known by the manufacturer. In addition to the absence of the rotating accessory system, other potential components such as additional clamps, brackets, wear liners, hardware, or other items that may be required by the system designer must be identified and supplied by the actual system designer. (2.) Due to vehicle manufacturer's assembly tolerances, production changes, and installation variances, it is the buyer's responsibility to insure adequate clearance for all components including space for and safe location of the fan, radiator, all lines, and wires. Check for possible movement, vibration, friction points, heat exposure and/or shifting of any and all components such as hoses, wires, and all other components including those that may otherwise be considered non-moving and/or unaffected by the installation. (3.) The buyer is responsible for the entire installation of a mounting kit as the mounting kit is part of a custom process controlled by the buyer through their whole system design and directed installer as the installer evaluates, locates, routes, aligns, and tightens all components while determining if additional clamps, brackets, wear-liners, or other components may be required, beyond those included in the kit. Any additional items required, beyond those included in the kit, are to be provided at the expense of the buyer. (4.) The buyer is responsible for the development and communication of their whole system installation procedures, safety precautions, application, and use of the engine accessory mounting kit in their system, including efforts to maintain vehicle control and prevent pinch, wear, impact, and/or burn exposure on all hoses, wires, and other parts. (5.) The buyer is responsible for providing trained and experienced installation decision making with technical know-how to apply professional judgment that specifically applies to each individual installation. The buyers chosen installers must be qualified and experienced technicians that are familiar with the vehicle and accessory being mounted as well as the buyer's whole system design and installation procedures associated with the kit. (6.) The buyer is responsible for determining and achieving compliance to all regulatory issues that apply to the use of all products. (7.) The manufacturer reserves the right to make changes and/or improvements to any product at any time with or without notice.