



## CMK69SD508-I6

2001-2010 C&K 2500HD-3500

2003-2010 C&K 3500HD

6.6L V8 Duramax Diesel w/-w/o AC, w/o Dual Alt.

Requires 6-Groove Clutch

For use w/ TM13 TM15 or TM16 Ear Mount Compressors

### INSTALLATION NOTES

---

1. The buyer is responsible for providing trained and experienced installation decision making with technical know-how to apply professional judgment that specifically applies to each individual installation.
2. Be sure to read and understand all available information including but not limited to instructions, warnings, sales terms, and warranties for the vehicle and all system components prior to attempting installation.
3. Disconnect the negative battery cable. Disconnect the wires to the module mounted on the fan shroud. Remove the module, fan shroud, and fan from the truck. (Fan nut has right hand threads). Remove the O.E.M. accessory drive belt.
4. Remove the four bolts holding the A/C compressor to the A/C bracket. Place the two spacers (4) under the A/C compressor at the two holes to the inside. Install bolts and flat washers (10 & 11) into those two holes loosely. Install the aux. A.C. compressor onto bracket (2) with bolts (15,16), nuts (17) and slide bushings (18). Install compressor and pump assembly (2) under the A/C compressor with bolts and flat washers (10 & 11) at locations "A & B", and bolts (7) with lock washers (12) at locations "C & D". Do Not Tighten.
5. Install the idler assembly on the backside of bracket using the bottom slot for 2001 model trucks, and the top slot for 2002 and later models. Do not tighten. Install the belt (14) around the A/C and clutch pump pulleys before installing bracket (1). Remove the three bolts holding the P/S pump plate to the aluminum bracket at locations "E, F & G". Install bracket (1) using bolts (7 & 8) with lock washers (12) and spacers (3). Tighten all bolts very lightly, and then tighten them securely.
6. Install the belt onto all the idlers and pulleys as shown in the diagram. Retract the tensioner and slide the idler (6) down until it takes up most of the belt slack, tighten the idler bolt and release the tensioner.
7. Replace the fan, shroud and module back onto the vehicle. Reconnect the module and the battery cable. Run the engine to make sure the belt tracks properly and nothing comes in contact with any moving parts. Adjust if necessary.

**NOTE:** This kit only requires one belt. The extra belt is to be placed in the vehicle for future use because this belt is not available over the counter.

**CAUTION:** Check all engine compartment vacuum hoses and electrical wiring that may have been disturbed or re-routed during kit installation to be sure that hoses are not kinked, that they do not touch any high temperature item, and that they do not interfere with any linkage components.



**CW Mill Equipment Co., Inc.**  
 14 Commerce Drive Sabetha, KS 66534  
 Phone: (785) 284-3454  
 Fax: (785) 284-3601  
 Email: brackets@cwmill.com  
 Website: [www.cwkits.com](http://www.cwkits.com)

# CMK69SD508-I6

2001-2010 C&K 2500HD-3500

2003-2010 C&K 3500HD

6.6L V8 Duramax Diesel w/-w/o AC, w/o Dual Alt.

Requires 6-Groove Clutch

For use w/ TM13 TM15 or TM16 Ear Mount Compressors

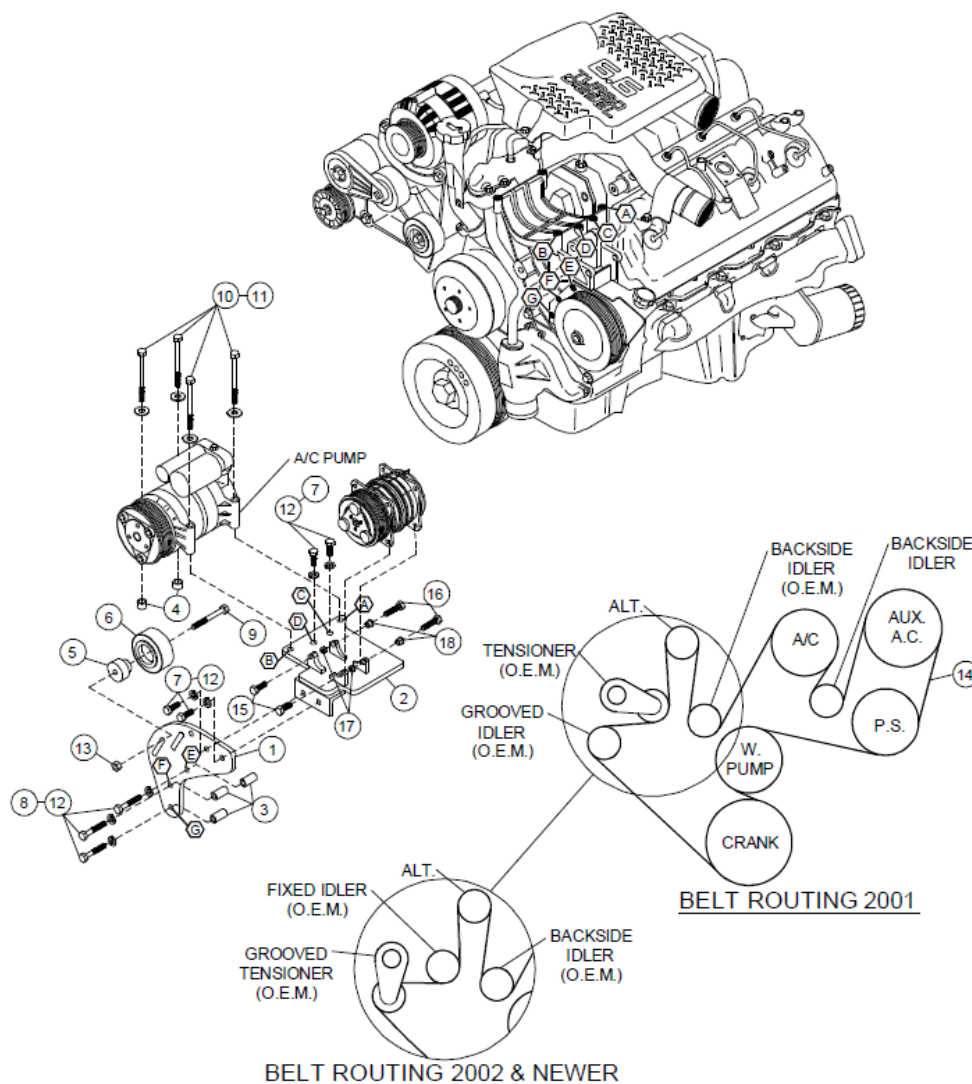

## PARTS LIST

- |  |                                 |
|--|---------------------------------|
| 1. CMB 691 (1)                             | 10. 10mm x 100mm (4)            |
| 2. CMP 68SD508 (1)                         | 11. 10mm FW (4)                 |
| 3. SP64-1.500 (3)                          | 12. 10mm LW (7)                 |
| 4. SP88-0.375 (2)                          | 13. 10mm Flange Nut (1)         |
| <i>(TIPKSC-68 Includes Items 5,6,9,13)</i> |                                 |
| 5. CMB 3867 (1)                            | 14. 5061380 (2)                 |
| 6. 89007 Dayco (1)                         | 15. 10mm x 30mm Flange Bolt (2) |
| 7. 10mm x 25mm 10.9 (4)                    | 16. 10mm x 40mm Flange Bolt (2) |
| 8. 10mm x 90mm 10.9 (3)                    | 17. 10mm Flange Nut (2)         |
| 9. 10mm x 50mm Flange Bolt (1)             | 18. 1255-0090 Slide Bushing (2) |



**CW Mill Equipment Co., Inc.**  
14 Commerce Drive Sabetha, KS 66534  
Phone: (785) 284-3454  
Fax: (785) 284-3601  
Email: [brackets@cwmill.com](mailto:brackets@cwmill.com)  
Website: [www.cwkits.com](http://www.cwkits.com)

## CMK69SD508-I6

2001-2010 C&K 2500HD-3500

2003-2010 C&K 3500HD

6.6L V8 Duramax Diesel w/-w/o AC, w/o Dual Alt.

Requires 6-Groove Clutch

For use w/ TM13 TM15 or TM16 Ear Mount Compressors

### NOTES

---

Disclaimer: (1.) Due to the custom nature and variation of all add-on systems of this type, no complete system kits are offered by the manufacturer, and any group of parts marketed as a kit is limited to only the individually defined parts in that specific kit. The system designer's rotating accessory components are not included, offered, or fully known by the manufacturer. In addition to the absence of the rotating accessory system, other potential components such as additional clamps, brackets, wear liners, hardware, or other items that may be required by the system designer must be identified and supplied by the actual system designer. (2.) Due to vehicle manufacturer's assembly tolerances, production changes, and installation variances, it is the buyer's responsibility to ensure adequate clearance for all components including space for and safe location of the fan, radiator, all lines, and wires. Check for possible movement, vibration, friction points, heat exposure and/or shifting of any and all components such as hoses, wires, and all other components including those that may otherwise be considered non-moving and/or unaffected by the installation (3.) The buyer is responsible for the entire installation of a mounting kit as the mounting kit is part of a custom process controlled by the buyer through their whole system design and directed installer as the installer evaluates, locates, routes, aligns, and tightens all components while determining if additional clamps, brackets, wear-liners, or other components may be required, beyond those included in the kit. Any additional items required, beyond those included in the kit, are to be provided at the expense of the buyer. (4.) The buyer is responsible for the development and communication of their whole system installation procedures, safety precautions, application, and use of the engine accessory mounting kit in their system, including efforts to maintain vehicle control and prevent pinch, wear, impact, and/or burn exposure on all hoses, wires, and other parts. (5.) The buyer is responsible for providing trained and experienced installation decision making with technical know-how to apply professional judgment that specifically applies to each individual installation. The buyers chosen installers must be qualified and experienced technicians that are familiar with the vehicle and accessory being mounted as well as the buyer's whole system design and installation procedures associated with the kit. (6.) The buyer is responsible for determining and achieving compliance to all regulatory issues that apply to the use of all products. (7.) The manufacturer reserves the right to make changes and/or improvements to any product at any time with or without notice.