



**CW MILL EQUIPMENT CO., INC.**  
P.O. Box 246 • Sabetha, Kansas 66534  
(785) 284-3454 • FAX (785) 284-3601

**CMK74L3S-I8**

**2004-2009**

**Chevy Kodiak 6500 & 7500**

**GMC Topkick 6500 & 7500**

**7.2L / I6 Diesel / CAT (C7) W/AC**

For use with 4 Bolt Alternator,

Requires 8 Groove Pulley

## **INSTALLATION NOTES**

1. Disconnect negative battery cable. Drain engine coolant. Remove coolant tube at the water pump outlet and from the overflow tank. Remove OEM belt. Remove OEM alternator.
2. Install fittings (21,22) at the water pump with the hose barb pointed forward and down to clear the radiator hose. Install new hose (23) using OEM hose clamps and odel clamps provided to secure the hose. Route the hose underneath the fan shroud and up to the overflow tank. (Note: do not route the hose above the overflow tank level.)
3. Remove OEM bolts from the passenger side frame rail at locations (B & C). Install radiator support rod bracket (24) with bolt (25), nut (4), and lockwasher (5) at location (A). Reuse OEM bolts in locations (B & C). (Note: Remember to reinstall ground cables at location (C)). Remove bolt from passenger side radiator support rod at location (D) and loosen the bolt at the other end of the rod. Rotate the support rod down to the new bracket reusing OEM bolt. Tighten both bolts securely.
4. Install the dual bearing idler assembly (18,19,20,8) at location (E). Install studs (3) into the alternator mounting bracket. Install the O.E.M.alternator onto the studs and secure it with nuts (4). Torque to 35 ft/lbs. Install bushings (2) and pump plate (1) onto the four alternator studs (3) as shown, securing with nuts (4) and lockwashers (5). Torque to 35 ft/lbs. Install aux. alt. w/bolts (14,11), bushing (17), slide (10), LW's (16,12) and FW (13). Tighten all bolts securely.
5. Install single bearing idler assembly (6, 7) with bolt (9) and flatwasher (8) in the highest hole possible at locations (C thru F) that will allow the new belt to be installed. Install belt (26) as shown in belt diagram. Refill engine with coolant and reconnect battery cable. Check for proper clearances to all moving parts. Run engine and check for proper tracking of the belt, and adjust if necessary.

**CMK74L3S-I8** - For use with 4 Bolt Alternator, Requires 8 Groove Pulley

2004-2009

Chevy Kodiak 6500 & 7500

GMC Topkick 6500 & 7500

CAT (C7) W/AC

7.2L / I6 Diesel

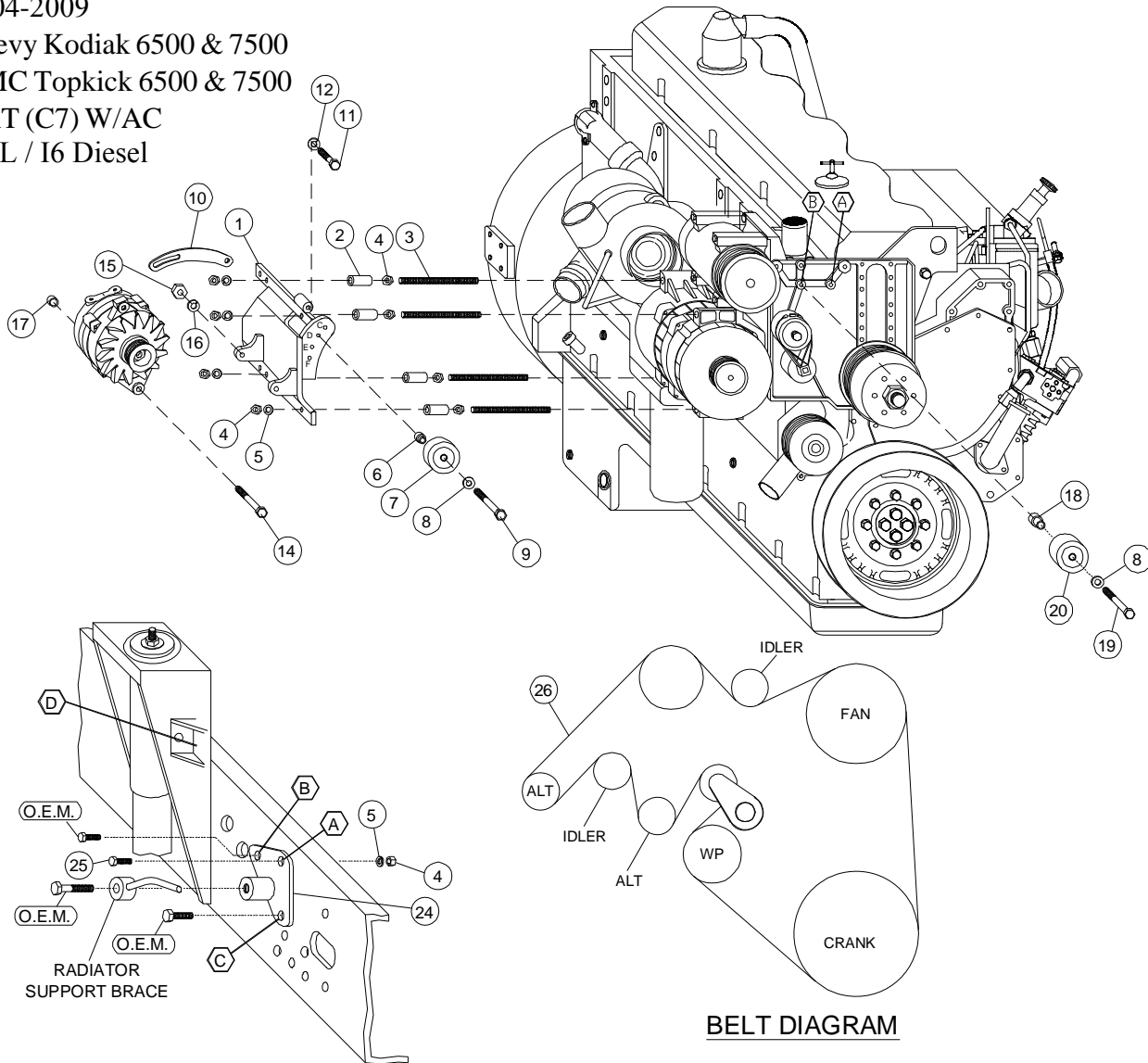

**PARTS LIST**

- |                          |                                |
|--------------------------|--------------------------------|
| 1. CMP 74 L3S (1)        | 14. 7/16 x 5-1/2 Bolt (1)      |
| 2. SP100-1.340 (4)       | 15. 7/16 Nut (1)               |
| 3. 10mm x 180mm Stud (4) | 16. 7/16 LW (1)                |
| 4. 10mm Nut (8)          | 17. SP88-0.500 (1)             |
| 5. 10mm LW (4)           | 18. CMB 741 (1)                |
| 6. CMB 672 (1)           | 19. 10mm x 60mm (1)            |
| 7. TIPCS (1)             | 20. IPCD 3.0 (1)               |
| 8. 3/8 FW (1)            | 21. 6410-10-12 Adapter (1)     |
| 9. 10mm x 55mm Bolt (1)  | 22. 4601-16-12 hose insert (1) |
| 10. CMB 741L3S (1)       | 23. 1" hose (1)                |
| 11. 3/8 x 1-1/2 Bolt (2) | 24. CMB 742                    |
| 12. 3/8 LW (2)           | 25. 10mm x 45mm (1)            |
| 13. 3/8 FW (1)           | 26. Belt Dayco 5080990 (1)     |