



CW MILL EQUIPMENT CO., INC.
P.O. Box 246 • Sabetha, Kansas 66534
(785) 284-3454 • FAX (785) 284-3601

FLMK91L3S-2
1999-2002 Freightliner FL 60-70
1999-2002 Sterling Acctera
7.2L I6 Diesel / CAT 3126
Requires a Dual-V Pulley,
w/-w/o A/C, w/-w/o Air Brakes

INSTALLATION NOTES

1. Disconnect negative battery cable. Drain the antifreeze from the radiator until the level is below the thermostat. Remove the upper radiator hose. Remove serpentine belt. Remove the four nuts holding the fan to the idler pulley and remove the fan from the vehicle. Screw a 3/8 bolt into the pilot on the front of the pulley until the pilot is removed from the pulley. Through the pilot hole in the front of the pulley, remove the bolt holding the pulley onto the fan idler hub. Remove the pulley. Remove the snap ring, the two bearings, the machined washer and the four studs from the O.E.M. pulley and install them in the new pulley (1) in the same way. Install the pulley back onto the hub and tighten, replace the pilot and the serpentine belt. Do not install the fan at this time.
2. Install the main bracket on the upper left side of the engine with the bolts (4) and LW's (5). Install plate (3) w/bolts (6,7), nuts (10), FW (9), and LW's (8). Do not tighten. Install aux. alternator w/bolts (11,15), spacer (12), LW's (12,16), and nut (14). *NOTE:* It will be necessary to trim the engine lifting lug. Install alternator belts and tension properly. Tighten bolts securely. Replace fan. Replace the upper radiator hose with the short end towards the radiator (backwards from it's original position). It may be necessary to trim the hose at the radiator to provide clearance to the alternator pulley. Refill radiator and connect battery cable.

FLMK91L3S-2

1999-2002 Freightliner FL 60-70

1999-2002 Sterling Acctera

7.2L I6 Diesel / CAT 3126

Requires a Dual-V Pulley, w/-w/o A/C, w/-w/o Air Brakes

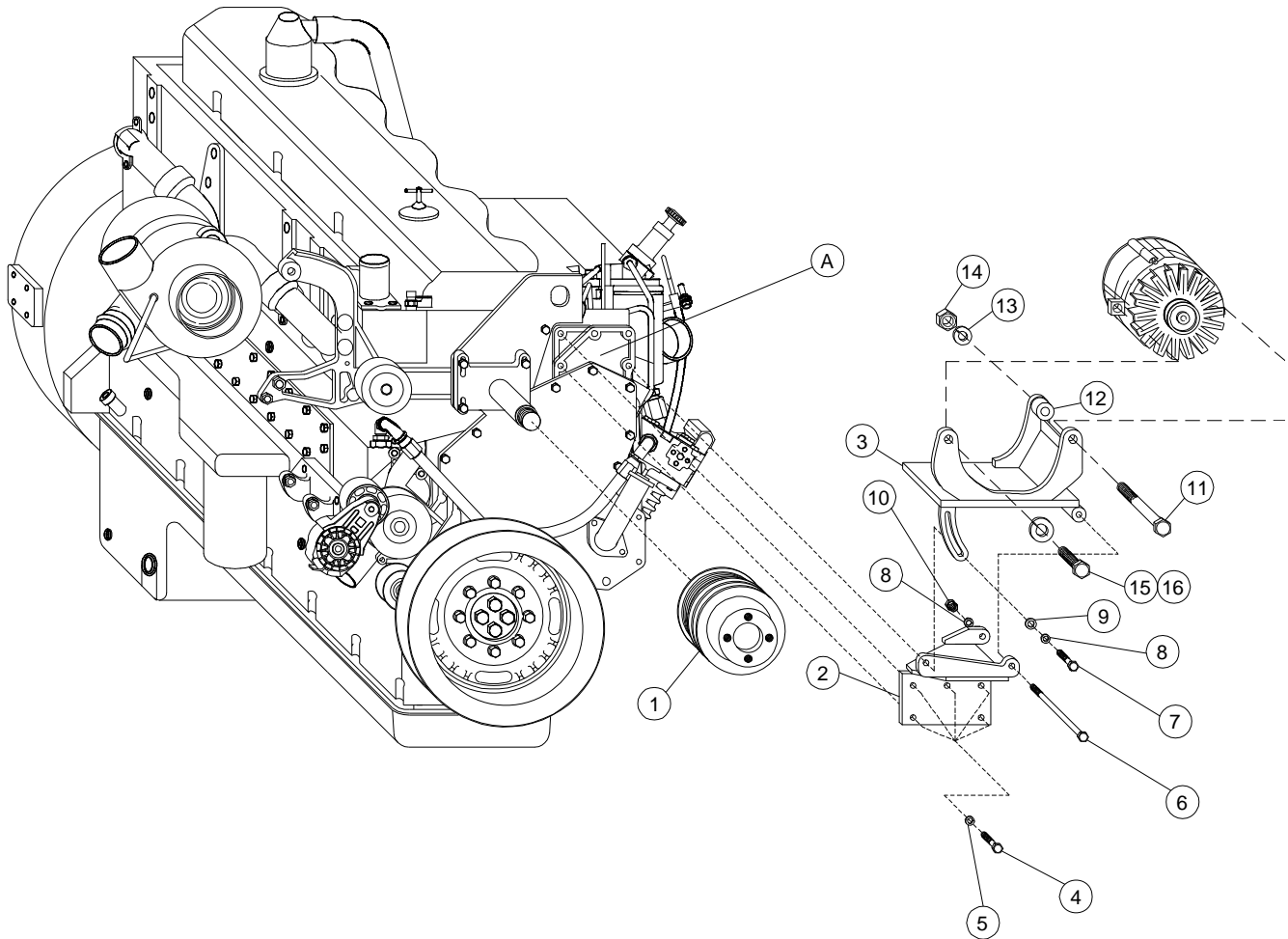

PARTS LIST

- | | |
|-----------------------|-----------------------|
| 1. LPC 912 (1) | 9. 3/8 FW (1) |
| 2. FLMB 910 (1) | 10. 3/8 NC (1) |
| 3. FLMP91L3S (1) | 11. 7/16 x 6 (1) |
| 4. 10mm x 55mm (5) | 12. SP100-.1.0CD |
| 5. 10mm LW (5) | 13. 7/16 LW (1) |
| 6. 3/8 x 5 NC (1) | 14. 7/16 Nut (1) |
| 7. 3/8 x 1-1/4 NC (1) | 15. 3/8 x 1-1/4 (1) |
| 8. 3/8 LW (2) | 16. 3/8 LW (1) |
| | 17. Belt Goodyear (2) |
| | 84540 |

1.14.2021