



CW MILL EQUIPMENT CO., INC.
P.O. Box 246 • Sabetha, Kansas 66534
(785) 284-3454 • FAX (785) 284-3601

FMK46L3S-8

1999-04 FORD TRUCK F-250-550

1997-19 FORD VANE-150-450

5.4L & 6.8L Triton

W-WO/AC

INSTALLATION NOTES

1. Disconnect the negative battery cable. On E series, remove the complete air cleaner assembly. Remove the fan and fan shroud. (Fan nut has right hand threads). Remove the O.E.M. serpentine belt and the flat idler on the passenger side of the engine. Remove the studs at locations "A & D" and install studs (5) with flatwashers (6). Torque studs to 35 ft/lbs.. Remove bolts at locations "B & C".
2. Install drive pulley (1) onto the harmonic balancer with bolts (2) and lockwashers (3). Torque bolts to 40 ft/lbs.. A hose kit is included in the mounting kit in order to reroute coolant hose coming from intake manifold. Install reroute kit if necessary before installing bracket to prevent damage to or restriction of coolant through the line. Install bracket (4) onto the studs at locations "A & D". Install bolts (7) with lockwashers (3) at locations "B & C", and nuts (8) with lockwashers (3) at locations "A & D". Tighten bolts and nuts evenly, then torque them to 35-40 ft/lbs. Install alternator w/bolts (15,18), slide (17), LW's (16,19) and FW (20).
3. Replace the OEM idler back to its original location. Replace the OEM belt. Install alt belt tensioner (9) with bolt (10). Install the alt. belt (22) onto the engine according to the belt diagram. Install fan spacer (21) onto the water pump. Replace the fan and fan shroud. Check for proper clearances between the fan and the drive pulley. Replace the air cleaner assembly if removed and connect the battery cable.

NOTE: On 2008 and newer E series van with the 5.4L engines, harmonic balancer pn 7L3Z-6312-A will need to be purchased from Ford Motor Company and installed to be able to install the drive pulley included in kit.

NOTE: Check all engine compartment hoses and wiring to insure they are not kinked, touching any high temperature item, or do not interfere with any linkage components.

NOTE: Due to OEM assembly tolerances, visually make certain that there is adequate clearance between fan and drive pulley.

FMK46L3S-8

1999-04 Ford Truck F-250-550

1997-19 Ford Van E-150-450

5.4L & 6.8L Triton

W-WO/AC

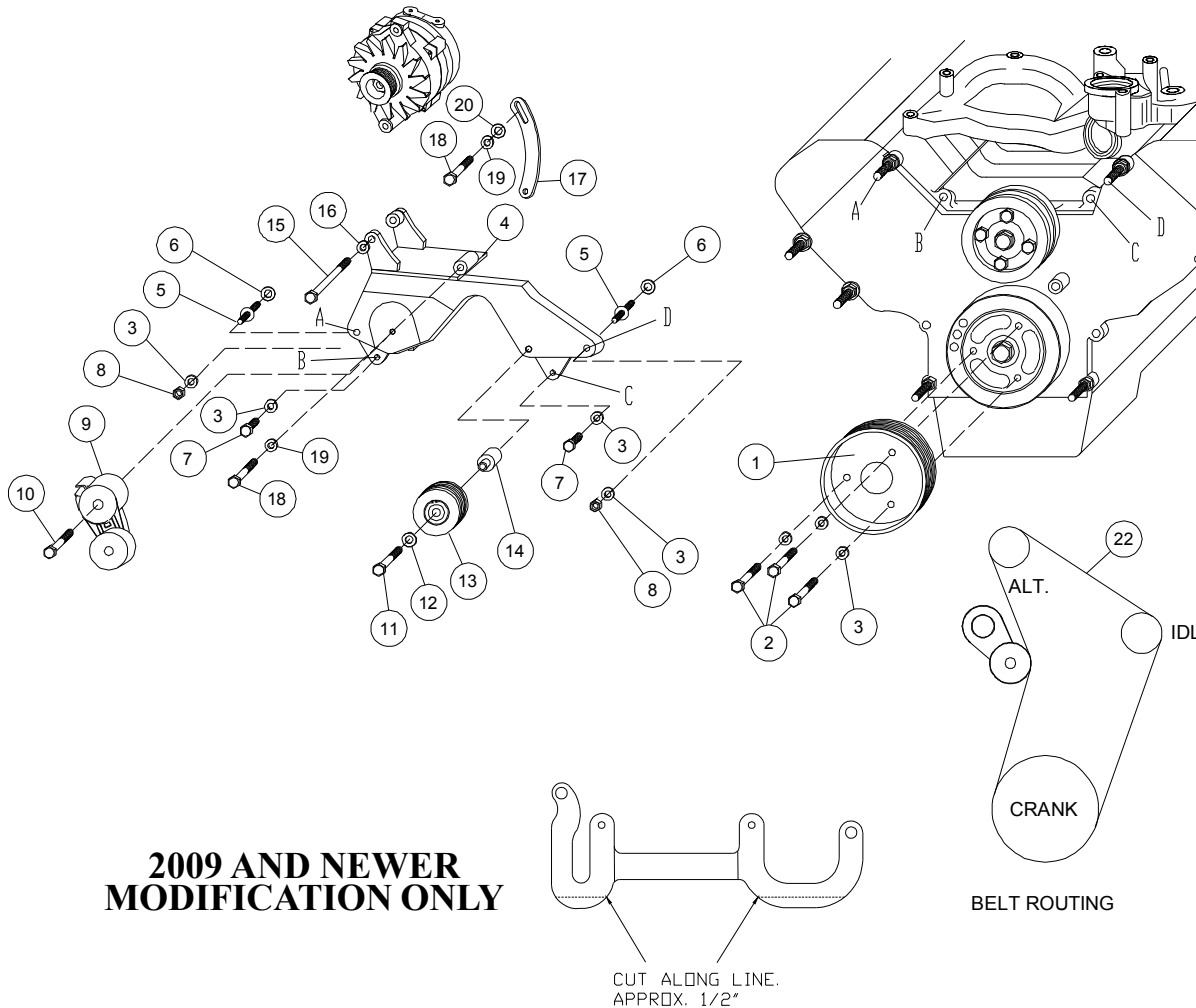

2009 AND NEWER MODIFICATION ONLY

PARTS LIST

- | | |
|--------------------------|-----------------------------------------------|
| 1. FPC 368 (1) | 15. 7/16 X 4-1/2 (1) |
| 2. 10mm x 55mm (3) | 16. 7/16 LW (1) |
| 3. 10mm LW (7) | 17. L3SB3 (1) |
| 4. FMP46L3S (1) | 18. 3/8 x 1-1/4 (2) |
| 5. 10107 1.5 ST (2) | 19. 3/8 LW (2) |
| 6. .080 shim (2) | 20. 3/8 FW (1) |
| 7. 10mm x 60mm (2) | 21. FSK37R (for 5.4L) |
| 8. 10mm nut (2) | 21a. FSK6.8B (for 6.8L) |
| 9. 8920236 Tensioner (1) | 22. Dayco 5080595 (1) |
| 10. 12mm x 80mm (1) | HOSE REROUTE KIT ITEMS 23-24 NOT SHOWN |
| 11. 12mm x 65mm (1) | 23. 3/4" 90 deg. Elbow (1) |
| 12. 12mm FW | 24. 3/4" 90 deg. Hose Barb (1) |
| 13. GPCD 8 (1) | 25. #12 Hose Clamp (2) |
| 14. FMB 391 Bushing (1) | |