



**CW MILL EQUIPMENT CO., INC.**  
**P.O. Box 246 • Sabetha, Kansas 66534**  
**(785) 284-3454 • FAX (785) 284-3601**

**FMK260L3S-8**  
**2008-10 Ford Truck F250-550**  
**6.4L Diesel**  
**W-WO/AC,WO/Dual Alt.**

## **INSTALLATION NOTES**

---

1. Using a 8mm socket or wrench, disconnect the negative battery cables first, disconnect the positive cables and remove the battery hold downs. Remove both batteries from the vehicle. Remove the two bolts from the power steering reservoir and lift it from its cradle. Remove the four bolts from the top half of the fan shroud. (Do not try to remove the fan shroud at this time). To protect the coolers, cut two pieces of cardboard, one 24" x 24" and one 24" x 36". Slide the 24" x 36" piece between the A/C condenser and the transmission cooler, and the 24" x 24" piece between transmission cooler and the CAC (charge air cooler).
2. Using a 10mm socket or wrench, remove the 2 upper CAC bolts, the transmission cooler bolts and the hood latch bolts. Disconnect the horns, remove the bolt holding them to the radiator support and remove the horn and bracket assembly from the vehicle. Remove the plastic clips holding the hood latch cable to the radiator support. Remove the upper radiator support bolts and clamps from each side of the radiator. Using a 13mm socket or wrench, remove the three radiator support bolts from each side of the radiator support. While pushing the top of the radiator towards the cab, lift up on the radiator support and remove it from the vehicle. Using a 11mm deep well socket, loosen the two right hand CAC tube clamps and remove the tube. Remove the top half of the fan shroud from the vehicle.
3. Disconnect the cooling fan clutch electrical connector. Unclip and position the fan wiring aside. Using a fan nut tool (part #43300 Lisle Tool Corp.), remove the cooling fan and clutch. **IMPORTANT** (fan nut has left hand threads). Gently pulling the radiator forward for clearance, lift the fan and clutch assembly from the vehicle. Use extreme care not to damage the radiator with the fan during removal. Using a 13mm socket, remove the two upper nuts and two lower bolts from the fan diffuser and remove it from the vehicle.
4. Remove the air cleaner assembly by removing the wiring, air intake duct and pulling straight up on duct side of air cleaner pulling it out of the rubber grommets. Remove the O.E. 8-groove serpentine belt and tensioner. Release the tension on the A/C belt and remove the A/C tensioner. The A/C belt can be left on the truck. Remove the two flat idlers from the engine. Remove the two nuts and two bolts holding the alternator bracket to the engine. Disconnect the alternator wires and remove the alternator and bracket assembly from the engine.
5. Remove the alternator from the alternator bracket. Install the alternator onto the new bracket reusing the O.E. bolts. Install the bracket assembly onto the engine using bolt(18) at location "", one O.E. bolt, and O.E. nuts. Torque nuts and bolts to 40-45 ft-lbs. Install the auxiliary alternator onto the bracket using bolts(21,26), nut(24), lw's(23,27), fw's(16), spacer(22), and slide(25). Connect the O.E. alternator wires.

6. Install the A/C tensioner and belt onto the new bracket with the O.E. bolt. Install the grooved idler assembly on bracket in this order: spacer(10), GPCS8(9) (snap ring to front), double ended spacer(11), flat idler(8), fw(16), and bolt(15). Install flat idler assembly on O.E. location in this order: O.E. spacer from behind O.E. idler, flat idler(8), double ended spacer(12), O.E. idler, fw(16), and bolt(15). Install the drive pulley(1) onto the engine dampener using the three 10mm x 50mm flange bolts(2) and torque them to 45-50 ft-lbs.
7. Install the 89450 tensioner(6) onto the bracket in the upper location and install belt(20) as shown in the diagram. Install the 89200B tensioner(4) in the lower location. Install the alternator belt(19) as shown in diagram. Install the fan spacer nut(29). Using a suitable tool, remove the fins from the diffuser that comes in contact with the alternator tensioner and belt.
8. Reinstall air cleaner assembly, air duct, and wiring. Replace the fan diffuser using 3/4" spacers(30) on top with O.E. nuts. Install fan. Fan nut gets torqued to 96 ft-lb. Connect the fan clutch wire. Replace the fan shroud. Install the CAC tube and torque the clamps to 11 ft-lbs. Replace the radiator core support. Replace the radiator support clamps. Replace the transmission cooler and remove the cardboard from the vehicle. Replace the hood latch, use the washer marks on the latch to properly align the hood latch. Note: The hood latch bolts have serrated washers on them. Replace the powersteering resevoir. Install and connect the batteries.

NOTE: Check all wires, hoses, etc. that may have been disturbed during assembly to ensure they do not come in connect with any hot or moving parts.

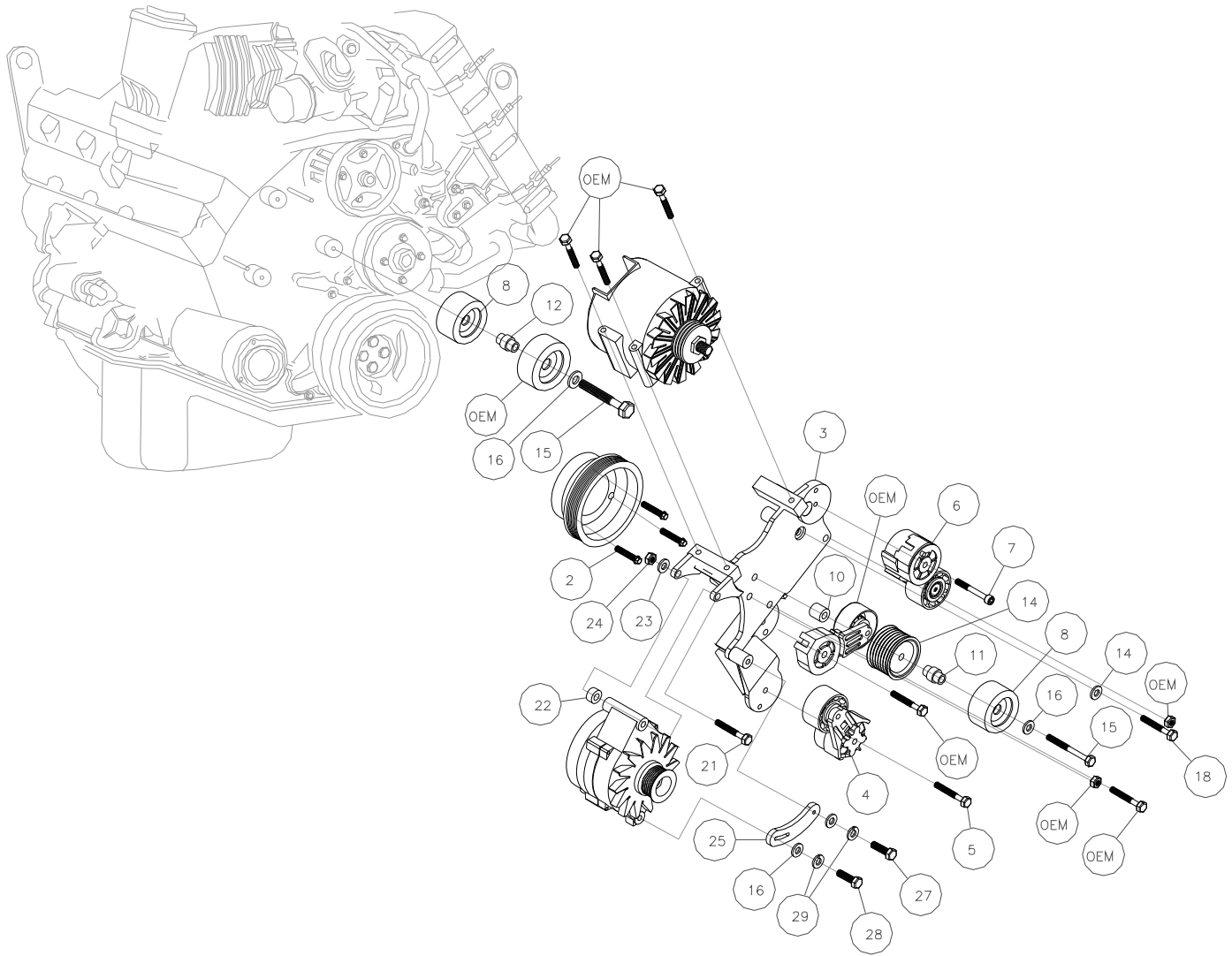

### PARTS LIST

- |     |                       |     |                  |
|-----|-----------------------|-----|------------------|
| 1.  | FPC2608(1)            | 18. | 10mm x 100mm(1)  |
| 2.  | 10mm x 50mm Bolts(3)  | 19. | 5080690(1)       |
| 3.  | FMP260L3S-8           | 20. | 5080755(1)       |
| 4.  | 89200B(1)             | 21. | 7/16 x 5 Bolt(1) |
| 5.  | 10mm x 80mm Flange(1) | 22. | SP88-.500(1)     |
| 6.  | 89450(1)              | 23. | 7/16LW(1)        |
| 7.  | 10mm x 70mm SHCS(1)   | 24. | 7/16 Nut(1)      |
| 8.  | 89016 Dayco(2)        | 25. | L3SB4 Slide(1)   |
| 9.  | GPCD-8(1)             | 26. | 3/8 x 1-1/4(2)   |
| 10. | FMB 2601L3S(1)        | 27. | 3/8 LW(2)        |
| 11. | FMB 2602L3S(1)        | 28. | 5/16 FW(1)       |
| 12. | FMB 2603L3S(1)        | 29. | FSK 260(1)       |
| 13. | 12mm x 100mm(1)       | 30. | SP64-.750 (2)    |
| 14. | 10mm LW(1)            |     |                  |
| 15. | 10mm x 75mm(1)        |     |                  |
| 16. | 3/8 FW(1)             |     |                  |
| 17. | 12mm FW(1)            |     |                  |

