



CW MILL EQUIPMENT CO., INC.
P.O. Box 246 • Sabetha, Kansas 66534
(785) 284-3454 • FAX (785) 284-3601

FMK 66SD508-8

1999-2003 Ford Truck 250-550

7.3 Direct Injected Intercooled Diesel
W-WO/AC or Dual Alternator

INSTALLATION NOTES

1. Disconnect negative battery terminals. Drain radiator until coolant level is below thermostat housing. Remove the tire wrench and jack tools from the radiator support. Remove the three bolts from the coolant reservoir and move it aside. Remove the upper radiator hose, the fan and fan shroud. The fan nut has right hand threads.
2. Install drive pulley (1) on the front of the harmonic balancer with bolts (2) and lockwashers (3). Remove plastic 7.3 cover and it's mounting bracket from the top of engine. Unload belt tensioner and remove belt. Remove alternator from bracket and lay on top of engine.
3. Use powersteering pulley puller, (Snap-On PN# CJ117, MAC PN# PP7185M or it's equivalent) to remove powersteering pulley. Remove the three bolts holding the powersteering pump to the bracket, do not remove hoses from PS pump. Remove the four bolts holding the powersteering and alternator bracket to the engine and remove the bracket.
4. Install bracket (4) onto the engine with bolt (10) and lockwasher (11) at location (A), and bolt (9) with lockwasher (11) at location (B). Do not tighten. Install idler bracket (20) with bolts (9) and lockwashers (10) at locations (C) and (D). Tighten all bolts to 40 ft. lbs. Install idler (22) onto bracket (20) using bolt (23) and shims (21) to align it with the drive pulley. Bolt the powersteering pump onto the new bracket using the O.E.M. bolts. Install the powersteering pulley onto the powersteering pump using a pulley installation tool, (Snap On PN# CJ113B, Mac PN# PP7005M or it's equivalent). Install the alternator onto bracket (4) using O.E.M. bolts. Install O.E.M. serpentine belt.
NOTE: Since the alternator location was altered, the O.E.M. belt may fit slightly tighter.
5. Install aux. A.C. compressor (15) onto plate (5) with bolts (16,17), nuts (18) and slide bushings (19). Install compressor and plate onto bracket (4) using bolts (12), flatwashers (13) and lockwashers (14). Align clutch pulley to crankshaft pulley (1), tighten plate bolts securely.
NOTE: Due to a new air cleaner duct design change by Ford, some interference may be encountered when installing an A.C. compressor. If this occurs, use a hot air gun to heat the cover and form it away from the pulley about 1/2 inch.
6. Install spring loaded tensioner (6) onto the tensioner boss (making sure that the line up pin is in place) with bolt (7) and lockwasher (8), tighten.
7. Install the serpentine belt (26) over the drive pulley and A.C. compressor pulley. With a 5/8 wrench, load the tensioner until it bottoms out. Slide the belt into place and release the tensioner.
8. Rotate the upper radiator hose so the radiator end is on the engine. Cut the hose approximately 8" from the short 90° bend, splice in the steel bent tube (24) using clamps (25). Install radiator hose and refill coolant. Use tie strap through hole in the front of the bracket just under the alternator to secure the radiator hose. Connect battery terminal.

CAUTION: Check all engine compartment vacuum hoses and electrical wiring that may have been disturbed or re-routed during kit installation to be sure that hoses are not kinked, that they do not touch any high temperature item, and that they do not interfere with any linkage components.

FMK 66SD508-8

1999-2003 Ford Truck 250-550

7.3 D.I.T. Intercooled Diesel

W-WO/AC/Dual Alternator

CAUTION: Due to limited space available in the engine compartment, the pump is mounted directly under the hood light. Check clearance between the light and the compressor before closing the hood. If there is not enough clearance, relocate the hood light to provide clearance.

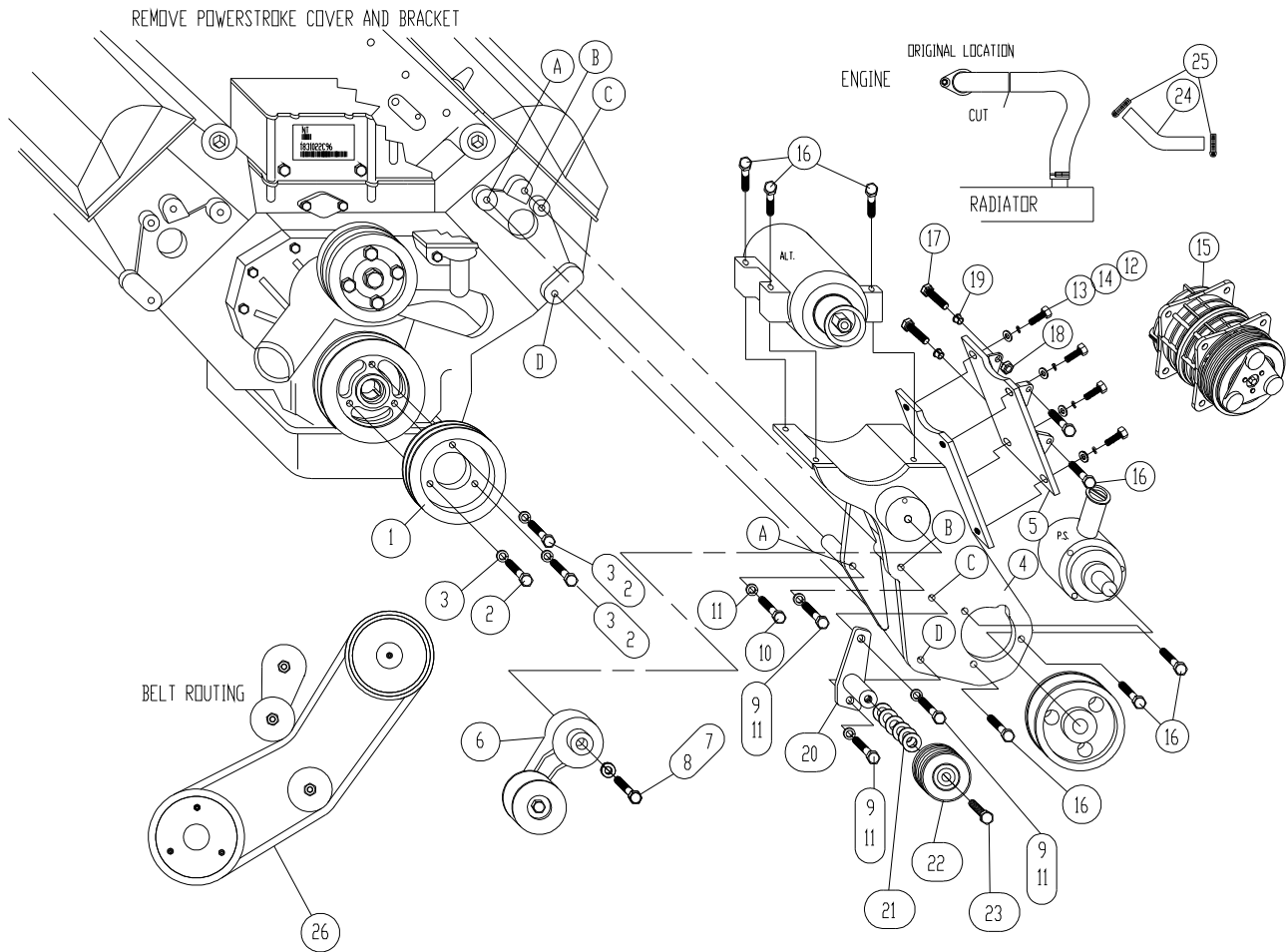

PARTS LIST

- | | |
|-------------------------|---------------------------------|
| 1. FPC 65812 (1) | 15. A.C. Compressor (1) |
| 2. 10mm x 40mm 1.5 (3) | (Sold Separately) |
| 3. 10mm LW (3) | 16. 10mm x 30mm Flange Bolt (2) |
| 4. FMB 660 (1) | 17. 10mm x 40mm Flange Bolt (2) |
| 5. FMP 66SD508-8 (1) | 18. 10mm Flange Nut (2) |
| 6. Dayco 8920236 (1) | 19. 1255-0090 Slide Bushing (2) |
| 7. 12mm x 90mm 1.75 (1) | <u>GPCKDF66-8 (items 20-23)</u> |
| 8. 12mm LW (1) | 20. FMB662 (1) |
| 9. 10mm x 140mm 1.5 (3) | 21. IPW 14 Shim (4) |
| 10. 10mm x 80mm 1.5 (1) | 22. GPCD8P (1) |
| 11. 10mm LW (4) | 23. 5/8 x 2 1/2 NC |
| 12. 3/8 x 1 NC (4) | 24. F66 Rad. Line (1) |
| 13. 3/8 FW (4) | 25. #28 Clamp (2) |
| 14. 3/8 LW (4) | 26. Belt Dayco 5080675 (1) |