



CW Mill Equipment Co., Inc.
14 Commerce Drive Sabetha, KS 66534
Phone: (785) 284-3454
Fax: (785) 284-3601
Email: brackets@cwmill.com
Website: www.cwkits.com

IMK54-8

2011-2016 International

4300-4400Durastar

Max Force 245 HP, W-W/O AC

7.6L Diesel

For use with a Viscous Clutch

Requires 8 Groove Clutch

INSTALLATION NOTES

1. Remove the left hand side inner fender. Remove the fan from the fan pulley (***THE FAN NUT HAS LEFT HAND THREADS***) and leave it inside the fan shroud, be careful not to damage the radiator . Loosen the six fan pulley bolts. Release the tension on the belt and remove the belt. Remove the fan bolts and install the drive pulley (1) with bolts (2). Torque the bolts to 28 ft. lbs. Reinstall the O.E.M. belt.
2. Remove the plastic wire harness support on the right side of the engine. Remove the rubber air compressor hose at the compressor. Cut the steel air compressor tube at the top of the engine as shown in the picture. Remove the rubber charge air tube on the left side of the engine. It will not be reused. Remove the nuts from locations A,B,C,D & E and remove bolts from locations B,C,D and E. Install coupler nut (3) at location A reusing OEM bolt. Install stud (4) into coupler nut at location A.
3. Install the pump onto the main bracket (7) using the bolts provided in the kit. ***DO NOT TIGHTEN.*** Install the pump and bracket assembly onto the engine using nut (15) at location A and bolts (5) at locations B,C,D and E. Torque them to 28ft. lbs. Using a straight edge or other suitable tool, align the pump with the drive pulley and tighten the bolts to 28- 30 ft.lbs Install the tensioner (8) with bolt (9). Install idler (10) with bushing (11), flat washer (12) and bolt (13). Install the pump drive belt (14) according to the belt diagram. Replace the fan.
4. Install the new charge air tube with the blue elbow going onto the engine and turned upward, and the red coupler going onto the cooler. Install the steel as show in the picture and secure the clamps at both ends. Secure the wire harness with the standoff and clamp provided. Install the air compressor hose and secure it with the standoff and clamp provided. There are a couple photos included for reference.
5. Secure the hoses and wires that have been disturbed during installation. Check for proper clearances to any hot or moving parts. Run the engine and check for proper belt tracking, adjust if necessary. Replace the inner fender.

IMK54-8

2011-2016 International

4300-4400Durastar

Max Force 245 HP, W-W/O AC

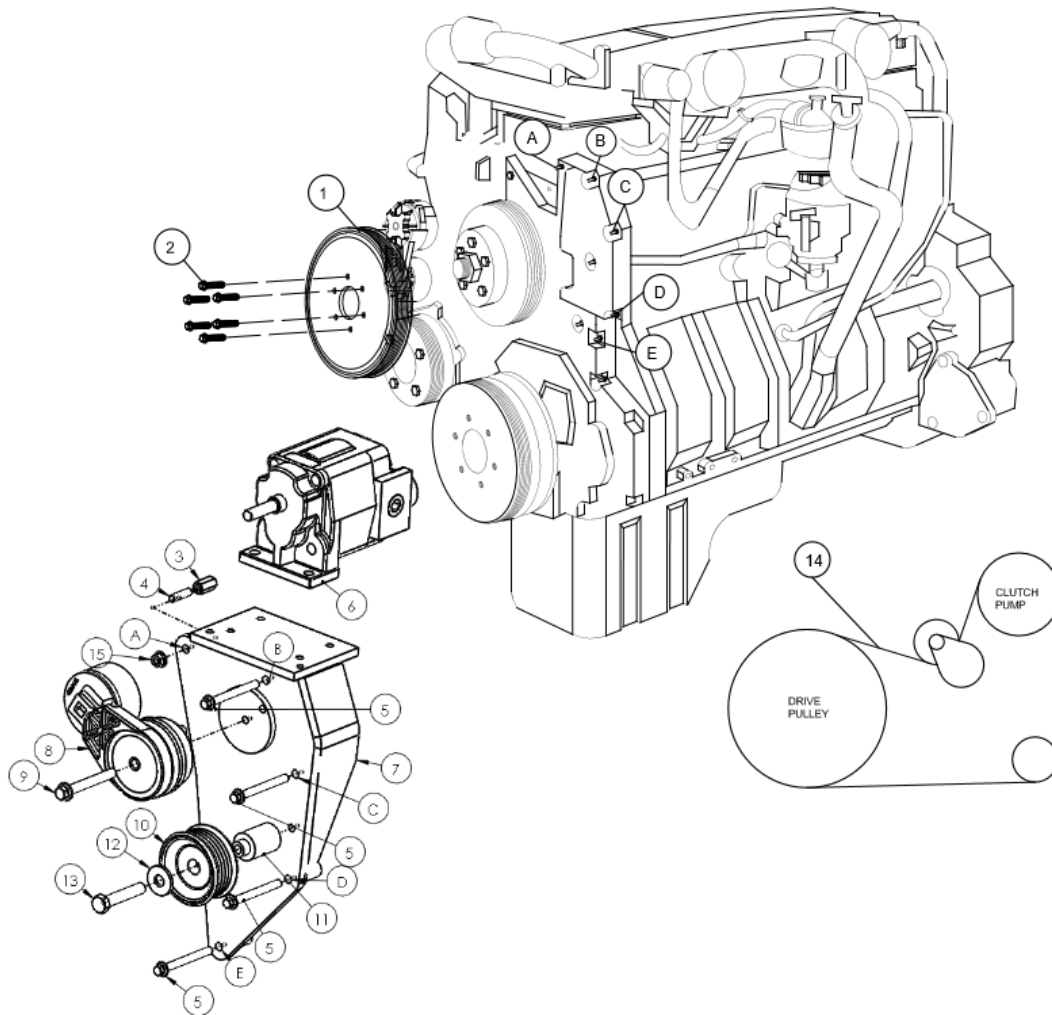

PARTS LIST

- | | |
|--------------------------------|---------------------------------|
| 1. IPC468 (1) | 8. 89446 (1) |
| 2. 8mm x 30mm Flanged Bolt (6) | 9. 10mm x 80mm Flanged Bolt (1) |
| 3. 8mm x 1.03 Coupler Nut (1) | 10. GPCD8 (1) |
| 4. 8mm x 30mm Stud (1) | 11. IMB 530 (1) |
| 5. 8mm x 90mm Flange (4) | 12. 12mm FW (1) |
| 6. Clutch Pump (Sold Sep.) | 13. 12mm x 65mm Bolt (1) |
| 7. IMP54(2-4) (1) | 14. 5080580 Dayco Belt #2 (1) |
| | 15. 8MM Flange Nut (5) |