



CW Mill Equipment Co., Inc.
14 Commerce Drive Sabetha, KS 66534
Phone: (785) 284-3454
Fax: (785) 284-3601
Email: brackets@cwmill.com
Website: www.cwkits.com

VDK20SD508-I6
2015-2023 RAM ProMaster City
2.4L I4 Gas w/ A/C

INSTALLATION NOTES

If equipped, remove the hood insulation. Remove the upper plastic engine cover. Remove the plastic belt shield from the power steering pump. Remove the air cleaner box and the fresh air intake duct. Remove the vent hose from the valve cover. Remove the factory belt.

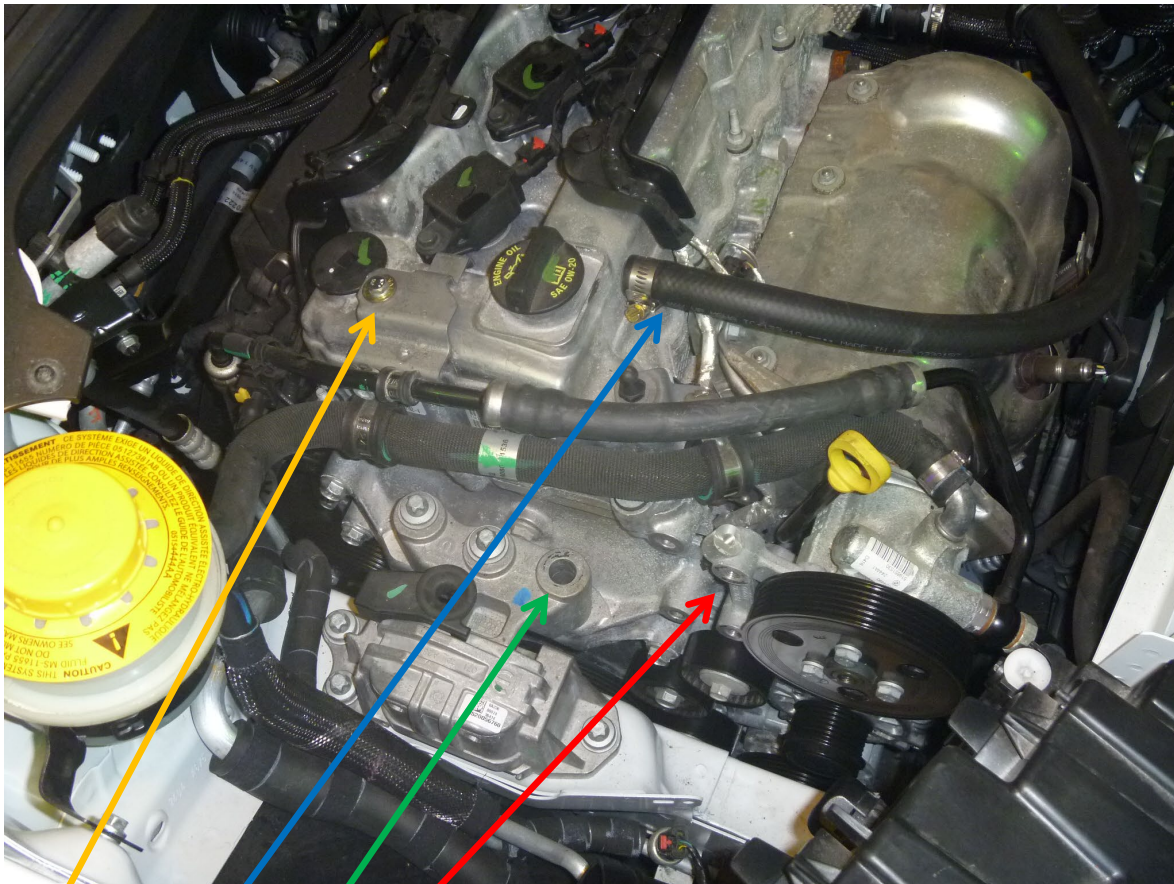

Remove the front power steering brace from this location.

Remove the motor mount bolt from this location.

Install this end of vent hose extension(16) using hose clamp(18).

Secure the power steering line retainer using bolt(15), lock washer(14), and flat washer(19).

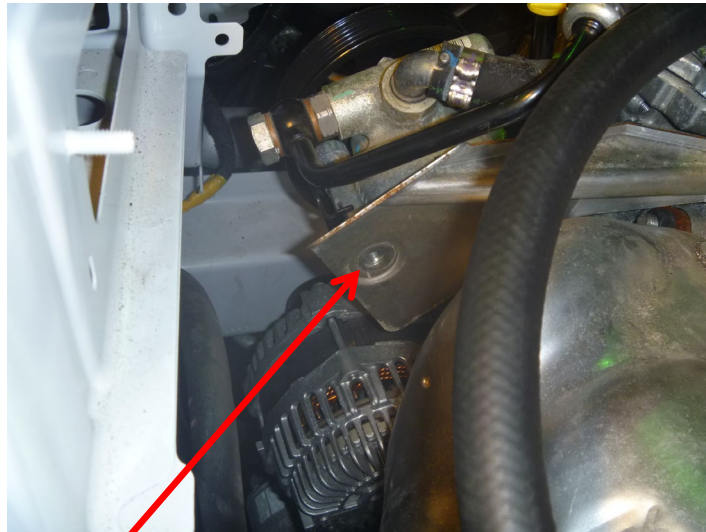

Remove the bolt from the power steering pump at this location.

Remove the hood insulation.

2017 and newer vehicles need the power steering line moved for bracket clearance. The metal tab may be cut off of the banjo fitting in order to rotate the line.

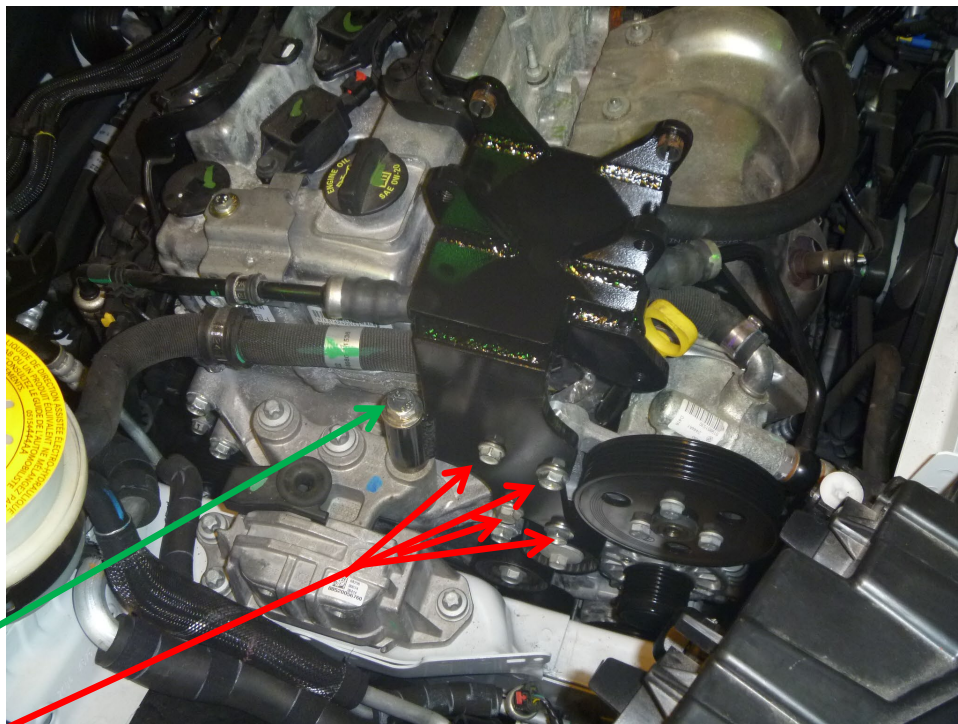

Install the main bracket(1) re-using the O.E.M. bolts. Finger tighten bolts.

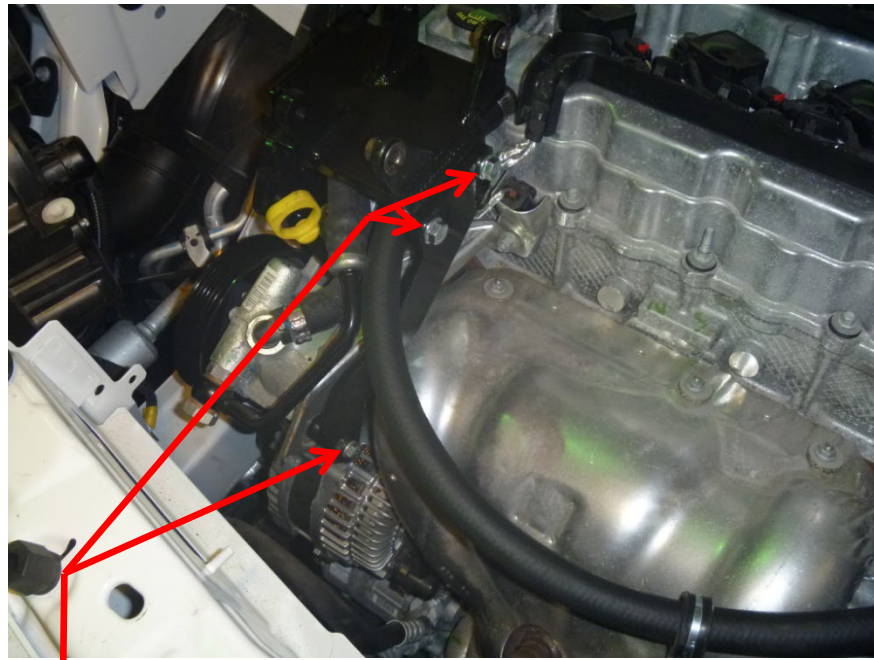

Install brace(2) using bolts(6,8) and lock washer(7).

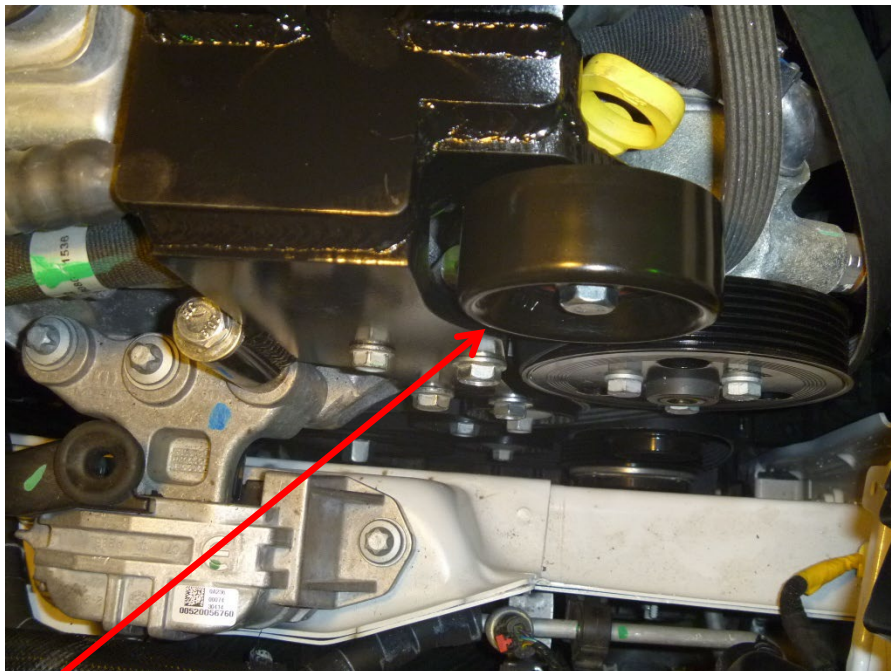

Install idler(10) using bushing(9) and bolt(11).

Route the belt(23) around the existing components before the air box is in place to make it easier to install later.

Re-install the fresh air intake and air box.

Install the auxiliary compressor using bolts(11,20), nuts(21), and slide bushings(22).
Install the new multiple accessory drive belt(23) according to the diagram.

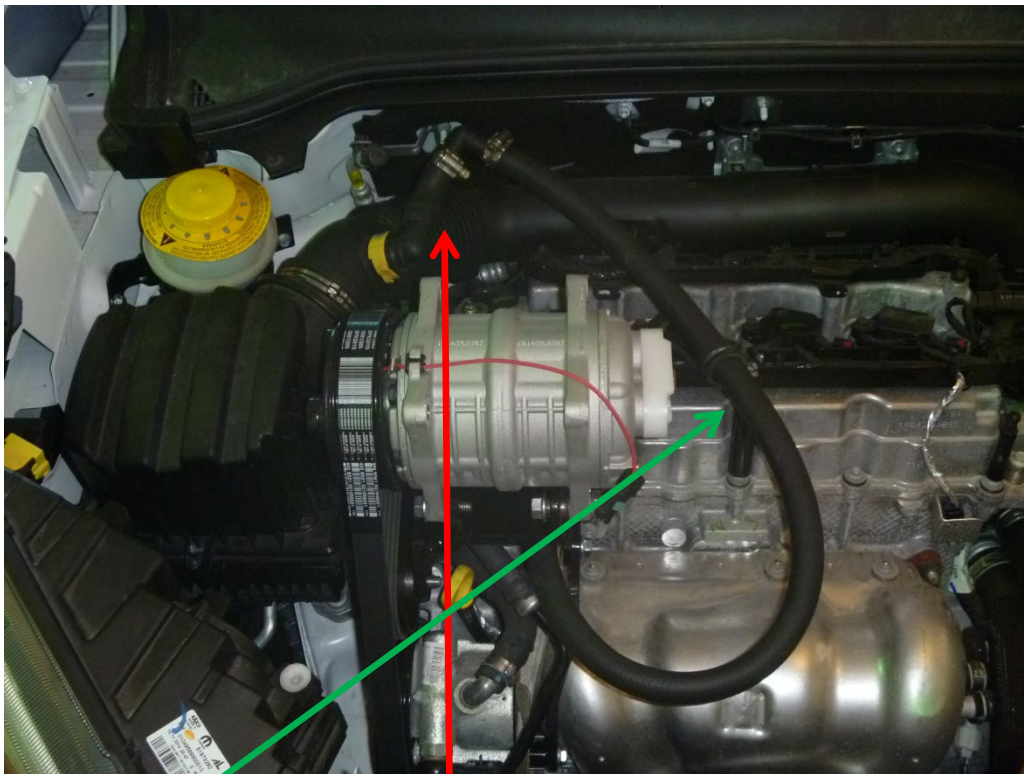
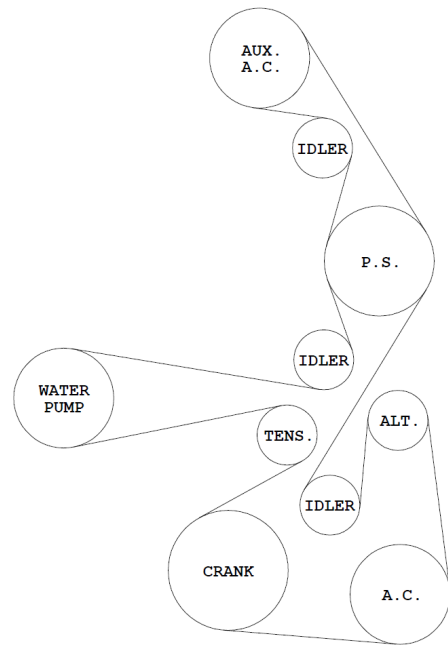

Cut O.E.M. vent hose 4" from the end as shown and install hose extension(16) using elbow(17) and hose clamps(18).

Install vent hose stand off(12) and secure hose extension(16) using wire loom clamp(13), bolt(15), and lock washer(14).

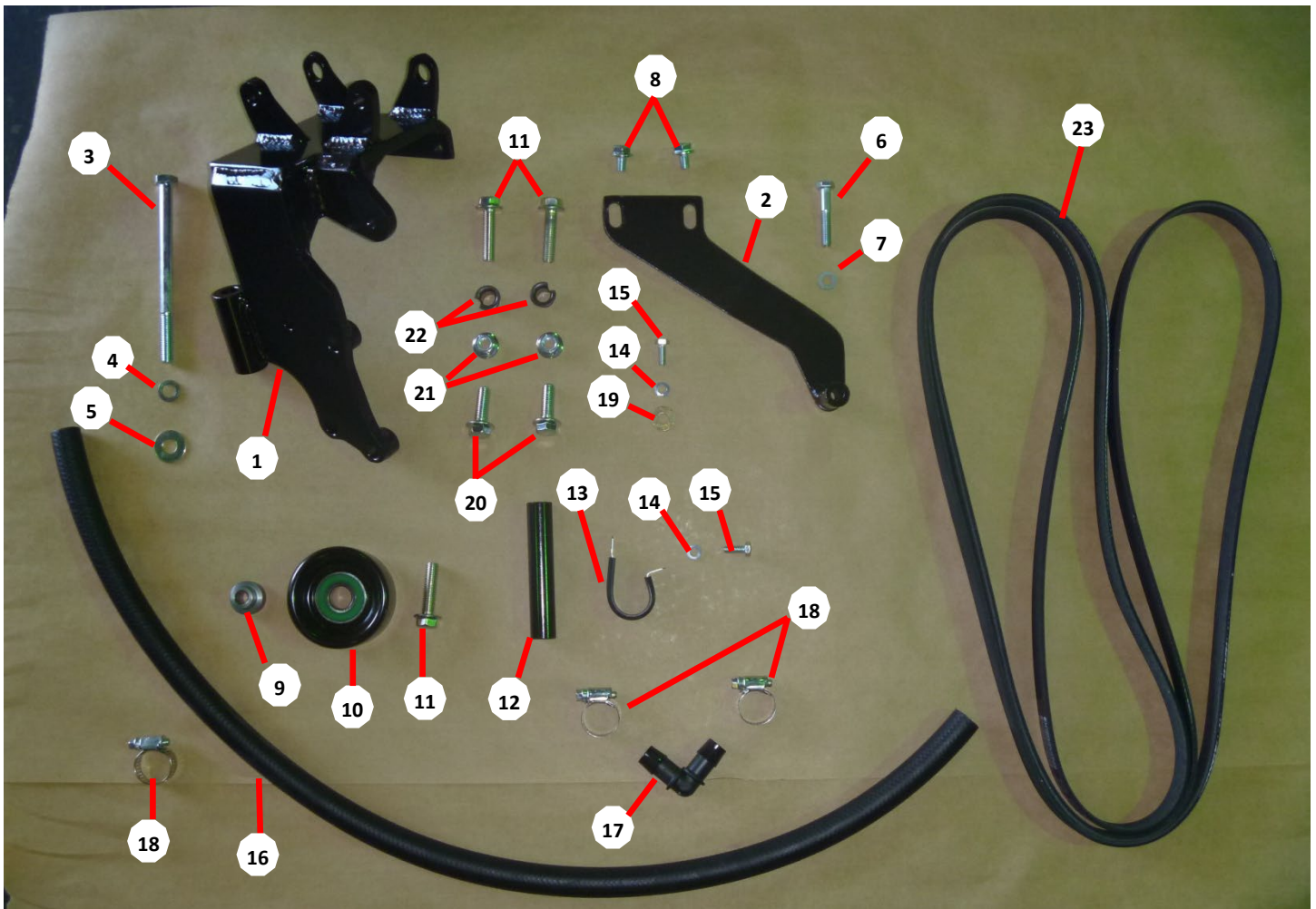

PARTS LIST

- | | |
|---------------------------------|---------------------------------|
| 1. VDMP20SD508-I6 (1) | 13. #16 Wire Loom Clamp (1) |
| 2. VDMB201 (1) | 14. 6mm Lock Washer (2) |
| 3. 10mm x 140mm (1) | 15. 6mm x 16mm (2) |
| 4. 10mm Lock Washer (1) | 16. 5/8" x 34" Oil Hose (1) |
| 5. 3/8" Flat Washer (1) | 17. 5/8" 90 deg. Elbow (1) |
| 6. 8mm x 45mm (1) | 18. #10 Hose Clamp (3) |
| 7. 8mm Lock Washer (1) | 19. 1/4" Flat Washer (1) |
| 8. 8mm x 12mm Flange Bolt (2) | 20. 10mm x 30mm Flange Bolt (2) |
| 9. CMB3867 (1) | 21. 10mm Flange Nut (2) |
| 10. 89007 (1) | 22. 1255-0090 Slide Bushing (2) |
| 11. 10mm x 40mm Flange Bolt (3) | 23. Dayco 5061305 |
| 12. VDMB202 (1) | |

Disclaimer: (1.) Due to the custom nature and variation of all add-on systems of this type, no complete system kits are offered by the manufacturer, and any group of parts marketed as a kit is limited to only the individually defined parts in that specific kit. The system designer's rotating accessory components are not included, offered, or fully known by the manufacturer. In addition to the absence of the rotating accessory system, other potential components such as additional clamps, brackets, wear liners, hardware, or other items that may be required by the system designer must be identified and supplied by the actual system designer. (2.) Due to vehicle manufacturer's assembly tolerances, production changes, and installation variances, it is the buyer's responsibility to ensure adequate clearance for all components including space for and safe location of the fan, radiator, all lines, and wires. Check for possible movement, vibration, friction points, heat exposure and/or shifting of any and all components such as hoses, wires, and all other components including those that may otherwise be considered non-moving and/or unaffected by the installation (3.) The buyer is responsible for the entire installation of a mounting kit as the mounting kit is part of a custom process controlled by the buyer through their whole system design and directed installer as the installer evaluates, locates, routes, aligns, and tightens all components while determining if additional clamps, brackets, wear-liners, or other components may be required, beyond those included in the kit. Any additional items required, beyond those included in the kit, are to be provided at the expense of the buyer. (4.) The buyer is responsible for the development and communication of their whole system installation procedures, safety precautions, application, and use of the engine accessory mounting kit in their system, including efforts to maintain vehicle control and prevent pinch, wear, impact, and/or burn exposure on all hoses, wires, and other parts. (5.) The buyer is responsible for providing trained and experienced installation decision making with technical know-how to apply professional judgment that specifically applies to each individual installation. The buyers chosen installers must be qualified and experienced technicians that are familiar with the vehicle and accessory being mounted as well as the buyer's whole system design and installation procedures associated with the kit. (6.) The buyer is responsible for determining and achieving compliance to all regulatory issues that apply to the use of all products. (7.) The manufacturer reserves the right to make changes and/or improvements to any product at any time with or without notice.