

INSTALLATION NOTES

1. The buyer is responsible for providing trained and experienced installation decision making with technical know-how to apply professional judgment that specifically applies to each individual installation.
2. Be sure to read and understand all available information including but not limited to instructions, warnings, sale terms, and warranties for the vehicle and all system components prior to attempting installation.
3. Disconnect the negative battery cable(s). On the driver's side of the engine, cut the three zip ties holding a heater hose to the charge air tube. Loosen the clamps and remove the charge air tube from the engine.
4. Remove the air filter/fan ring support brackets from the engine compartment. They will not be reused.
5. Remove the OEM 10-groove serpentine belt.
6. Install main bracket (1) onto the engine at mounting locations [A] using mounting hardware (3) as shown. Do not tighten at this time.
7. Remove the OEM idler located just under the OEM A/C compressor. Remove the idler bushing and replace it with idler bushing (16). Reusing OEM idler and bolt, install idler mounting bracket (13) onto the engine at mounting location [C] as shown in illustration. Do not tighten at this time. Connect idler mounting bracket (13) to main bracket (1) with mounting hardware (14). Do not tighten at this time.
8. With all bolts in place and finger tight, the tightening sequence must be followed to assure proper belt alignment:
 - a. First, tighten the OEM idler bolt that holds the idler mounting bracket (13) to the engine. Tighten bolt to 48-52 ft/lbs.
 - b. Second, tighten bolts (14) to 48-52 ft/lbs.
 - c. Third, tighten bolts (3) to 48-52 ft/lbs.
9. Install smooth idler assembly (15-18) onto idler mounting bracket (13) in the lower, tapped hole on the bracket. Torque smooth idler assembly bolt (17) to 35-40 ft/lbs.
10. Install the aftermarket A/C compressor with mounting hardware (20-22) provided. Torque hardware to 40 ft/lbs. It may be best to install the two inside bolts. Pivot the compressor upwards, so the nut can be installed. Then, swing the compressor back down to install the outer hardware.
11. Install the air cleaner support bracket (4) onto the air cleaner box using hardware (6-7). Attach the air cleaner support bracket (4) to main bracket (1) using bolts (5) at mounting location [B]. Lift up on the air cleaner box when tightening the bolts to gain adequate clearance to the aftermarket A/C compressor.
12. Install the fan ring support bracket (8) onto the main bracket (1) using bolts (9) and to the fan ring with hardware (10-12) at mounting location [D].
13. Tighten air cleaner and fan ring support hardware securely.

INSTALLATION NOTES (CONTINUED) / DISCLAIMER

14. Install new drive belt (23) onto the engine and route it as shown in the diagram.

IMPORTANT: THE BELT MUST BE IN THE MIDDLE 8-GROOVES OF ALL PULLEYS ON THE ENGINE

15. Reinstall the charge air tube and tighten the clamps properly.

16. Secure the heater hose to the charge air tube with zip ties (19) provided.

17. Reconnect the negative battery cable(s).

CAUTION: Before starting the engine, check to make certain no wires, hoses, etc. that may have been disturbed during installation do not come in contact with any hot or moving parts. Properly refill any fluids that may have been drained. Check for leaks. Run the engine. Check for proper belt tracking and clearance of any hoses, wires, etc. It is the installer's responsibility to correct/adjust any components, if necessary, before the vehicle is put into service.

CW Mill Equipment Co., Inc. Mounting Kit and Mounting Kit Component Disclaimer: (1.) Due to the custom nature and variation of all add-on systems of this type, no complete system kits are offered by the manufacturer, and any group of parts marketed as a kit is limited to only the individually defined parts in that specific kit. The system designer's rotating accessory components are not included, offered, or fully known by the manufacturer. In addition to the absence of the rotating accessory system, other potential components such as additional clamps, brackets, wear liners, hardware, or other items that may be required by the system designer must be identified and supplied by the actual system designer. (2.) Due to vehicle manufacturer's assembly tolerances, production changes, and installation variances, it is the buyer's responsibility to ensure adequate clearance for all components including space for and safe location of the fan, radiator, all lines, and wires. Check for possible movement, vibration, friction points, heat exposure and/or shifting of any and all components such as hoses, wires, and all other components including those that may otherwise be considered non-moving and/or unaffected by the installation (3.) The buyer is responsible for the entire installation of a mounting kit as the mounting kit is part of a custom process controlled by the buyer through their whole system design and directed installer as the installer evaluates, locates, routes, aligns, and tightens all components while determining if additional clamps, brackets, wear-liners, or other components may be required, beyond those included in the kit. Any additional items required, beyond those included in the kit, are to be provided at the expense of the buyer. (4.) The buyer is responsible for the development and communication of their whole system installation procedures, safety precautions, application, and use of the engine accessory mounting kit in their system, including efforts to maintain vehicle control and prevent pinch, wear, impact, and/or burn exposure on all hoses, wires, and other parts. (5.) The buyer is responsible for providing trained and experienced installation decision making with technical know-how to apply professional judgment that specifically applies to each individual installation. The buyers chosen installers must be qualified and experienced technicians that are familiar with the vehicle and accessory being mounted as well as the buyer's whole system design and installation procedures associated with the kit. (6.) The buyer is responsible for determining and achieving compliance to all regulatory issues that apply to the use of all products. (7.) The manufacturer reserves the right to make changes and/or improvements to any product at any time with or without notice.

For use w/ TM13, TM15 or TM16 Ear-Mount Compressor
 Requires 8-Groove, 119mm Diameter Clutch
 Approximately 185% Overdriven w/ 119mm Diameter Clutch

Parts List

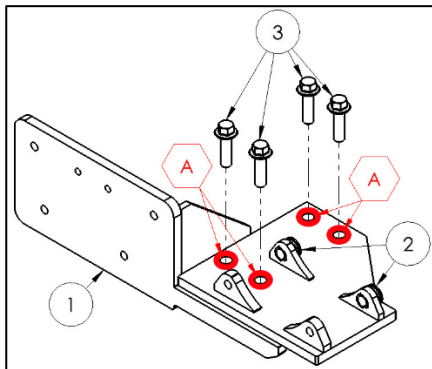

Main Bracket (1-2) & Mounting Hardware (3)

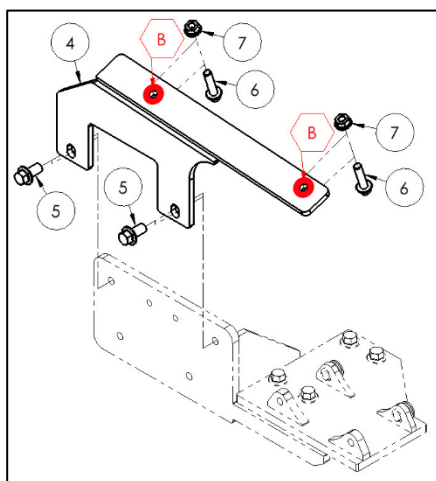

Air Cleaner Support Bracket (4)
 & Mounting Hardware (5-7)

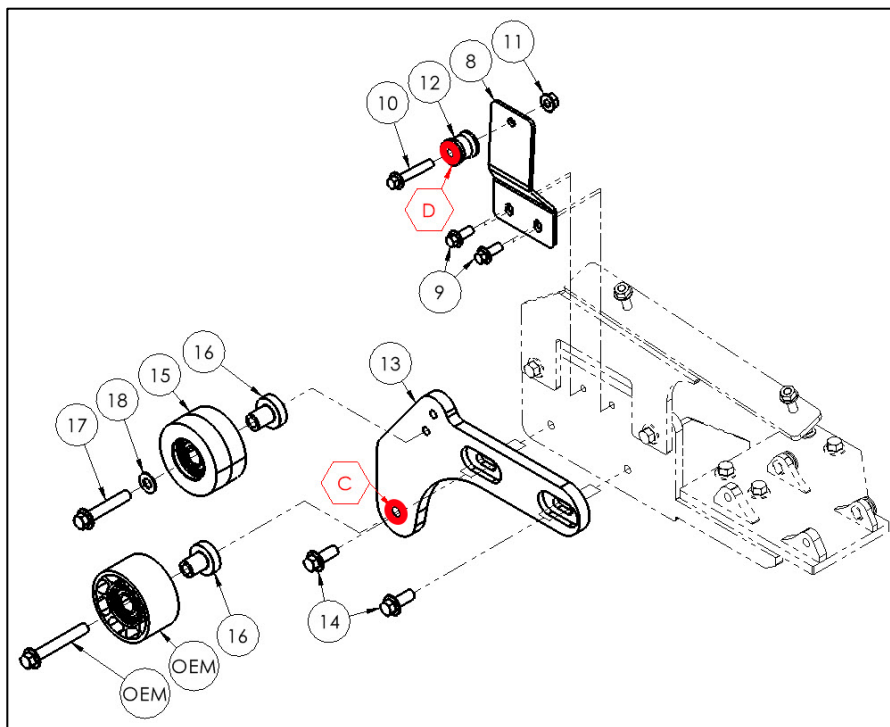

Fan Ring Support Bracket (8) & Mounting Hardware (9-12)
 Idler Mounting Bracket (13) & Mounting Hardware (14)
 Smooth Idler Assembly (15-18) & OEM Idler Assembly Mounting Hardware (16)

PARTS LIST							
Item	Part Number	Description	Qty.	Item	Part Number	Description	Qty.
Main Bracket				11	1013333	M8-1.25 10.9Gr Hex Flg. Nut	1
1	IMP82SD508-I8	Main Bracket	1	12	IMB823	1" Fan Ring Support Spacer	1
2	1011888A	M14 Slide Bushing (Installed)	2	Idler Mounting Bracket			
Main Bracket Mounting Hardware				13	IMB821	Idler Mounting Bracket	1
3	1022566	M10-1.5 x 35mm 10.9Gr Hex Flg. Bolt	4	Idler Mounting Bracket Mounting Hardware			
Air Cleaner Support Bracket				14	1013350	M10-1.5 x 25mm 10.9Gr Hex Flg. Bolt	2
4	IMB822	Air Cleaner Support Bracket	1	Smooth Idler Assembly & OEM Idler Assembly Mounting Hardware			
Air Cleaner Support Bracket Mounting Hardware				15	IPCD3.0	3" Dia. Machined Smooth Idler	1
5	1008390	M10-1.5 x 20mm 10.9Gr Hex Flg. Bolt	2	16	CMB741	Machined Idler Bushing	2
6	1018224	M8-1.25 x 35mm 10.9Gr Hex Flg. Bolt	2	17	1018225	M10-1.5 x 55mm 10.9Gr Hex Flg. Bolt	1
7	1013333	M8-1.25 10.9Gr Hex Flg. Nut	2	18	1002596	3/8" Flat Washer	1
Fan Ring Support Bracket				Heater Hose Zip Ties (Not Shown)			
8	IMB820	Fan Ring Support Bracket	1	19	1005417	14" Zip Tie	3
Fan Ring Support Bracket Mounting Hardware							
9	1013329	M8-1.25 x 20mm 10.9Gr Hex Flg. Bolt	2				
10	1022568	M8-1.25 x 45mm 10.9Gr Hex Flg. Bolt	1				

For use w/ TM13, TM15 or TM16 Ear-Mount Compressor
 Requires 8-Groove, 119mm Diameter Clutch
 Approximately 185% Overdriven w/ 119mm Diameter Clutch

Parts List / Belt Routing

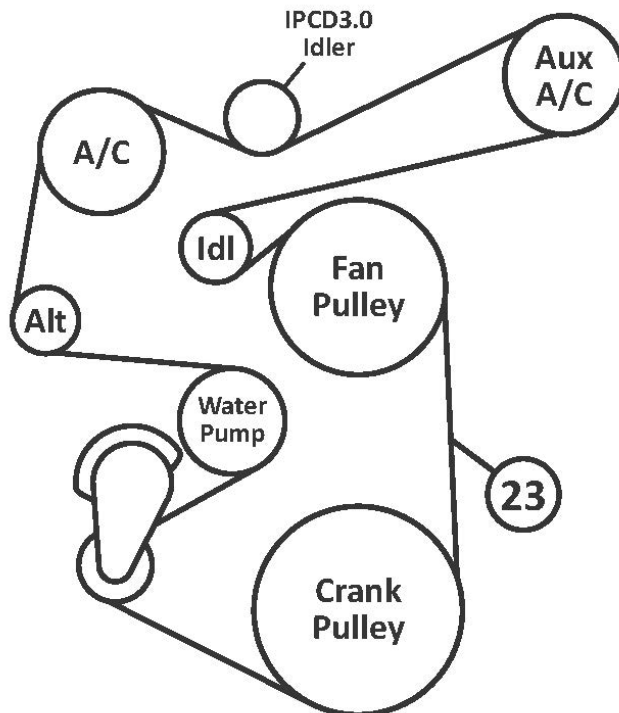
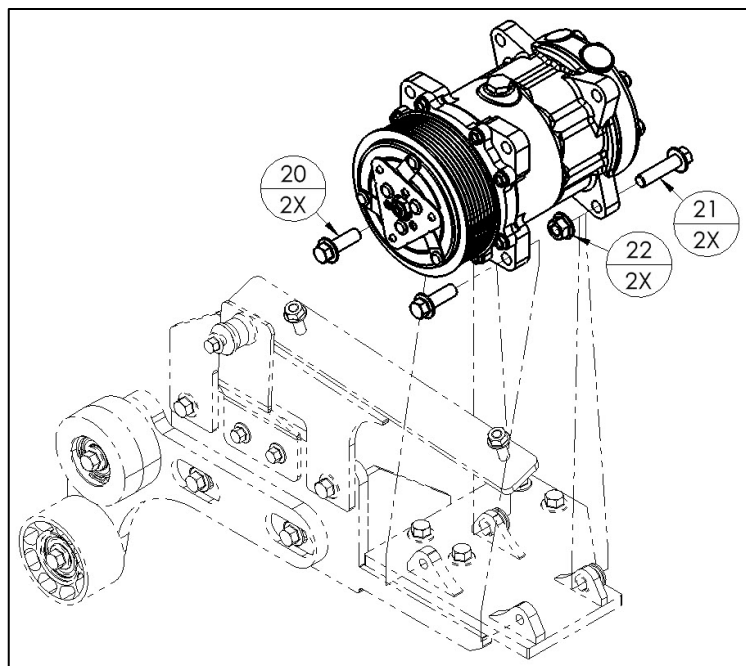

PARTS LIST			
Item	Part Number	Description	Qty.
Auxiliary A/C Compressor Mounting Hardware			
20	1006927	M10-1.5 x 30mm 10.9Gr Hex Flg. Bolt	2
21	1006933	M10-1.5 x 40mm 10.9Gr Hex Flg. Bolt	2
22	1018204	M10-1.5 10.9Gr Hex Flg. Nut	2
Belt (Only One Belt is Supplied)			
23	1081265	Goodyear 8-Groove, 126.5" Belt	1
	5081265	Dayco 8-Groove, 126.5" Belt	1
	K081254	Gates 8-Groove, 126.4" Belt	1

Reference Images

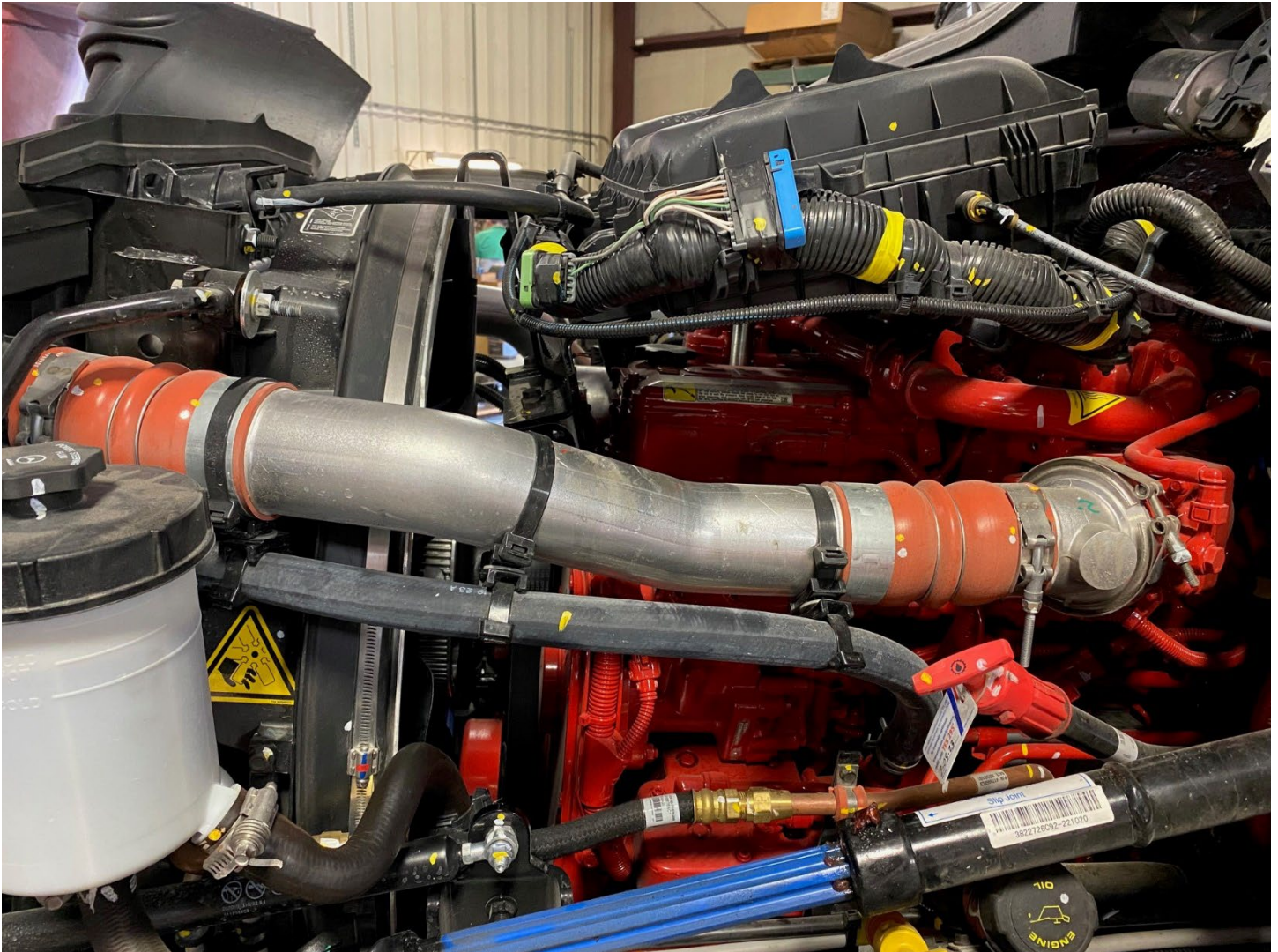

Charged Air Tube Assembly

Reference Images



OEM Air Cleaner & Fan Ring Support Brackets

IMK82SD508-I8

2024 International MV607
8.9L Cummins ISL-9 Diesel w/ A/C

For use w/ TM13, TM15 or TM16 Ear-Mount Compressor
Requires 8-Groove, 119mm Diameter Clutch
Approximately 185% Overdriven w/ 119mm Diameter Clutch

Reference Images



Main Bracket Mounting Locations [A]



Main Bracket Installed

For use w/ TM13, TM15 or TM16 Ear-Mount Compressor
Requires 8-Groove, 119mm Diameter Clutch
Approximately 185% Overdriven w/ 119mm Diameter Clutch

Reference Images

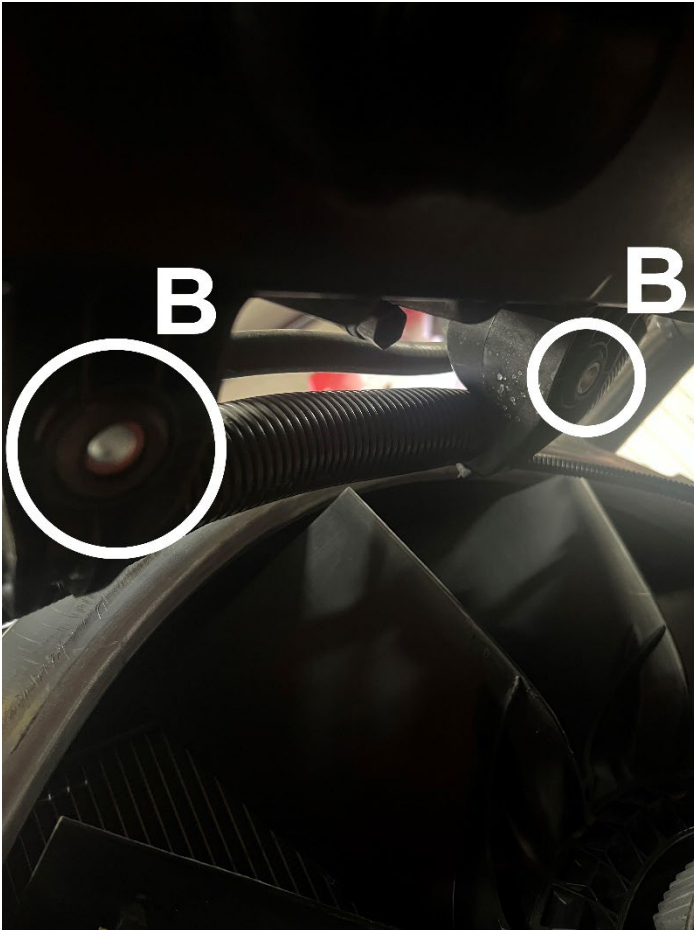

**Air Cleaner Support Bracket
Mounting Locations [B]**



Air Cleaner Support Bracket Installed

IMK82SD508-I8

2024 International MV607
8.9L Cummins ISL-9 Diesel w/ A/C

For use w/ TM13, TM15 or TM16 Ear-Mount Compressor
Requires 8-Groove, 119mm Diameter Clutch
Approximately 185% Overdriven w/ 119mm Diameter Clutch

Reference Images

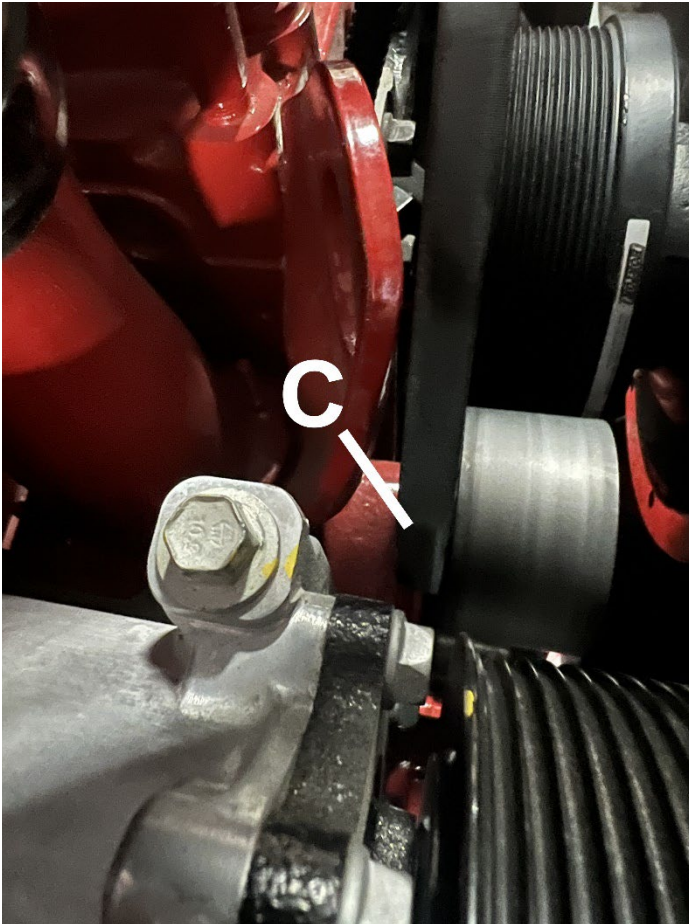

Idler Mounting Bracket
Mounting Location [C]



Idler Mounting Bracket Installed

IMK82SD508-I8

2024 International MV607
 8.9L Cummins ISL-9 Diesel w/ A/C

For use w/ TM13, TM15 or TM16 Ear-Mount Compressor
 Requires 8-Groove, 119mm Diameter Clutch
 Approximately 185% Overdriven w/ 119mm Diameter Clutch

Reference Images

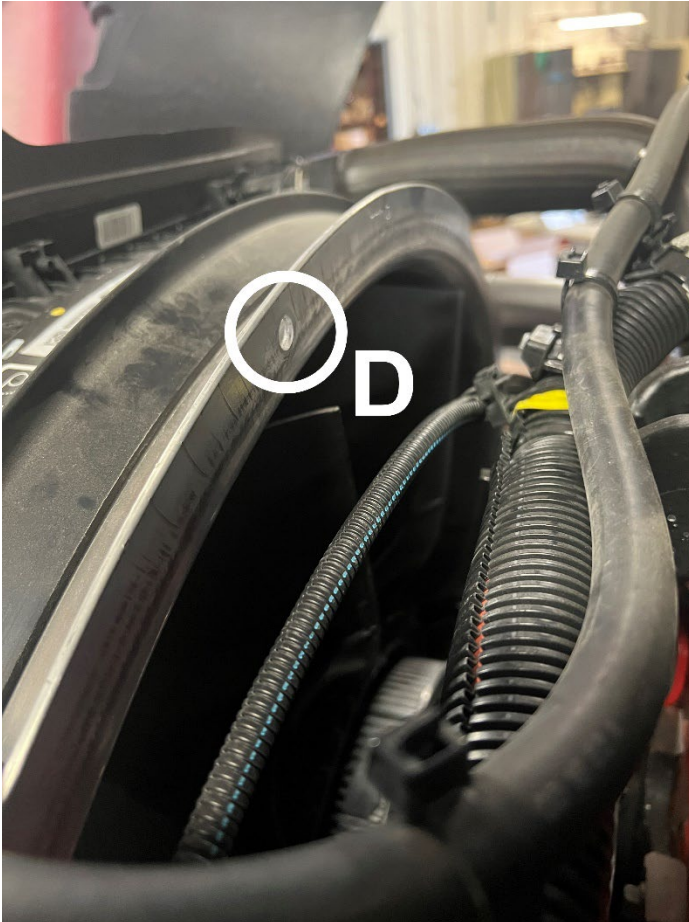

Fan Ring Support Bracket
 Mounting Location [D]

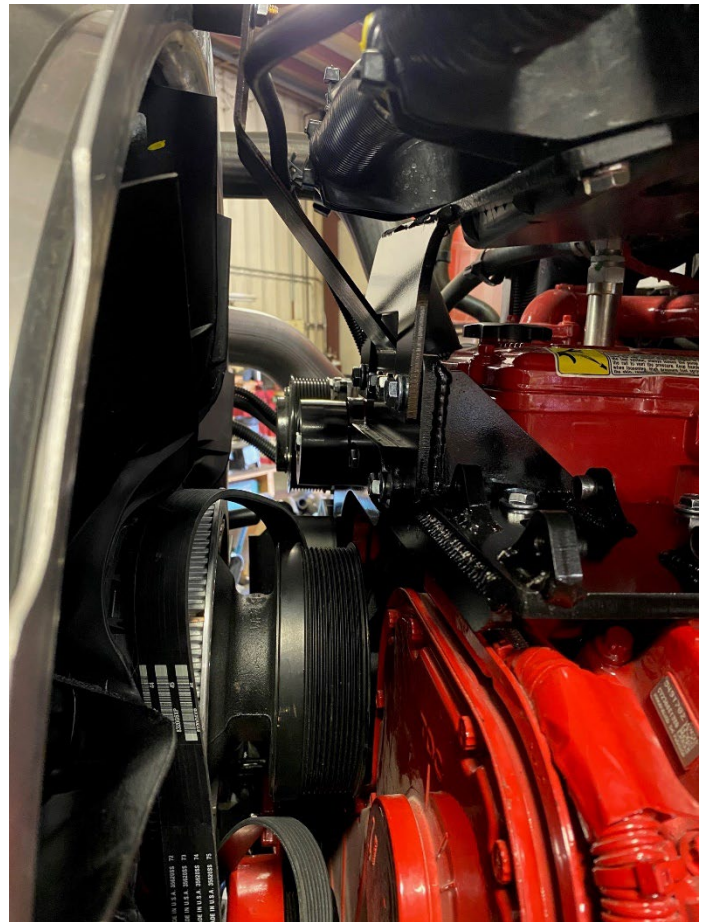

Fan Ring Support Bracket Installed

IMK82SD508-I8

2024 International MV607
8.9L Cummins ISL-9 Diesel w/ A/C

For use w/ TM13, TM15 or TM16 Ear-Mount Compressor
Requires 8-Groove, 119mm Diameter Clutch
Approximately 185% Overdriven w/ 119mm Diameter Clutch

Reference Images

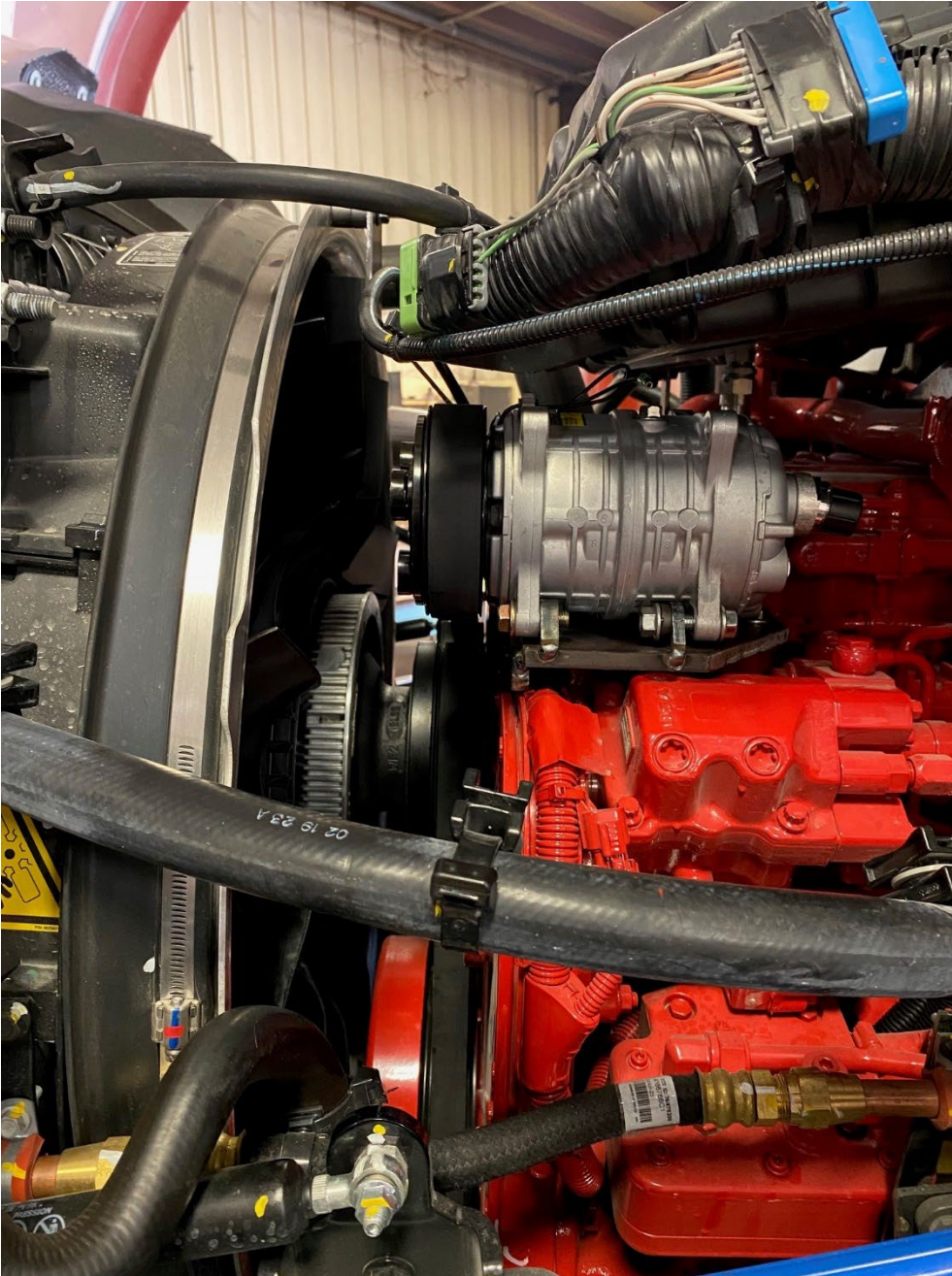

Aftermarket A/C Compressor Installed