



RMK60SD508-I8

2019-2024 RAM 2500-5500
6.7L I6 Cummins Diesel w/ A/C, w/o Dual Alternators

Requires 8-Groove, 119mm Diameter Clutch
For use w/ TM13, TM15, TM16 Ear Mount Compressor

INSTALLATION NOTES

1. The buyer is responsible for providing trained and experienced installation decision making with technical know-how to apply professional judgment that specifically applies to each individual installation.
2. Be sure to read and understand all available information including but not limited to instructions, warnings, sales terms, and warranties for the vehicle and all system components prior to attempting installation.
3. Disconnect the negative battery cables.
4. Remove the four nuts holding the fan shroud to the engine brackets. Remove the driver side fan shroud bracket from the engine, it will not be reused. Unplug the fan wire. Using the appropriate tool, loosen the fan nut (Fan nut has right hand threads). Then remove the fan and fan shroud from the engine compartment.
5. Remove the OEM belt.
6. Going through the P/S pulley to get to the bolts, remove the P/S pump so that the fan shroud bracket can be removed.
7. Using four 8mm x 50mm flange bolts (4) with nuts (5), install the bracket (1) onto the engine. Replace the P/S pump back to its original location and secure the bolts. Remove the bolt holding the upper radiator hose to the engine. Install brace (2) onto the engine with two 10mm x 20mm flange bolts (6) and onto the bracket with two 8mm x 20mm flange bolts (7). Secure bolts properly. Install the auxiliary air conditioner onto bracket (1) using bolts (13,14), nuts (15) and slide bushings (16). Cut one inch from the back of the radiator hose brace and install it to the engine using the front bolt (6) of the bracket brace (2).
8. Install the idler (10) onto the bracket (1) using bolt (12), flat washer (11), and spacer (9) installing it into the lowest hole possible making it allowable to install the belt without excessive force. Install the belt (17) according to belt diagram. Replace the fan and fan shroud with OEM hardware. Install the fan shroud brace (3) onto the bracket with bolt (7) and to the fan shroud using bolt (8) and the OEM nut. Reconnect the battery cables. Run vehicle and check for proper belt tracking.

NOTE: Make certain any hoses, wires or components that were relocated during the installation are securely fastened and do not come in contact with any hot or moving parts.

RMK60SD508-I8 – 2019-2024 RAM 2500-5500, 6.7L Cummins Diesel

For use w/ AC, w/o Dual Alternator, For use w/ TM13, TM15, TM16 Ear Mount AC Compressor, Requires 8 Groove Clutch

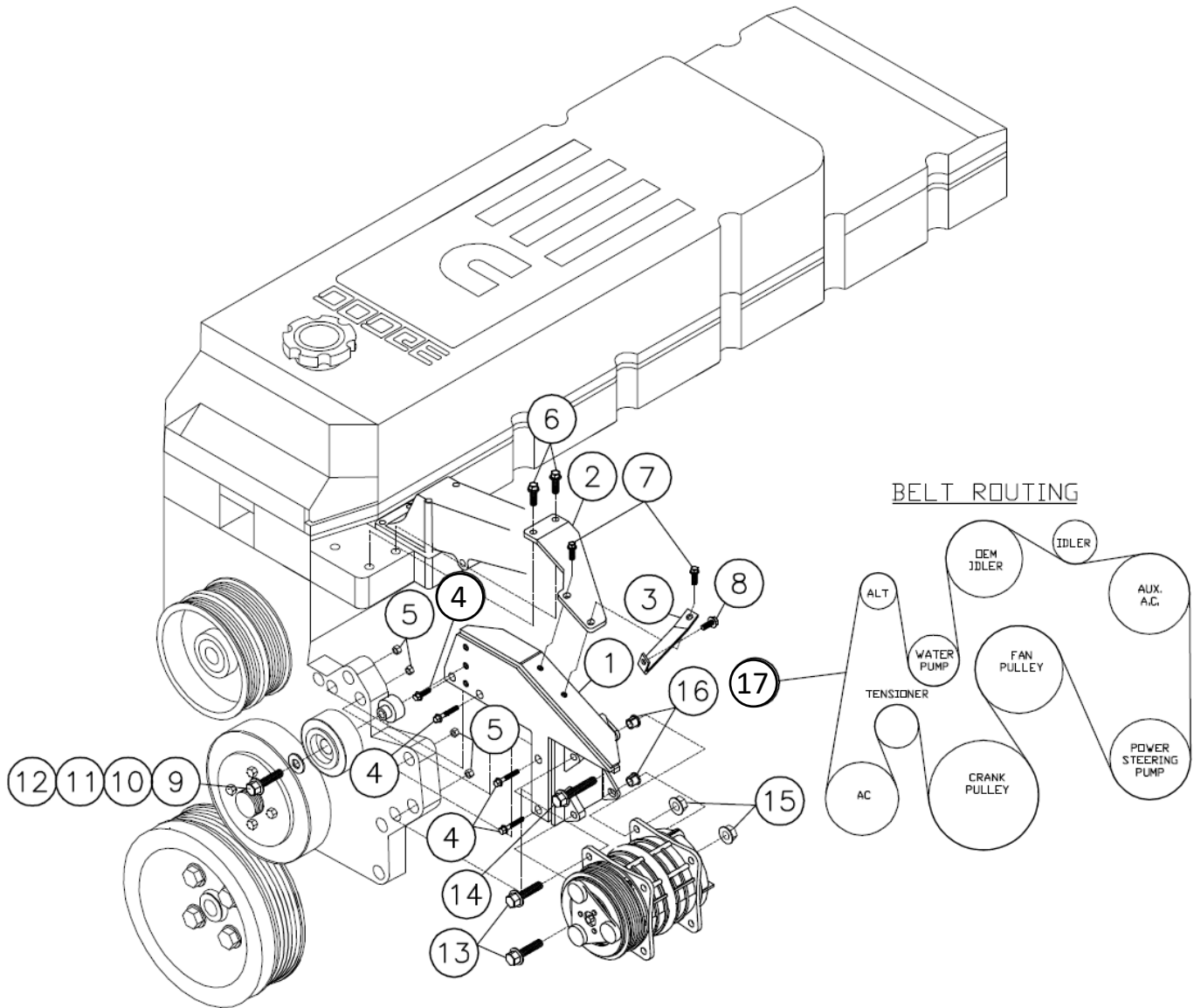

PARTS LIST

- | | |
|----------------------------|---------------------------------|
| 1. RMP60SD508-I8 (1) | 15. 10mm Flange Nut (2) |
| 2. DMB591 (1) | 16. 1255-0090 Slide Bushing (2) |
| 3. DMB592 (1) | 17. 5081305 Belt (1) |
| 4. 8mm x 50mm Flange (4) | |
| 5. 8mm Flange Nut (4) | |
| 6. 10mm x 20mm Flange (2) | |
| 7. 8mm x 20mm Flange (2) | |
| 8. 8mm x 25mm Flange (1) | |
| 9. DMB594 (1) | |
| 10. 89048 Idler (1) | |
| 11. 3/8 Flat Washer (1) | |
| 12. 10mm x 45mm (1) | |
| 13. 10mm x 30mm Flange (2) | |
| 14. 10mm x 40mm Flange (2) | |

RMK60SD508-I8 - 2019-2024 RAM 2500-5500, 6.7L Cummins Diesel

For use w/ AC, w/o Dual Alternator, For use w/ TM13, TM15, TM16 Ear Mount AC Compressor, Requires 8 Groove Clutch

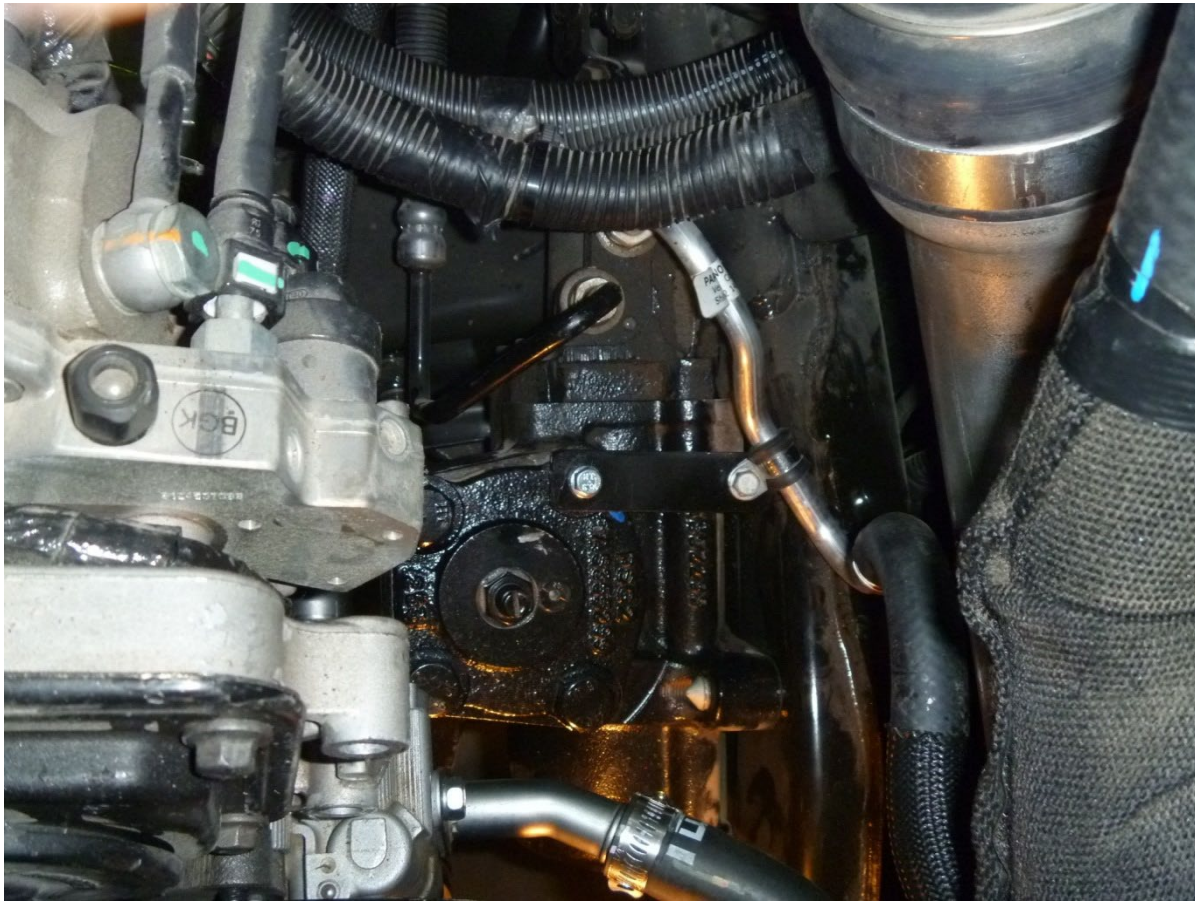

RMK60SD508-I8 - 2019-2024 RAM 2500-5500, 6.7L Cummins Diesel

For use w/ AC, w/o Dual Alternator, For use w/ TM13, TM15, TM16 Ear Mount AC Compressor, Requires 8 Groove Clutch

