

INSTALLATION NOTES

1. The buyer is responsible for providing trained and experienced installation decision making with technical know-how to apply professional judgment that specifically applies to each individual installation.
2. Be sure to read and understand all available information including but not limited to instructions, warnings, sale terms, and warranties for the vehicle and all system components prior to attempting installation.
3. Disconnect the negative battery cable. Remove the air duct and vent tube. The air duct will not be reused. Remove the screws holding the passenger side engine cooling fan to the fan shroud. This is done to allow room to get the alternator bolt out. The fan will stay inside of the shroud. Make sure the fan lays in a way to not damage the radiator.
4. To replace the alternator bolts without removing the stretch-fit belt, use this procedure as followed:
 - a. Using a flat screwdriver or other suitable tool, wedge it in between the alternator and the alternator bracket as shown (Reference Image A) to hold the alternator in place while the bolt is removed.
 - b. Install stud (9) at mounting location [A] into that location making certain stud (9) goes in far enough to be flush with the back side of the alternator bracket. Install nut (11) onto stud (9) and torque the nut to 40 ft/lbs.
 - c. Repeat this procedure on the other alternator bolt at mounting location [B] with stud (10) and nut (11). Make certain stud (10) is threaded completely into the cylinder head.
5. Going through the transmission bell housing inspection hole, use a prybar or another suitable tool to hold the engine from turning. While another technician removes the crankshaft damper bolt. Apply an appropriate RTV sealant to the face of pulley adaptor (2) where it will contact the harmonic balancer to cover the keyway and prevent oil leaks. Be careful not to apply any sealant to the pilot. It is also advisable to apply an appropriate RTV sealant to flat washer(3)/bolt(2) area where it will contact pulley adaptor (2) to also prevent oil leaks. Install pulley adaptor (2) with bolt (3) and flat washer (4). Torque bolt (3) to 220 ft/lbs. Install set-screws (6) into pulley adaptor (2) and run them all in until they touch the crankshaft damper. Going in a cross-pattern tighten set-screws (6) to 10 in/lbs. Then, in 20 in/lbs. increments, tighten set-screws (6) to a final torque specification of 120 in/lbs. Install drive pulley (1) onto the pulley adaptor (2) with bolts (5). Torque bolts (5) to 25 ft/lbs.
6. Remove bolt at mounting location [C] on the water pump. Remove bolt and spacer on the OEM A/C compressor at mounting location [D]. Install stud (13) into hole at mounting location [D] leaving approximately 1-1/4" of the stud protruding. Install bolt (15) into the main bracket (1) at mounting location [C]. Install the main bracket (1) onto the engine over the two alternator studs (9,10) at mounting locations [A,B] and stud (13) at the OEM A/C compressor mounting location [D]. Start bolt (15) finger tight at mounting location [C]. Install nuts (12) at mounting location [A,B]. Install nut (14) at mounting location [D]. First, torque nuts (12) at mounting location [A,B] to 45 ft/lbs. Then, torque bolt (15) at mounting location [C] and nut (14) at mounting location [D] to 25 ft/lbs.
7. Replace the cooling fan back onto the fan shroud.
8. Install tensioner (16) onto main bracket (1) with bolt (17).
9. Install idler (18) with hardware (19-21) onto main bracket (1). Install idler (22) with hardware (23-25) into the upper-most hole on main bracket (1).
10. Install the auxiliary A/C compressor onto main bracket (1) with hardware (35-37).

INSTALLATION NOTES (CONTINUED)

11. Install belt (38) and route it as shown in the diagram.
12. Secure the OEM A/C compressor hose to the side of main bracket (1) with hardware (26-27).
13. Install 90° silicone elbow (28) with end marked "ENG" onto the engine intake inlet using clamps (31). Install the silicone reducer coupler (30) onto the air filter box with clamp (31) and clamp (32). Install the steel air duct tube (29) into reducer coupler (30) and elbow (28). Position air duct tube (29) so the nipple is pointing approximately at a 45° angle upward and rearward as shown (Reference Image B). Tighten all clamps (31-32) securely. Take caution to not overtighten the clamps and break any plastic pieces. Remove the PCV hose from the passenger side valve cover. Install one end of the oil hose (33) there, and the other end to the nipple on the air duct tube (29) with clamps (2). Tighten all hose clamps securely. Again, take caution to not overtighten the clamps and break any plastic pieces.
14. Reconnect the negative battery cable.

CAUTION: Before starting the engine, check to make certain no wires, hoses, etc. that may have been disturbed during installation do not come in contact with any hot or moving parts. Properly refill any fluids that may have been drained. Check the engine for leaks. Run the engine and check for proper belt tracking and clearance of any hoses, wires, etc. It is the installer's responsibility to correct/adjust, if necessary, before the vehicle is put into service.

CW Mill Equipment Co., Inc. Mounting Kit and Mounting Kit Component Disclaimer: (1.) Due to the custom nature and variation of all add-on systems of this type, no complete system kits are offered by the manufacturer, and any group of parts marketed as a kit is limited to only the individually defined parts in that specific kit. The system designer's rotating accessory components are not included, offered, or fully known by the manufacturer. In addition to the absence of the rotating accessory system, other potential components such as additional clamps, brackets, wear liners, hardware, or other items that may be required by the system designer must be identified and supplied by the actual system designer. (2.) Due to vehicle manufacturer's assembly tolerances, production changes, and installation variances, it is the buyer's responsibility to ensure adequate clearance for all components including space for and safe location of the fan, radiator, all lines, and wires. Check for possible movement, vibration, friction points, heat exposure and/or shifting of any and all components such as hoses, wires, and all other components including those that may otherwise be considered non-moving and/or unaffected by the installation (3.) The buyer is responsible for the entire installation of a mounting kit as the mounting kit is part of a custom process controlled by the buyer through their whole system design and directed installer as the installer evaluates, locates, routes, aligns, and tightens all components while determining if additional clamps, brackets, wear-liners, or other components may be required, beyond those included in the kit. Any additional items required, beyond those included in the kit, are to be provided at the expense of the buyer. (4.) The buyer is responsible for the development and communication of their whole system installation procedures, safety precautions, application, and use of the engine accessory mounting kit in their system, including efforts to maintain vehicle control and prevent pinch, wear, impact, and/or burn exposure on all hoses, wires, and other parts. (5.) The buyer is responsible for providing trained and experienced installation decision making with technical know-how to apply professional judgment that specifically applies to each individual installation. The buyers chosen installers must be qualified and experienced technicians that are familiar with the vehicle and accessory being mounted as well as the buyer's whole system design and installation procedures associated with the kit. (6.) The buyer is responsible for determining and achieving compliance to all regulatory issues that apply to the use of all products. (7.) The manufacturer reserves the right to make changes and/or improvements to any product at any time with or without notice.

CMK134SD508-6

2020-2026 Chevrolet Silverado 1500
 2020-2026 GMC Sierra 1500
 5.3L V8 Gas w/ A/C, w/o OEM Dual Alternators

Requires 6-Groove, 119mm Diameter Clutch
 For use w/ TM13, TM15 or TM16 Ear-Mount Compressor
 Approximately 118% Overdriven w/ 119mm Diameter Clutch

Parts List

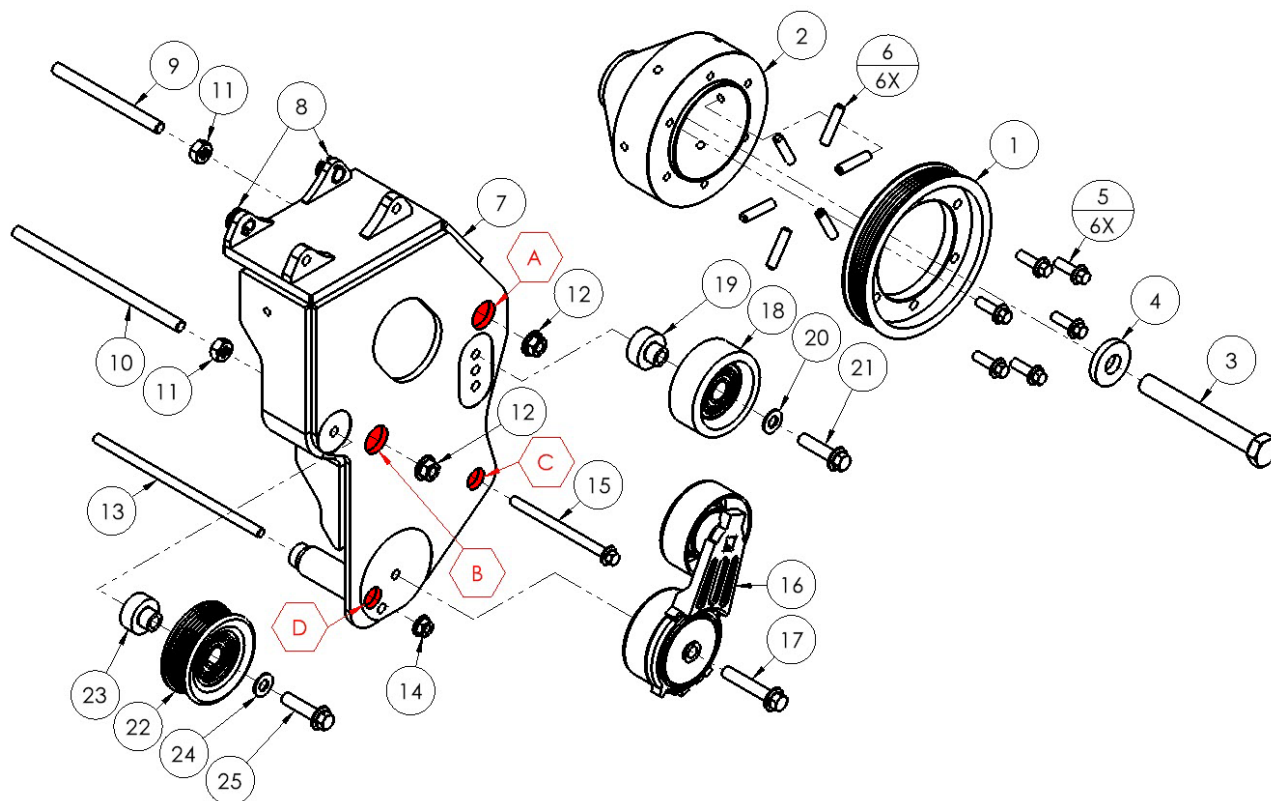

PARTS LIST

Item	Part Number	Description	Qty.	Item	Part Number	Description	Qty.
Add-on Drive Pulley Assembly				14	1013333	M8-1.25 10.9Gr Hex Flg. Nut	1
1	CPC1346-5.5	Add-on Drive Pulley (5.5" Dia.)	1	15	1018208	M8-1.25 x 110mm 10.9Gr Hex Flg. Bolt	1
2	CPA1340	Add-on Drive Pulley Adaptor	1	Tensioner Assembly			
3	1022587	M16-2.0 x 130mm 10.9Gr Hex Bolt	1	16	89203-007	Custom Assembled Tensioner	1
4	1022537	M16 Thick Flat Washer	1	17	1018225	M10-1.5 x 55mm 10.9Gr Hex Flg. Bolt	1
5	1011887	M8-1.25 x 25mm 10.9Gr Hex Flg. Bolt	6	Smooth Idler Pulley Assembly			
6	1022581	M8-1.25 x 35mm Cup-Pt. Set-Screw	6	18	89007	Dayco Idler Pulley	1
Mounting Bracket				19	VDMB306	Machined Idler Bushing	1
7	CMP134SD508-6	Mounting Bracket	1	20	1002596	3/8" Thru Hard Flat Washer	1
8	1011888A	M14 Slide Bushing (Installed)	2	21	1006933	M10-1.5 x 40mm 10.9Gr Hex Flg. Bolt	1
Mounting Bracket Mounting Hardware				Grooved Idler Pulley Assembly			
9	1006926	M10-1.5 10.9Gr All-Thread	120mm	22	89051	Dayco Idler Pulley	1
10	1006926	M10-1.5 10.9Gr All-Thread	190mm	23	VDMB306	Machined Idler Bushing	1
11	1003894	M10-1.5 10.9Gr Hex Nut	2	24	1002596	3/8" Thru Hard Flat Washer	1
12	1018204	M10-1.5 10.9Gr Hex Flg. Nut	2	25	1006933	M10-1.5 x 40mm 10.9Gr Hex Flg. Bolt	1
13	1011643	M8-1.25 10.9Gr All-Thread	190mm				

CMK134SD508-6

2020-2026 Chevrolet Silverado 1500
 2020-2026 GMC Sierra 1500
 5.3L V8 Gas w/ A/C, w/o OEM Dual Alternators

Requires 6-Groove, 119mm Diameter Clutch
 For use w/ TM13, TM15 or TM16 Ear-Mount Compressor
 Approximately 118% Overdriven w/ 119mm Diameter Clutch

Parts List

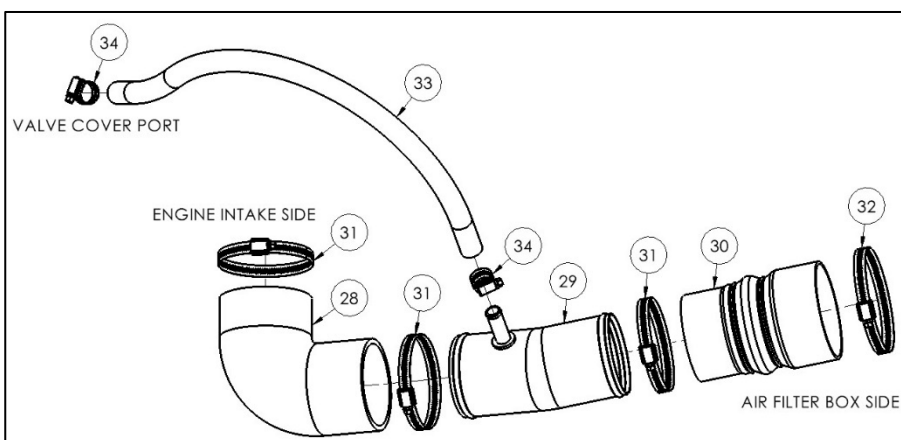
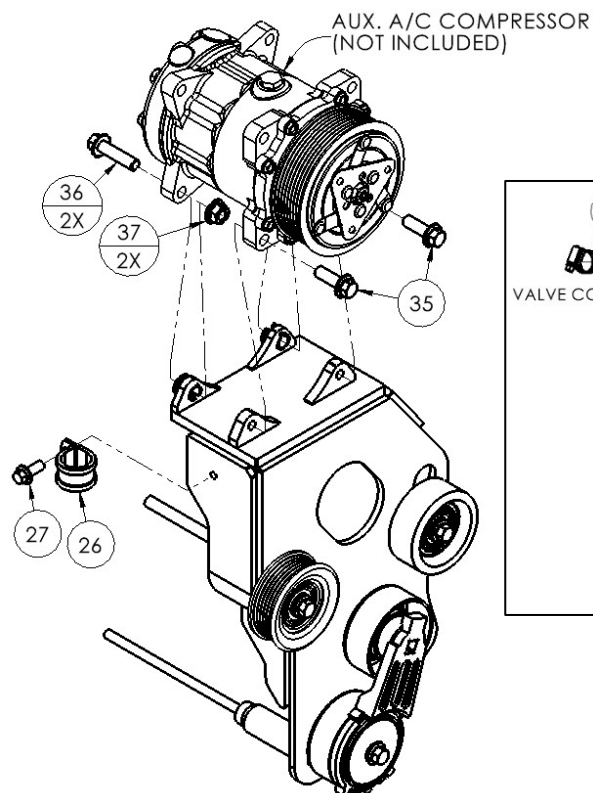

Air Duct Assembly (28-34)

PARTS LIST							
Item	Part Number	Description	Qty.	Item	Part Number	Description	Qty.
OEM A/C Compressor Hose Support Hardware				32	1016327	#64 Hose Clamp	1
26	1018287	#16 Adel Clamp (3/4" Wide)	1	33	1010299	5/8" Oil Hose	25"
27	1013329	M8-1.25 x 20mm 10.9Gr Hex Flg. Bolt	1	34	1018276	#8 Hose Clamps	2
Air Duct Assembly				Auxiliary A/C Compressor Mounting Hardware			
28	CMB1341	3-1/2" ID 90° Silicone Elbow	1	35	1006927	M10-1.5 x 30mm 10.9Gr Hex Flg. Bolt	2
29	C134AD	Fabricated Steel Tube	1	36	1006933	M10-1.5 x 40mm 10.9Gr Hex Flg. Bolt	2
30	TP1461	4" to 3-1/2" Reducing Coupler	1	37	1018204	M10-1.5 10.9Gr Hex Flg. Nut	2
31	1016326	#56 Hose Clamp	3				

CMK134SD508-6

2020-2026 Chevrolet Silverado 1500
 2020-2026 GMC Sierra 1500
 5.3L V8 Gas w/ A/C, w/o OEM Dual Alternators

Requires 6-Groove, 119mm Diameter Clutch
 For use w/ TM13, TM15 or TM16 Ear-Mount Compressor
 Approximately 118% Overdriven w/ 119mm Diameter Clutch

Belt Routings

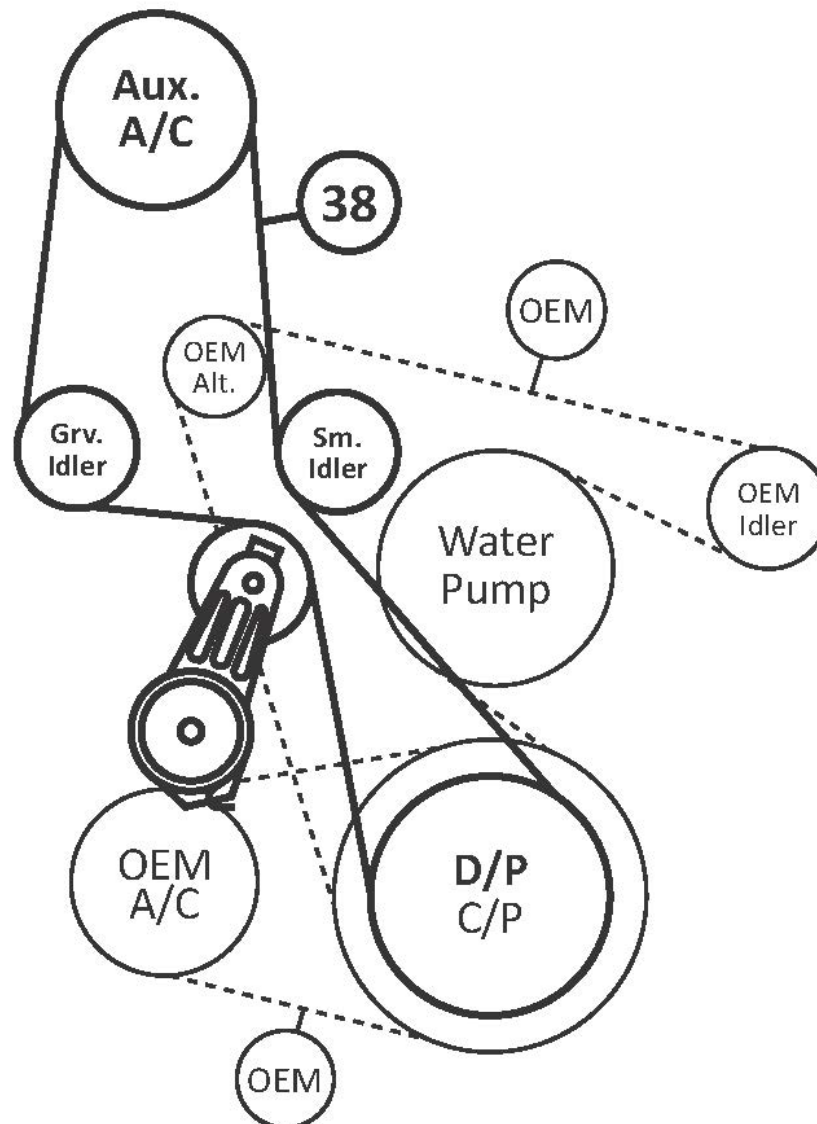

PARTS LIST			
Item	Part Number	Description	Qty.
Auxiliary Alternator Belt (Only One Belt Supplied)			
38	K060623	Gates 6-Groove, 62.3" Belt	1

CMK134SD508-6

2020-2026 Chevrolet Silverado 1500
2020-2026 GMC Sierra 1500
5.3L V8 Gas w/ A/C, w/o OEM Dual Alternators

Requires 6-Groove, 119mm Diameter Clutch
For use w/ TM13, TM15 or TM16 Ear-Mount Compressor
Approximately 118% Overdriven w/ 119mm Diameter Clutch

Mounting Locations

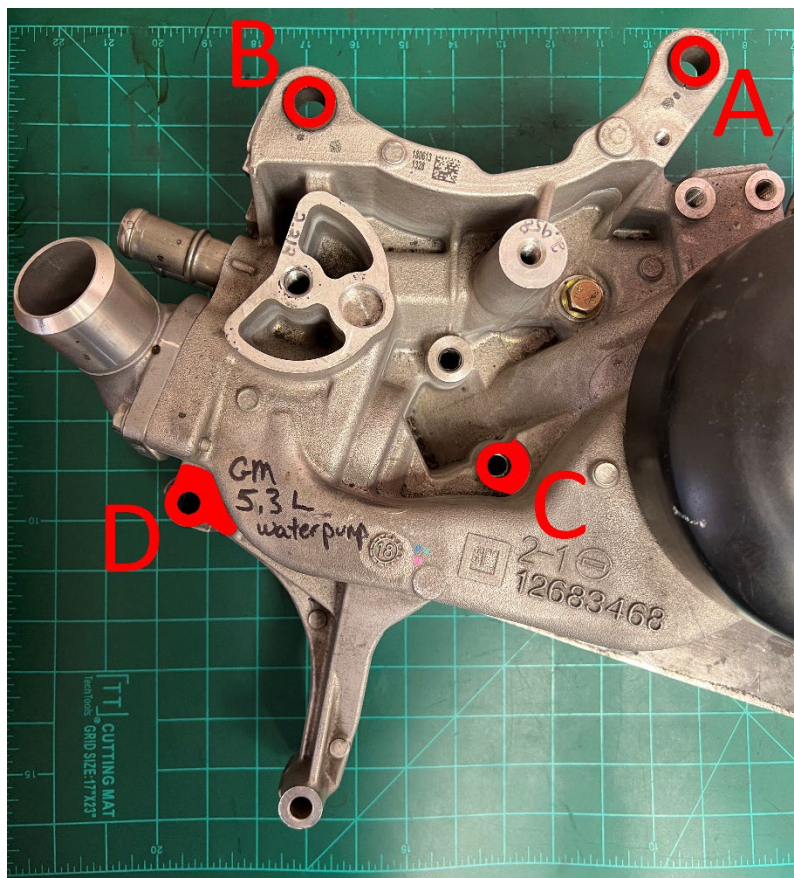

Mounting Location [A-D]: OEM Water Pump

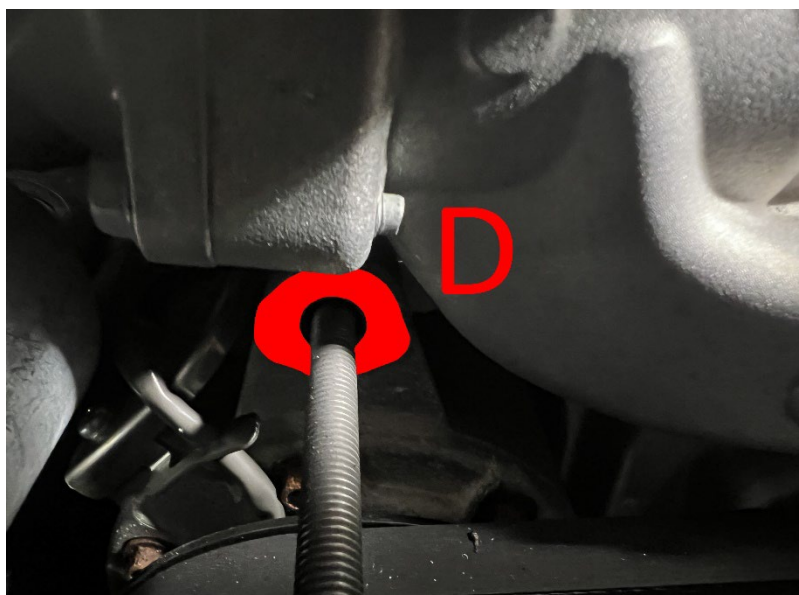

Mounting Location [D]: OEM A/C Compressor

CW **CW Mill Equipment Co., Inc.**
14 Commerce Drive Sabetha, KS 66534
Phone: (785) 284-3454
Fax: (785) 284-3601
Email: brackets@cwmill.com
MOUNTING KITS Website: www.cwkits.com

CMK134SD508-6

2020-2026 Chevrolet Silverado 1500
2020-2026 GMC Sierra 1500
5.3L V8 Gas w/ A/C, w/o OEM Dual Alternators

Requires 6-Groove, 119mm Diameter Clutch
For use w/ TM13, TM15 or TM16 Ear-Mount Compressor
Approximately 118% Overdriven w/ 119mm Diameter Clutch

Reference Image



Reference Image A: Installation Note 4a

CW **CW Mill Equipment Co., Inc.**
14 Commerce Drive Sabetha, KS 66534
Phone: (785) 284-3454
Fax: (785) 284-3601
Email: brackets@cwmill.com
MOUNTING KITS Website: www.cwkits.com

CMK134SD508-6

2020-2026 Chevrolet Silverado 1500
2020-2026 GMC Sierra 1500
5.3L V8 Gas w/ A/C, w/o OEM Dual Alternators

Requires 6-Groove, 119mm Diameter Clutch
For use w/ TM13, TM15 or TM16 Ear-Mount Compressor
Approximately 118% Overdriven w/ 119mm Diameter Clutch

Reference Image



Reference Image B: Installation Note 13