

INSTALLATION NOTES

1. The buyer is responsible for providing trained and experienced installation decision making with technical know-how to apply professional judgment that specifically applies to each individual installation.
2. Be sure to read and understand all available information including but not limited to instructions, warnings, sale terms, and warranties for the vehicle and all system components prior to attempting installation.
3. Disconnect the negative battery cables. Remove the plastic cover over the radiator. For easier access, drain coolant and remove the upper radiator hose.
4. Remove the driver's side fan shroud brace. Remove the OEM serpentine belt. The OEM fan shroud brace and serpentine belt will not be reused.
5. If the vehicle is equipped with OEM dual alternators, first, reprogram the ECM for a single alternator setup. Then, remove the secondary alternator and secondary alternator bracket. They will not be reused.
6. Install the auxiliary A/C compressor according to the manufacturer's specifications onto the main bracket (1) with mounting hardware (14-15). Install the main bracket (1) and auxiliary A/C compressor assembly onto the engine at mounting location [A] with mounting hardware (2-4). Install the main bracket support brace (5) onto the main bracket (1) and the engine at mounting location [B] with mounting hardware (6-7). Make sure to secure the wire harness away from any hot or moving parts.
7. Install the smooth idler pulley assembly (10-13) onto the main bracket (1).
8. Install belt (16) according to the belt diagram.
9. Install fan shroud support brace (8-9) according to the reference photo below.
10. Reinstall the upper radiator hose. Reinstall the plastic cover over the radiator and fan shroud support brace (8). Properly refill the coolant. Reconnect the battery cables.

CAUTION: Before starting the engine, check to make certain no wires, hoses, etc. that may have been disturbed during installation do not come in contact with any hot or moving parts. Properly refill any fluids that may have been drained, check for leaks. Run the engine and check for proper belt tracking and clearance of any hoses, wires, etc. It is the installer's responsibility to correct/adjust any components, if necessary, before the vehicle is put into service.

Parts List

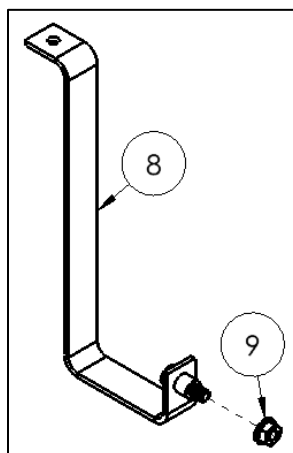
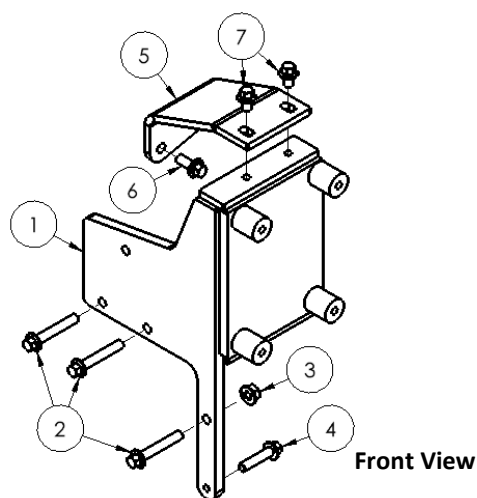

Fan Shroud Support Brace (Left)
 Smooth Idler Pulley Assembly (Below)
 Aux. A/C Compressor Mounting Hardware (Below)

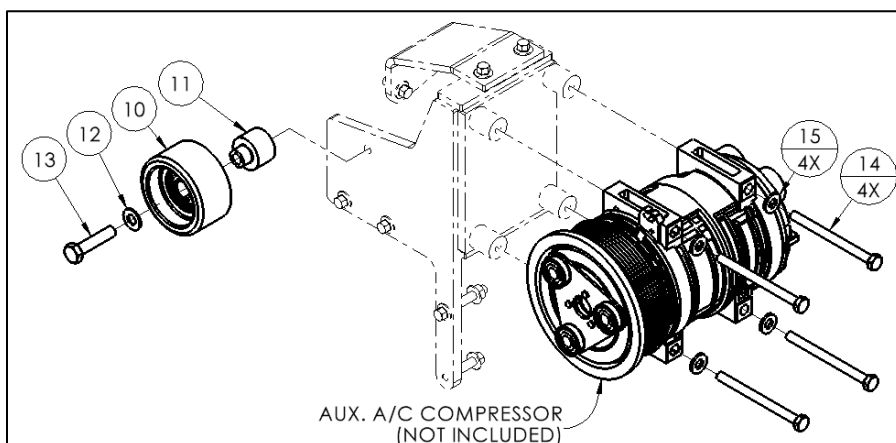
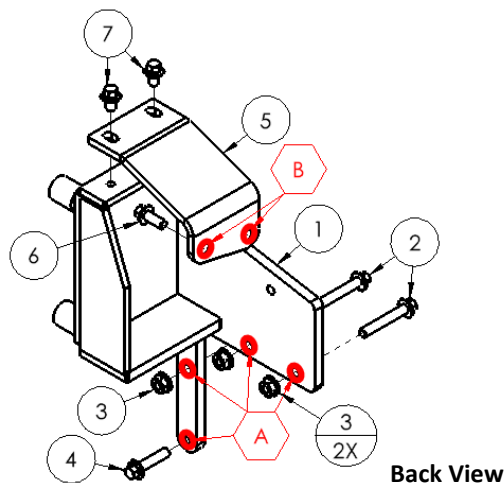

PARTS LIST

Item	Part Number	Description	Qty.	Item	Part Number	Description	Qty.
Main Bracket				Fan Shroud Support Brace			
1	RMP62TM21-I8	Main Bracket	1	8	RMB623	Fan Shroud Support Brace	1
Main Bracket Mounting Hardware				9	1013333	M8-1.25 10.9Gr Hex Flg. Nut	1
2	1013316	M8-1.25 x 50mm 10.9Gr Hex Flg. Bolt	3	Smooth Idler Pulley Assembly			
3	1013333	M8-1.25 10.9Gr Hex Flg. Nut	3	10	89016	Dayco Smooth Idler Pulley	1
4	1018224	M8-1.25 x 35mm 10.9Gr Hex Flg. Bolt	1	11	DMB594	Machined Idler Bushing	1
Main Bracket Support Brace				12	1002596	3/8" Flat Washer	1
5	RMB622	Main Bracket Support Brace	1	13	1006633	M10-1.5 x 45mm 10.9Gr Hex Bolt	1
Main Bracket Support Brace Mounting Hardware				Auxiliary A/C Compressor Mounting Hardware			
6	1013329	M8-1.25 x 20mm 10.9Gr Hex Flg. Bolt	2	14	1011957	M8-1.25 x 100mm 10.9Gr Hex Bolt	4
7	1011623	M8-1.25 x 12mm 10.9Gr Hex Flg. Bolt	2	15	1010202	M8 Flat Washer	4

Belt Routing

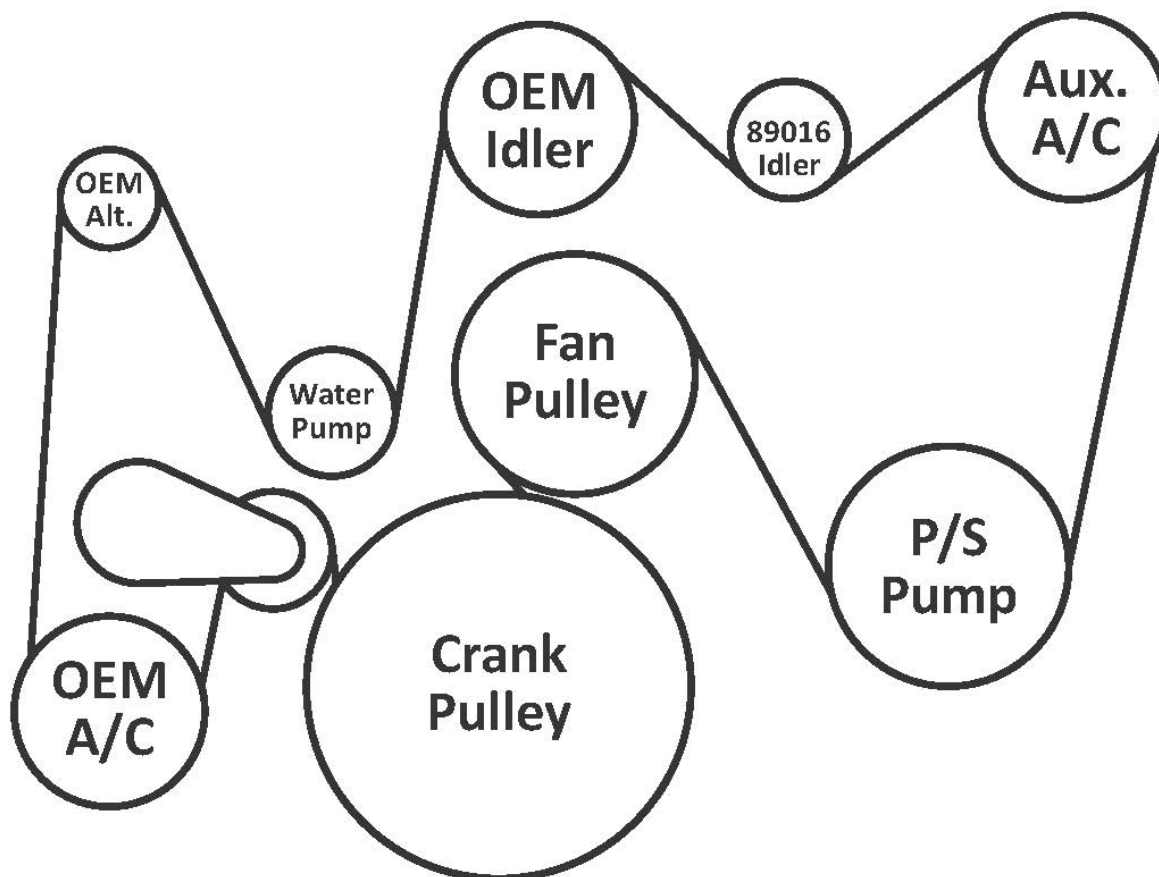

PARTS LIST			
Item	Part Number	Description	Qty.
Belt			
16	5081369	Dayco 8-Groove, 136.9" Belt	1

RMK62TM21-I8

2025-2026 RAM 2500-5500
6.7L I6 Cummins Diesel w/ A/C, w/o OEM Dual Alternators

For use w/ TM21 Direct-Mount Compressor
Must use 8-Groove, 127mm Diameter Clutch
Approximately 160% Overdriven w/ 127mm Diameter Clutch

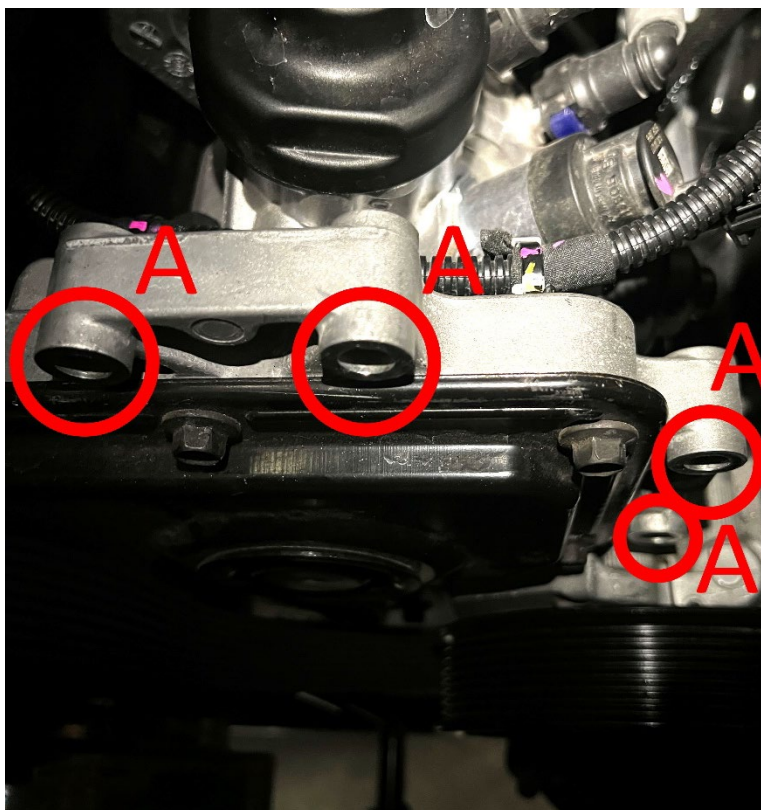

Main Bracket Mounting Location [A]

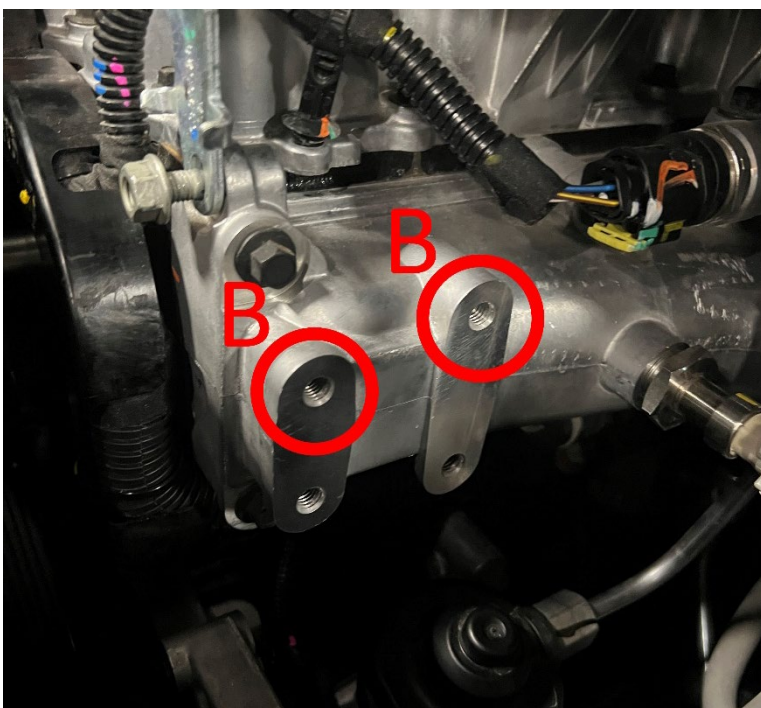

Main Bracket Support Brace Mounting Location [B]

CW **CW Mill Equipment Co., Inc.**
14 Commerce Drive Sabetha, KS 66534
Phone: (785) 284-3454
Fax: (785) 284-3601
Email: brackets@cwmill.com
MOUNTING KITS Website: www.cwkits.com

RMK62TM21-I8

2025-2026 RAM 2500-5500
6.7L I6 Cummins Diesel w/ A/C, w/o OEM Dual Alternators

For use w/ TM21 Direct-Mount Compressor
Must use 8-Groove, 127mm Diameter Clutch
Approximately 160% Overdriven w/ 127mm Diameter Clutch

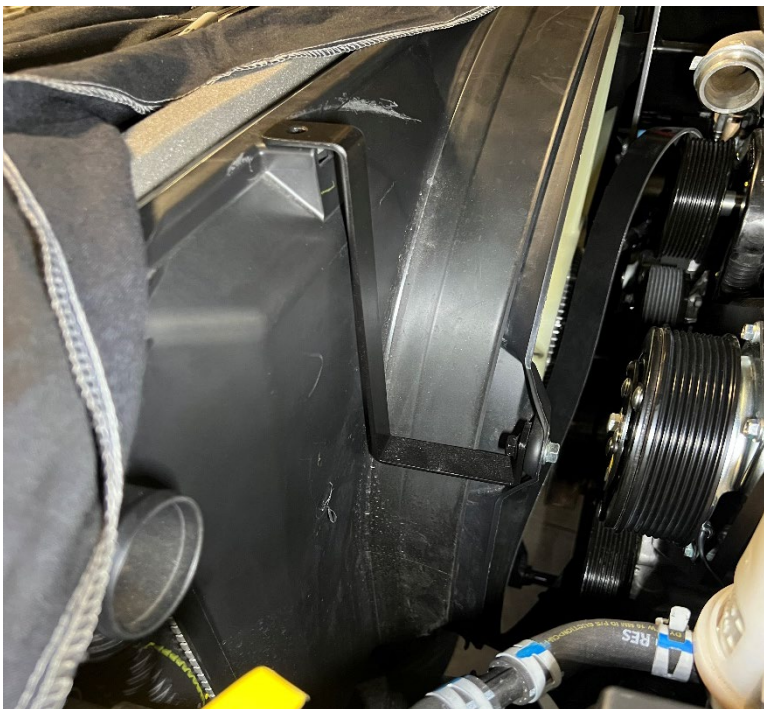

Fan Shroud Support Brace



2025-2026 RAM 2500-5500

For use w/ TM21 Direct-Mount Compressor

Approximately 160% Overdriven w/ 127mm Diameter Clutch

[illegible]

9/17/2025